

# Central and Camelback Water Quality Assurance Revolving Fund (WQARF) Registry Site Community Advisory Board (CAB) Presentation

September 28, 2022

Mikel Morales, Project Manager



# WQARF Process

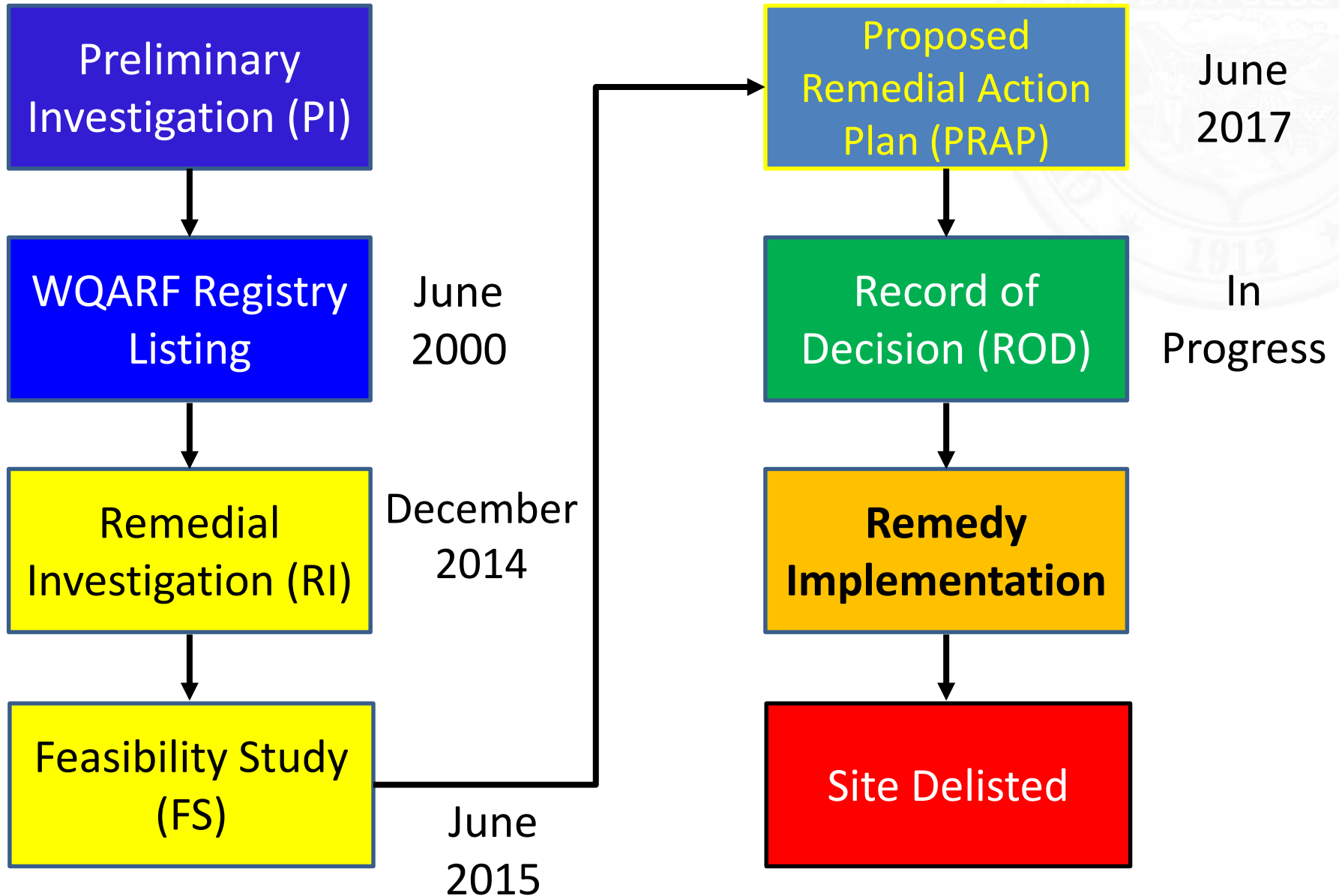

## Central and Camelback WQARF Site

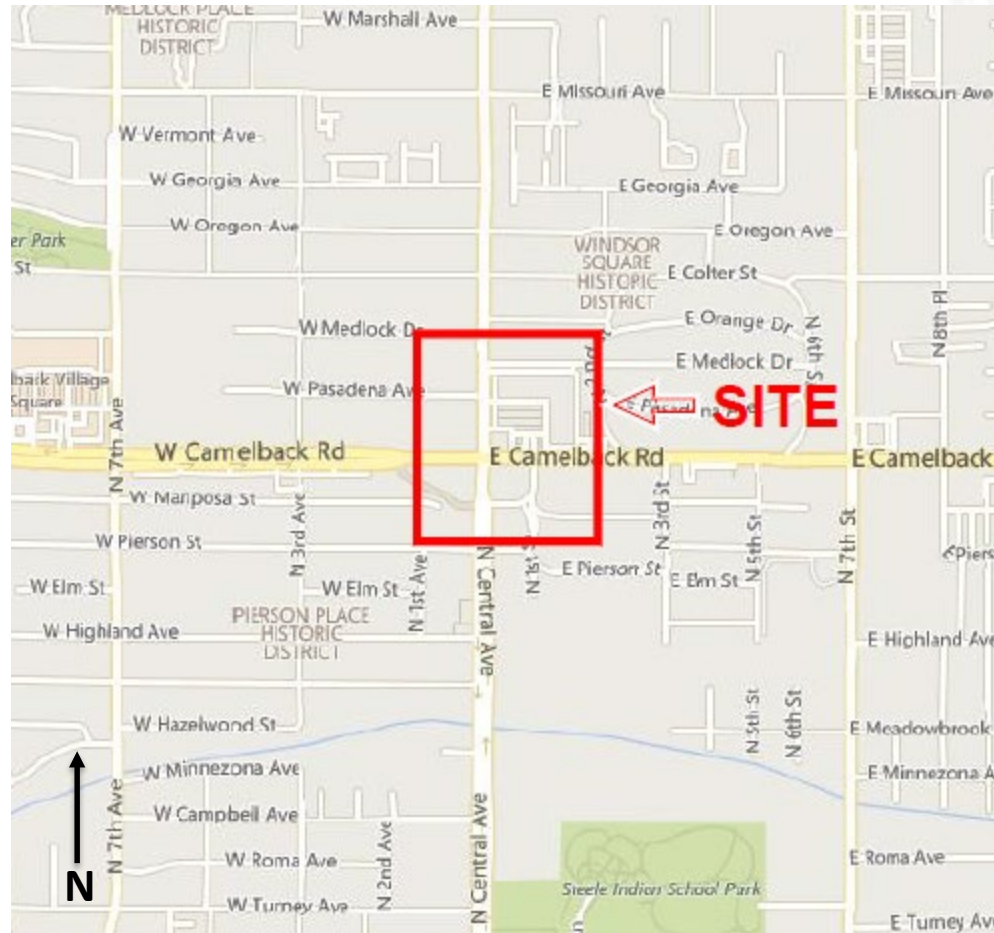

- Tetrachloroethene (PCE) Concentrations in Groundwater Exceed the Aquifer Water Quality Standard (AWQS)
- PCE Concentrations in Soil Exceed the Arizona Soil Remediation Level (SRL)
- Contaminants of Concern are PCE and Trichloroethene (TCE)

- Soil Vapor Extraction (SVE)
  - Pulse Operation
    - September 2021 to December 2021
    - March 2022 to May 2022
  - Soil Gas Sampling
    - December 2022 [Shutdown Monitoring]
    - March 2022 [Rebound Monitoring]
    - May 2022 [Shutdown Monitoring]

# Soil Gas Concentration Trends

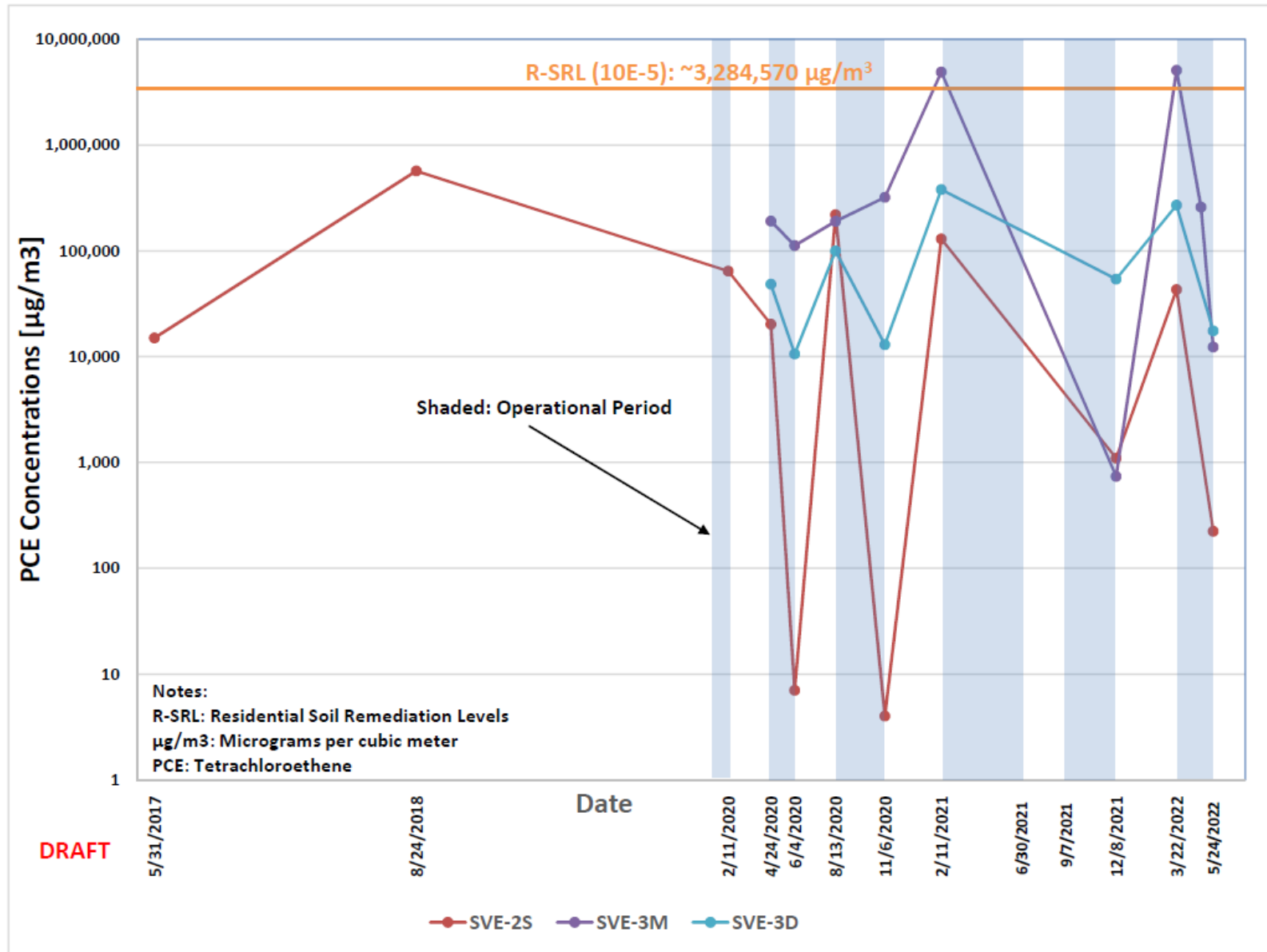



# March 2022 Rebound Monitoring

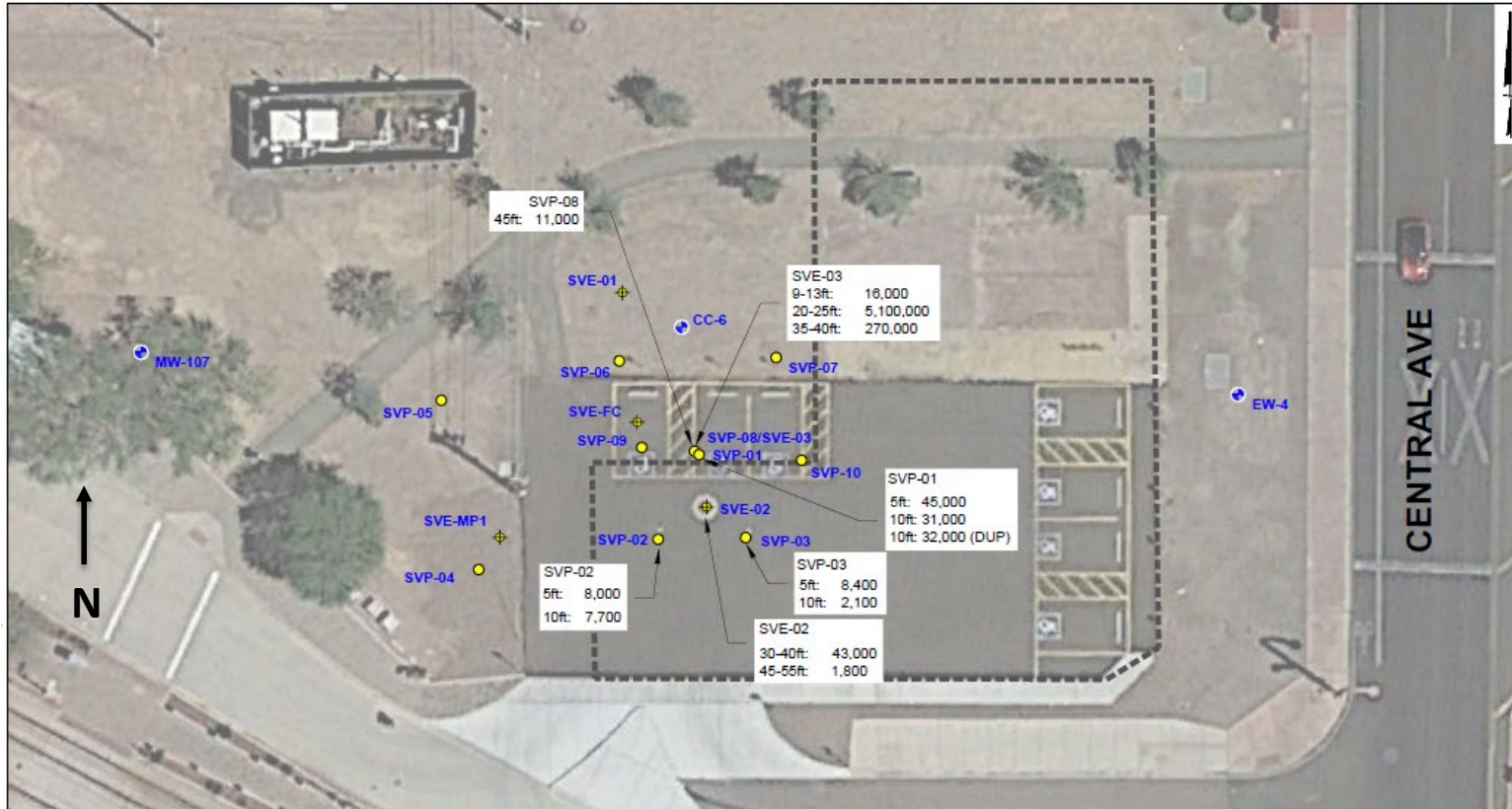

NOT TO SCALE

**LEGEND**

- Groundwater Well
- Soil Vapor Probe
- SVE Well
- Former Building Footprint
- EW** - Extraction Well
- MW** - Monitor Well
- SVE** - Soil Vapor Extraction
- SVP** - Soil Vapor Probe
- 5ft** - Depth Below Ground Surface in Feet
- 5,100** - Concentration in micrograms per cubic meter
- Dup** - Duplicate Sample
- All concentrations are tetrachloroethene (PCE)

**PCE SOIL VAPOR CONCENTRATIONS  
MARCH 2022**

Central and Camelback WQARF Site  
Phoenix, AZ

**Geosyntec**  
consultants

Figure

4

Phoenix, AZ

June 2022

## ■ Semiannual Groundwater Monitoring

COC Concentrations			
Constituent	Detection Range [µg/L]	AWQS [µg/L]	Wells Above AWQS
PCE	0.314 - 7.34	5	CC-4
TCE	0.204 – 3.63	5	None

\* Semiannual sampling performed in October 2021 and April 2022

µg/L – micrograms per liter

## ■ System Decommissioning

- Abandoned 9 monitoring wells and 2 groundwater extraction wells



## PCE Concentration Figure – April 2022

- PCE detected above the AWQS of 5  $\mu\text{g/L}$  in one monitoring well (CC-4).
- Concentrations and contours presented in units of  $\mu\text{g/L}$ .
- March 2019 dewatering well concentrations used for contouring.

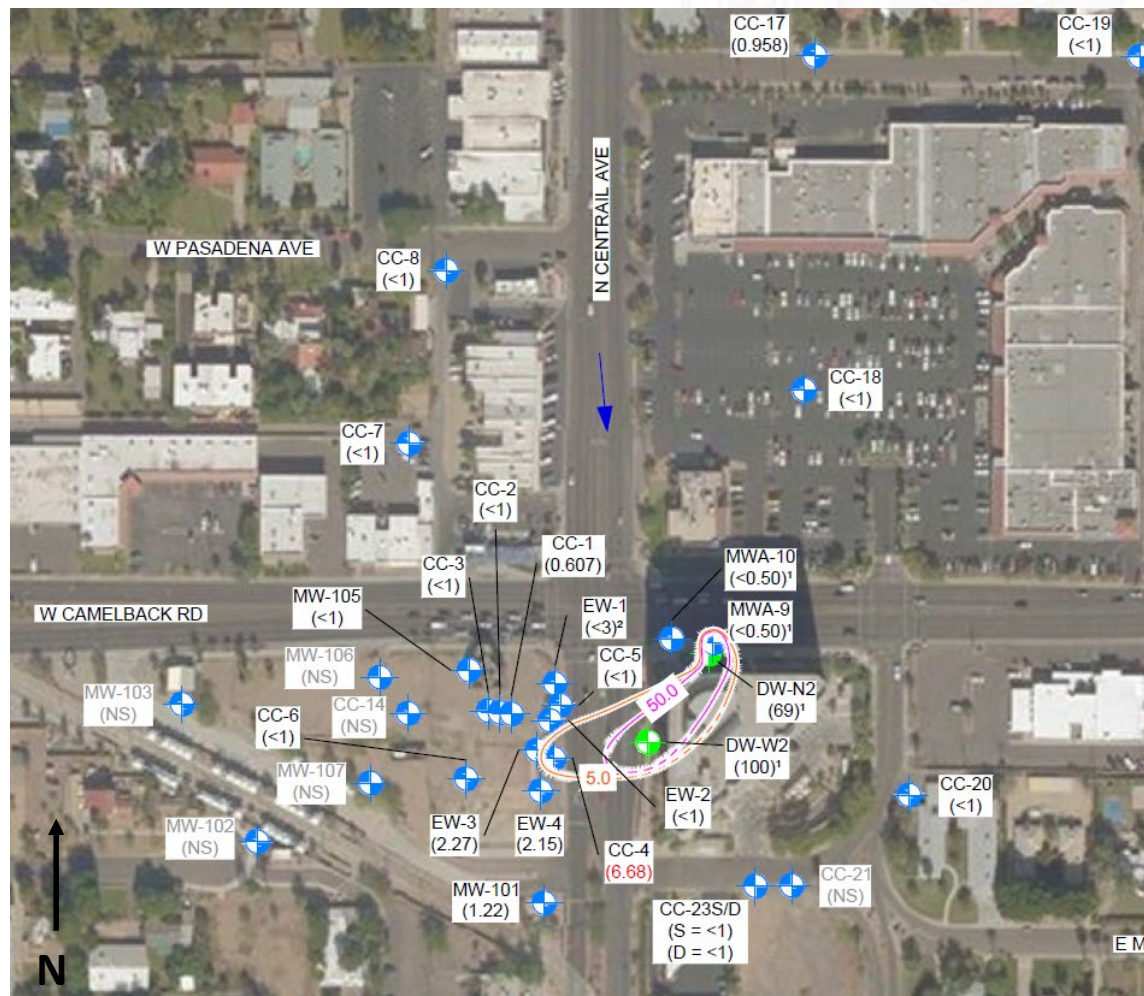

- **Soil Remediation**
  - Design and Implement SVE Optimization Pilot Study [ISCO Sparge]
  - Continued Pulse SVE Operation
- **Groundwater Remediation**
  - Routine Semiannual Groundwater Monitoring
  - Groundwater Extraction Treatment System Decommissioning (currently in progress)
- **Finalize Record of Decision**

**Questions?**



## Contacts

Mikel Morales, Project Manager  
Remedial Projects Unit  
[Morales.mikel@azdeq.gov](mailto:Morales.mikel@azdeq.gov)  
(602) 771-4182

Wendy Flood  
Remedial Projects Unit  
[Flood.wendy@azdeq.gov](mailto:Flood.wendy@azdeq.gov)  
(602) 771-4410

