

David A. Burchard
Arizona Department of Environmental Quality, PHX
1110 W. Washington Street
Phoenix, AZ 85007

Project: School Lead Testing Screening
Project Number: Garden Lakes

Reported:
06/23/17 14:55

Analyte

GL Admin (7061687-01) Drinking Water (Grab) Sampled: 06/07/17 05:00 Received: 06/15/17 16:00

Analyte	Result	PQL	Units	Dilution	Batch	Prepared	Analyzed	Method	Notes
Legend Technical Services of Arizona, Inc.									

Total Metals

Lead	<5.0	5.0	ug/L	1	B7F1532	06/19/17 10:08	06/20/17 16:40	EPA 200.8	
------	------	-----	------	---	---------	----------------	----------------	-----------	--

GLA (7061687-02) Drinking Water (Grab) Sampled: 06/07/17 05:05 Received: 06/15/17 16:00

Analyte	Result	PQL	Units	Dilution	Batch	Prepared	Analyzed	Method	Notes
Legend Technical Services of Arizona, Inc.									

Total Metals

Lead	<5.0	5.0	ug/L	1	B7F1532	06/19/17 10:08	06/20/17 16:42	EPA 200.8	
------	------	-----	------	---	---------	----------------	----------------	-----------	--

GLB (7061687-03) Drinking Water (Grab) Sampled: 06/07/17 05:10 Received: 06/15/17 16:00

Analyte	Result	PQL	Units	Dilution	Batch	Prepared	Analyzed	Method	Notes
Legend Technical Services of Arizona, Inc.									

Total Metals

Lead	<5.0	5.0	ug/L	1	B7F1532	06/19/17 10:08	06/20/17 16:45	EPA 200.8	
------	------	-----	------	---	---------	----------------	----------------	-----------	--

GLC (7061687-04) Drinking Water (Grab) Sampled: 06/07/17 05:15 Received: 06/15/17 16:00

Analyte	Result	PQL	Units	Dilution	Batch	Prepared	Analyzed	Method	Notes
Legend Technical Services of Arizona, Inc.									

Total Metals

Lead	<5.0	5.0	ug/L	1	B7F1532	06/19/17 10:08	06/20/17 16:48	EPA 200.8	
------	------	-----	------	---	---------	----------------	----------------	-----------	--

GLD (7061687-05) Drinking Water (Grab) Sampled: 06/07/17 05:20 Received: 06/15/17 16:00

Analyte	Result	PQL	Units	Dilution	Batch	Prepared	Analyzed	Method	Notes
Legend Technical Services of Arizona, Inc.									

Total Metals

Lead	<5.0	5.0	ug/L	1	B7F1532	06/19/17 10:08	06/20/17 16:51	EPA 200.8	
------	------	-----	------	---	---------	----------------	----------------	-----------	--

GLH (7061687-06) Drinking Water (Grab) Sampled: 06/07/17 05:25 Received: 06/15/17 16:00

Analyte	Result	PQL	Units	Dilution	Batch	Prepared	Analyzed	Method	Notes
Legend Technical Services of Arizona, Inc.									

Total Metals

Lead	<5.0	5.0	ug/L	1	B7F1532	06/19/17 10:08	06/20/17 16:53	EPA 200.8	
------	------	-----	------	---	---------	----------------	----------------	-----------	--

GLE (7061687-07) Drinking Water (Grab) Sampled: 06/07/17 05:30 Received: 06/15/17 16:00

Analyte	Result	PQL	Units	Dilution	Batch	Prepared	Analyzed	Method	Notes
---------	--------	-----	-------	----------	-------	----------	----------	--------	-------

Legend Technical Services of Arizona, Inc.

Anna Teter

Client Services Representative

The results in this report apply to the samples analyzed in accordance with the chain of custody document. This analytical report must be reproduced in its entirety.

Phone Number: (602) 324-6100

Page 1 of 17

David A. Burchard
Arizona Department of Environmental Quality, PHX
1110 W. Washington Street
Phoenix, AZ85007

Project: School Lead Testing Screening
Project Number: Garden Lakes

Reported:
06/23/17 14:55

GLE (7061687-07) Drinking Water (Grab) Sampled: 06/07/17 05:30 Received: 06/15/17 16:00

Analyte	Result	PQL	Units	Dilution	Batch	Prepared	Analyzed	Method	Notes
Legend Technical Services of Arizona, Inc.									

Total Metals

Lead	<5.0	5.0	ug/L	1	B7F1532	06/19/17 10:08	06/20/17 17:02	EPA 200.8
------	------	-----	------	---	---------	----------------	----------------	-----------

GLG (7061687-08) Drinking Water (Grab) Sampled: 06/07/17 05:35 Received: 06/15/17 16:00

Analyte	Result	PQL	Units	Dilution	Batch	Prepared	Analyzed	Method	Notes
Legend Technical Services of Arizona, Inc.									

Total Metals

Lead	<5.0	5.0	ug/L	1	B7F1532	06/19/17 10:08	06/20/17 17:04	EPA 200.8
------	------	-----	------	---	---------	----------------	----------------	-----------

GL Cafe (7061687-09) Drinking Water (Grab) Sampled: 06/07/17 05:40 Received: 06/15/17 16:00

Analyte	Result	PQL	Units	Dilution	Batch	Prepared	Analyzed	Method	Notes
Legend Technical Services of Arizona, Inc.									

Total Metals

Lead	<5.0	5.0	ug/L	1	B7F1532	06/19/17 10:08	06/20/17 17:07	EPA 200.8
------	------	-----	------	---	---------	----------------	----------------	-----------

6/7/17 (7061687-10) Drinking Water (Grab) Sampled: 06/07/17 05:45 Received: 06/15/17 16:00

Analyte	Result	PQL	Units	Dilution	Batch	Prepared	Analyzed	Method	Notes
Legend Technical Services of Arizona, Inc.									

Total Metals

Lead	<5.0	5.0	ug/L	1	B7F1532	06/19/17 10:08	06/20/17 17:10	EPA 200.8
------	------	-----	------	---	---------	----------------	----------------	-----------

GL Gym (7061687-11) Drinking Water (Grab) Sampled: 06/07/17 05:50 Received: 06/15/17 16:00

Analyte	Result	PQL	Units	Dilution	Batch	Prepared	Analyzed	Method	Notes
Legend Technical Services of Arizona, Inc.									

Total Metals

Lead	<5.0	5.0	ug/L	1	B7F1532	06/19/17 10:08	06/20/17 17:13	EPA 200.8
------	------	-----	------	---	---------	----------------	----------------	-----------

Sample Condition Upon Receipt:

Temperature: 20.00 °C

All samples were received in acceptable condition unless noted otherwise in the case narrative.

Case Narrative:

Holding Times: All holding times were met unless otherwise qualified.

QA/QC Criteria: All analyses met method requirements unless otherwise qualified.

Accreditations: AZ(PHX)0004, AZ(TUC)0004, AIHA#102982, CDC ELITE Member.

Accreditation is applicable only to the test methods specified on each scope of accreditation held by LEGEND.

Comments: There were no problems encountered during the processing of the samples, unless otherwise noted.
All samples were analyzed on a "wet" basis unless designated as "dry weight".

The results in this report apply to the samples analyzed in accordance with the chain of custody document. This analytical report must be reproduced in its entirety.

David A. Burchard
Arizona Department of Environmental Quality, PHX
1110 W. Washington Street
Phoenix, AZ85007

Project: School Lead Testing Screening
Project Number: Garden Lakes

Reported:
06/23/17 14:55

Notes and Definitions

ADEQ Public School Drinking Water Lead Screening Program
Sampling Plan & Collection Log

Collection Log
for experienced sample collectors

7061687-01

Complete copy of this form for each sample collected. Your drinking water sample cannot be tested unless a copy of this form is shipped to the lab with each sample. In addition, the sample cannot be tested unless the Sample Identification Number matches the number on the sample container label.

- ☐ Check this box to confirm that **water had not been used at this tap or other taps in the area for 6 hours** and **no** flushing was done prior to sampling

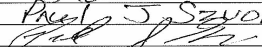
Name of School District	Pendlehurst School Dist #22
School Name	Garden Lakes
Building (name/number)	1001 A1000 Admin
Type of Fixture (tap, drinking fountain etc.)	Drinking Fountain
Location of Fixture (example, room number)	Inside
Sample Identification Number (Write this number on the sample container and on this sheet)	Gh Admin
Date of Collection	6-7-2017
Time of Collection	5:00 AM
Printed Name of Sample Collector	Paul J. Szvorn
Signature Sample Collector	

Notes Sample collector:

For Lab use only	
Analyze this drinking water sample for lead	
Date and Time Lab received	
Signature	
Notes: 6/15/17 1100 Received @ Lab pH✓ 20.0°C	

For relinquishing samples upon delivery to labs only

Relinquished date and signature _____

These samples were collected for lead screening purposes only and cannot be used for compliance.

ADEQ Public School Drinking Water Lead Screening Program
Sampling Plan & Collection Log

7061687-02

Collection Log
for experienced sample collectors

Complete copy of this form for each sample collected. Your drinking water sample cannot be tested unless a copy of this form is shipped to the lab with each sample. In addition, the sample cannot be tested unless the Sample Identification Number matches the number on the sample container label.

- ☐ Check this box to confirm that **water had not been used at this tap or other taps in the area for 6 hours** and **no** flushing was done prior to sampling

Name of School District	Pendengast School Dist #92
School Name	Garden Lakes Elementary
Building (name/number)	1002 A2000 A-Building
Type of Fixture (tap, drinking fountain etc.)	Drinking Fountain
Location of Fixture (example, room number)	Outside
Sample Identification Number (Write this number on the sample container and on this sheet)	GLA
Date of Collection	6-7-2017
Time of Collection	5:05
Printed Name of Sample Collector	Paul J. Squarzi
Signature Sample Collector	<i>Paul J. Squarzi</i>

Notes Sample collector:

For Lab use only	
Analyze this drinking water sample for lead	
Date and Time Lab received	
Signature	
Notes:	

For relinquishing samples upon delivery to labs only

Relinquished date and signature _____

These samples were collected for lead screening purposes only and cannot be used for compliance.

ADEQ Public School Drinking Water Lead Screening Program
Sampling Plan & Collection Log

Collection Log
for experienced sample collectors

7061487-03

Complete copy of this form for each sample collected. Your drinking water sample cannot be tested unless a copy of this form is shipped to the lab with each sample. In addition, the sample cannot be tested unless the Sample Identification Number matches the number on the sample container label.

- ☐ Check this box to confirm that **water had not been used at this tap or other taps in the area for 6 hours** and **no** flushing was done prior to sampling

Name of School District	Pendleburg School Dist #92
School Name	Garden Lakes Elementary
Building (name/number)	1003 A3000 B+ Building
Type of Fixture (tap, drinking fountain etc.)	Drinking Fountain
Location of Fixture (example, room number)	Outside
Sample Identification Number (Write this number on the sample container and on this sheet)	GLB
Date of Collection	6-7-2017
Time of Collection	5:10
Printed Name of Sample Collector	Paul J. Sullivan
Signature Sample Collector	<i>Paul J. Sullivan</i>

Notes Sample collector:

For Lab use only	
Analyze this drinking water sample for lead	
Date and Time Lab received	
Signature	
Notes:	

For relinquishing samples upon delivery to labs only

Relinquished date and signature _____

These samples were collected for lead screening purposes only and cannot be used for compliance.

ADEQ Public School Drinking Water Lead Screening Program
Sampling Plan & Collection Log

Collection Log
for experienced sample collectors

70611687-04

Complete copy of this form for each sample collected. Your drinking water sample cannot be tested unless a copy of this form is shipped to the lab with each sample. In addition, the sample cannot be tested unless the Sample Identification Number matches the number on the sample container label.

- ☐ Check this box to confirm that **water had not been used at this tap or other taps in the area for 6 hours** and **no** flushing was done prior to sampling

Name of School District	Pendengast School Dist #92
School Name	Garden Lakes Elementary
Building (name/number)	1004 A-4000 C-Building
Type of Fixture (tap, drinking fountain etc.)	Drinking Fountain Classroom
Location of Fixture (example, room number)	C-1
Sample Identification Number (Write this number on the sample container and on this sheet)	GLC
Date of Collection	6-7-2017
Time of Collection	5:15
Printed Name of Sample Collector	Patricia J. Szwarc
Signature Sample Collector	<i>Patricia J. Szwarc</i>

Notes Sample collector:

For Lab use only	
Analyze this drinking water sample for lead	
Date and Time Lab received	
Signature	
Notes:	

For relinquishing samples upon delivery to labs only

Relinquished date and signature _____

These samples were collected for lead screening purposes only and cannot be used for compliance.

ADEQ Public School Drinking Water Lead Screening Program
Sampling Plan & Collection Log

Collection Log
for experienced sample collectors

70611087-05

Complete copy of this form for each sample collected. Your drinking water sample cannot be tested unless a copy of this form is shipped to the lab with each sample. In addition, the sample cannot be tested unless the Sample Identification Number matches the number on the sample container label.

- ☐ Check this box to confirm that **water had not been used at this tap or other taps in the area for 6 hours** and **no** flushing was done prior to sampling

Name of School District	Pendauget School Dist #92
School Name	Garden Lakes Elementary
Building (name/number)	1005 AS000 D Building
Type of Fixture (tap, drinking fountain etc.)	Drinking Fountain
Location of Fixture (example, room number)	D-1 Classroom
Sample Identification Number (Write this number on the sample container and on this sheet)	GLD
Date of Collection	6-7-2017
Time of Collection	5:20
Printed Name of Sample Collector	Paul J Szvoren
Signature Sample Collector	<i>Paul J Szvoren</i>

Notes Sample collector:

For Lab use only	
Analyze this drinking water sample for lead	
Date and Time Lab received	
Signature	
Notes:	

For relinquishing samples upon delivery to labs only

Relinquished date and signature _____

These samples were collected for lead screening purposes only and cannot be used for compliance.

ADEQ Public School Drinking Water Lead Screening Program
Sampling Plan & Collection Log

Collection Log
for experienced sample collectors

7061487-06

Complete copy of this form for each sample collected. Your drinking water sample cannot be tested unless a copy of this form is shipped to the lab with each sample. In addition, the sample cannot be tested unless the Sample Identification Number matches the number on the sample container label.

- ☐ Check this box to confirm that **water had not been used at this tap or other taps in the area for 6 hours** and **no** flushing was done prior to sampling

Name of School District	Pendleton School Dist #92
School Name	Garden Lakes Elementary
Building (name/number)	1006 A6000 H-Building
Type of Fixture (tap, drinking fountain etc.)	Drinking Fountain
Location of Fixture (example, room number)	Outside
Sample Identification Number (Write this number on the sample container and on this sheet)	GLH
Date of Collection	6-7-2017
Time of Collection	5:25
Printed Name of Sample Collector	Paul J. Szvorn
Signature Sample Collector	<i>Paul J. Szvorn</i>

Notes Sample collector:

For Lab use only	
Analyze this drinking water sample for lead	
Date and Time Lab received	
Signature	
Notes:	

For relinquishing samples upon delivery to labs only

Relinquished date and signature _____

These samples were collected for lead screening purposes only and cannot be used for compliance.

ADEQ Public School Drinking Water Lead Screening Program
Sampling Plan & Collection Log

Collection Log
for experienced sample collectors

7061487-07

Complete copy of this form for each sample collected. Your drinking water sample cannot be tested unless a copy of this form is shipped to the lab with each sample. In addition, the sample cannot be tested unless the Sample Identification Number matches the number on the sample container label.

- ☐ Check this box to confirm that **water had not been used at this tap or other taps in the area for 6 hours** and **no** flushing was done prior to sampling

Name of School District	Pendleburg School Dist #82
School Name	Garden Lakes Elementary
Building (name/number)	1007 A7000 E-Building
Type of Fixture (tap, drinking fountain etc.)	Drinking Fountain
Location of Fixture (example, room number)	Outside
Sample Identification Number (Write this number on the sample container and on this sheet)	GLE
Date of Collection	6-7-2017
Time of Collection	5:30
Printed Name of Sample Collector	Paul J. Severson
Signature Sample Collector	<i>Paul J. Severson</i>

Notes Sample collector:

For Lab use only	
Analyze this drinking water sample for lead	
Date and Time Lab received	
Signature	
Notes:	

For relinquishing samples upon delivery to labs only

Relinquished date and signature _____

These samples were collected for lead screening purposes only and cannot be used for compliance.

ADEQ Public School Drinking Water Lead Screening Program
Sampling Plan & Collection Log

Collection Log
for experienced sample collectors

70611687-08

Complete copy of this form for each sample collected. Your drinking water sample cannot be tested unless a copy of this form is shipped to the lab with each sample. In addition, the sample cannot be tested unless the Sample Identification Number matches the number on the sample container label.

- ☐ Check this box to confirm that **water had not been used at this tap or other taps in the area for 6 hours** and **no** flushing was done prior to sampling

Name of School District	Pendegast School Dist #92
School Name	Garden Lakes Elementary
Building (name/number)	1608 AB000 G Building
Type of Fixture (tap, drinking fountain etc.)	Drinking Fountain
Location of Fixture (example, room number)	Outside
Sample Identification Number (Write this number on the sample container and on this sheet)	GLG
Date of Collection	6-7-2017
Time of Collection	5:35
Printed Name of Sample Collector	Paul J. Savora
Signature Sample Collector	<i>Paul J. Savora</i>

Notes Sample collector:

For Lab use only	
Analyze this drinking water sample for lead	
Date and Time Lab received	
Signature	
Notes:	

For relinquishing samples upon delivery to labs only

Relinquished date and signature _____

These samples were collected for lead screening purposes only and cannot be used for compliance.

ADEQ Public School Drinking Water Lead Screening Program
Sampling Plan & Collection Log

Collection Log
for experienced sample collectors

7061487-09

Complete copy of this form for each sample collected. Your drinking water sample cannot be tested unless a copy of this form is shipped to the lab with each sample. In addition, the sample cannot be tested unless the Sample Identification Number matches the number on the sample container label.

- ☐ Check this box to confirm that **water had not been used at this tap or other taps in the area for 6 hours** and **no** flushing was done prior to sampling

Name of School District	Pendleburg School Dist #22
School Name	Garden Lakes Elementary
Building (name/number)	1009 A9000 Cafeteria
Type of Fixture (tap, drinking fountain etc.)	Drinking Fountain
Location of Fixture (example, room number)	1st floor
Sample Identification Number (Write this number on the sample container and on this sheet)	GL Cafe
Date of Collection	6-7-2017
Time of Collection	5:40
Printed Name of Sample Collector	Paul J. Seymour
Signature Sample Collector	<i>Paul J. Seymour</i>

Notes Sample collector:

For Lab use only	
Analyze this drinking water sample for lead	
Date and Time Lab received	
Signature	
Notes:	

For relinquishing samples upon delivery to labs only

Relinquished date and signature _____

These samples were collected for lead screening purposes only and cannot be used for compliance.

ADEQ Public School Drinking Water Lead Screening Program
Sampling Plan & Collection Log

Collection Log
for experienced sample collectors

7061687-10

Complete copy of this form for each sample collected. Your drinking water sample cannot be tested unless a copy of this form is shipped to the lab with each sample. In addition, the sample cannot be tested unless the Sample Identification Number matches the number on the sample container label.

- ☐ Check this box to confirm that **water had not been used at this tap or other taps in the area for 6 hours** and **no** flushing was done prior to sampling

Name of School District	Pendouga School Dist #92
School Name	Garden Lakes Elementary
Building (name/number)	1010 A-10000 Portable II-4
Type of Fixture (tap, drinking fountain etc.)	Drinking Fountain
Location of Fixture (example, room number)	Inside
Sample Identification Number (Write this number on the sample container and on this sheet)	
Date of Collection	6-7-2017
Time of Collection	5:45
Printed Name of Sample Collector	Paul J. Szvoron
Signature Sample Collector	<i>Paul J. Szvoron</i>

Notes Sample collector:

For Lab use only	
Analyze this drinking water sample for lead	
Date and Time Lab received	
Signature	
Notes:	

For relinquishing samples upon delivery to labs only

Relinquished date and signature _____

These samples were collected for lead screening purposes only and cannot be used for compliance.

ADEQ Public School Drinking Water Lead Screening Program
Sampling Plan & Collection Log

Collection Log
for experienced sample collectors

7061687-11

Complete copy of this form for each sample collected. Your drinking water sample cannot be tested unless a copy of this form is shipped to the lab with each sample. In addition, the sample cannot be tested unless the Sample Identification Number matches the number on the sample container label.

- ☐ Check this box to confirm that **water had not been used at this tap or other taps in the area for 6 hours** and **no** flushing was done prior to sampling

Name of School District	Pendleburg Elementary School District
School Name	Garden Lakes Elementary
Building (name/number)	1012 GYM
Type of Fixture (tap, drinking fountain etc.)	Drinking Fountain
Location of Fixture (example, room number)	1st floor
Sample Identification Number (Write this number on the sample container and on this sheet)	GLGYM
Date of Collection	6-7-2017
Time of Collection	5:50
Printed Name of Sample Collector	Paul J. Szupera
Signature Sample Collector	<i>Paul J. Szupera</i>

Notes Sample collector:

For Lab use only	
Analyze this drinking water sample for lead	
Date and Time Lab received	
Signature	
Notes:	

For relinquishing samples upon delivery to labs only

Relinquished date and signature _____

These samples were collected for lead screening purposes only and cannot be used for compliance.

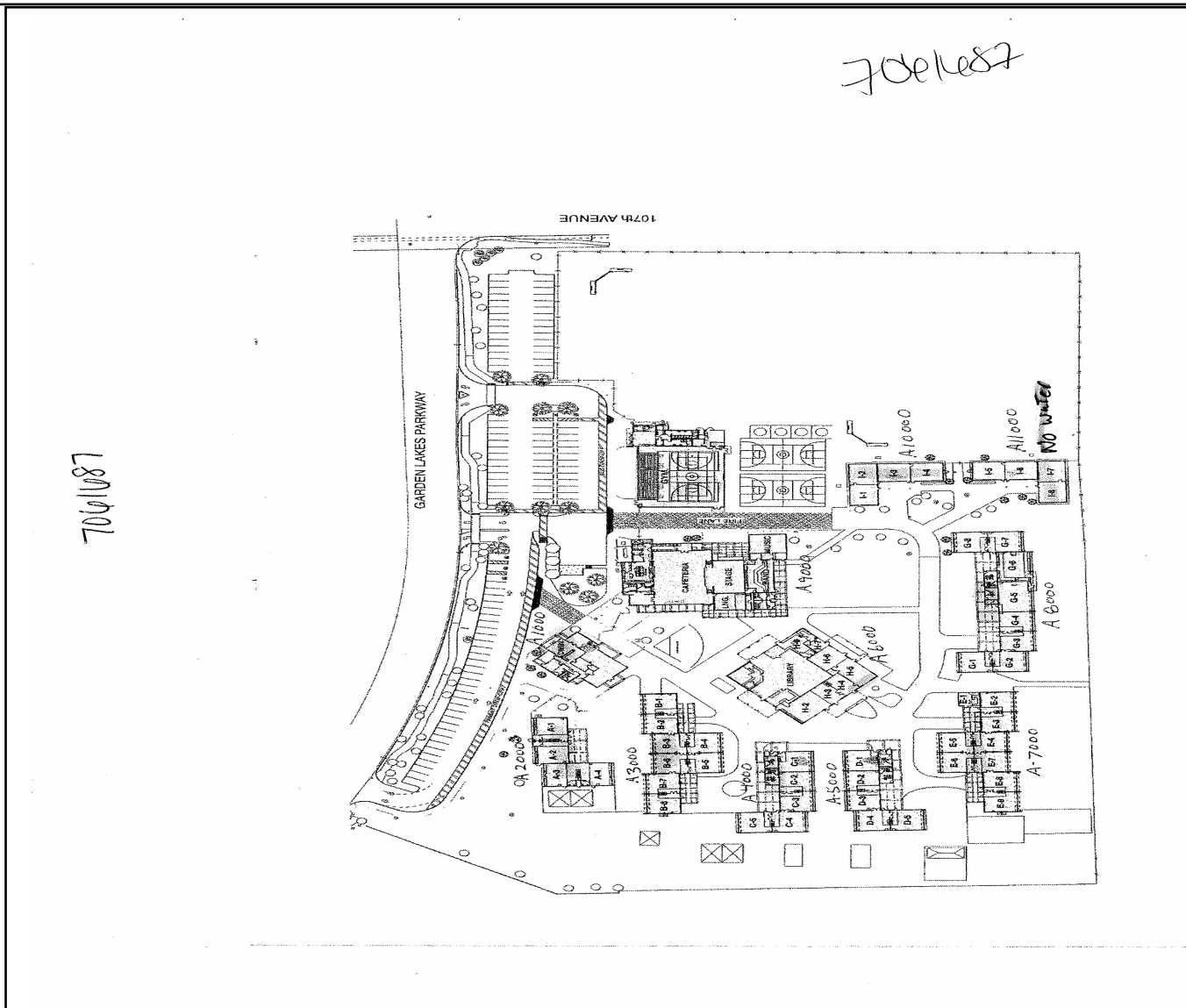

7061687

District	School	Building No	Building Desc	Building Use	Year Built	street	City	zip	County	Bottles per building
Pendergast Elementary District	Garden Lakes Elementary School	1001	A-1000	Administration	1990	10825 W Garden Lakes Pkwy	Avondale	85039-	Maricopa	1
Pendergast Elementary District	Garden Lakes Elementary School	1002	A-2000	Kindergarden	1991	10825 W Garden Lakes Pkwy	Avondale	85039-	Maricopa	1
Pendergast Elementary District	Garden Lakes Elementary School	1003	A-3000	Classroom	1990	10825 W Garden Lakes Pkwy	Avondale	85039-	Maricopa	1
Pendergast Elementary District	Garden Lakes Elementary School	1004	A-4000	Classroom	1990	10825 W Garden Lakes Pkwy	Avondale	85039-	Maricopa	1
Pendergast Elementary District	Garden Lakes Elementary School	1005	A-5000	Classroom	1990	10825 W Garden Lakes Pkwy	Avondale	85039-	Maricopa	1
Pendergast Elementary District	Garden Lakes Elementary School	1006	A-6000	Media	1992	10825 W Garden Lakes Pkwy	Avondale	85039-	Maricopa	1
Pendergast Elementary District	Garden Lakes Elementary School	1007	A-7000	Classroom	1991	10825 W Garden Lakes Pkwy	Avondale	85039-	Maricopa	1
Pendergast Elementary District	Garden Lakes Elementary School	1008	A-8000	Classroom	1992	10825 W Garden Lakes Pkwy	Avondale	85039-	Maricopa	1
Pendergast Elementary District	Garden Lakes Elementary School	1009	A-9000	Cafeteria	1993	10825 W Garden Lakes Pkwy	Avondale	85039-	Maricopa	1

7061687

7061687

7061687

Pendergast Elementary District	Garden Lakes Elementary School	1010	A-10000	Classroom	E.M.	1993	10825 W Garden Lakes Pkwy	Phoenix 85039- Maricopa	1			
Pendergast Elementary District	Garden Lakes Elementary School	1011	A-11000	Classroom	E.M.	1993	10825 W Garden Lakes Pkwy	Phoenix 85039- Maricopa	1			
Pendergast Elementary District	Garden Lakes Elementary School	1012	Gymnasium	Indoor sports	E.M.	2013	10825 W Garden Lakes Pkwy	Phoenix 85039- Maricopa	1			12 Garden Lakes