

Technical Report for**Arizona Dept. of Environmental Quality****School District, Lead in Drinking Water Testing****Cheatham Elementary/Laveen Elementary District****SGS Accutest Job Number: LA32014****Sampling Date: 03/29/17****Report to:****Arizona Dept. of Environmental Quality**
1110 West Washington Street
Phoenix, AZ 85007
db2@azdeq.gov; vs3@azdeq.gov;
machiche.ana@azdeq.gov; diaz.stephanie@azdeq.gov;
ATTN: David Burchard**Total number of pages in report: 28**

Test results contained within this data package meet the requirements
of the National Environmental Laboratory Accreditation Program
and/or state specific certification programs as applicable.

Ron Benjamin
Lab Director**Client Service contact: Anita Patel 337-237-4775**

Certifications: LDEQ(2048), LDHH(LA150012), AR(14-045-04), AZ(AZ0805), FL(E87657), IL(200082), KY(#31),
NC(487), SC(73004001), NJ(LA007), TX(T104704186-15-7), WV(257)

This report shall not be reproduced, except in its entirety, without the written approval of SGS Accutest.
Test results relate only to samples analyzed.

Table of Contents

-1-

Section 1: Sample Summary 3

Section 2: Summary of Hits 4

Section 3: Sample Results 5

3.1: LA32014-1: #1 6

3.2: LA32014-2: #2 7

3.3: LA32014-3: #3 8

3.4: LA32014-4: #4 9

3.5: LA32014-5: #5 10

3.6: LA32014-6: #6 11

Section 4: Misc. Forms 12

4.1: Chain of Custody 13

Section 5: Metals Analysis - QC Data Summaries 23

5.1: Prep QC MP7349: Pb 24



Sample Summary

Arizona Dept. of Environmental Quality

Job No: LA32014

School District, Lead in Drinking Water Testing
Project No: Cheatham Elementary/Laveen Elementary District

Sample Number	Collected Date	Time By	Received	Matrix Code	Type	Client Sample ID
LA32014-1	03/29/17	06:30 JG	04/01/17	DW	Drinking Water	#1
LA32014-2	03/29/17	06:33 JG	04/01/17	DW	Drinking Water	#2
LA32014-3	03/29/17	06:36 JG	04/01/17	DW	Drinking Water	#3
LA32014-4	03/29/17	06:40 JG	04/01/17	DW	Drinking Water	#4
LA32014-5	03/29/17	06:43 JG	04/01/17	DW	Drinking Water	#5
LA32014-6	03/29/17	06:46 JG	04/01/17	DW	Drinking Water	#6

Summary of Hits

Job Number: LA32014
Account: Arizona Dept. of Environmental Quality
Project: School District, Lead in Drinking Water Testing
Collected: 03/29/17

Lab Sample ID	Client Sample ID	Result/ Qual	RL	MDL	Units	Method
LA32014-1	#1	No hits reported in this sample.				
LA32014-2	#2	No hits reported in this sample.				
LA32014-3	#3	No hits reported in this sample.				
LA32014-4	#4	No hits reported in this sample.				
LA32014-5	#5	No hits reported in this sample.				
LA32014-6	#6					
Lead		1.5	1.0		ug/l	EPA 200.8

Sample Results

Report of Analysis

Report of Analysis

Client Sample ID:	#1	Date Sampled:	03/29/17
Lab Sample ID:	LA32014-1	Date Received:	04/01/17
Matrix:	DW - Drinking Water	Percent Solids:	n/a
Project:	School District, Lead in Drinking Water Testing		

Total Metals Analysis

Analyte	Result	MCL	RL	Units	DF	Prep	Analyzed By	Method	Prep Method
Lead	ND	15	1.0	ug/l	1	04/04/17	04/10/17 RT	EPA 200.8 ¹	EPA 200.8 ²

(1) Instrument QC Batch: MA7232
(2) Prep QC Batch: MP7349

RL = Reporting Limit
MCL = Maximum Contamination Level (40 CFR 141)

ND = Not detected

Report of Analysis

Client Sample ID:	#2		
Lab Sample ID:	LA32014-2	Date Sampled:	03/29/17
Matrix:	DW - Drinking Water	Date Received:	04/01/17
		Percent Solids:	n/a
Project:	School District, Lead in Drinking Water Testing		

Total Metals Analysis

Analyte	Result	MCL	RL	Units	DF	Prep	Analyzed By	Method	Prep Method
Lead	ND	15	1.0	ug/l	1	04/04/17	04/10/17 RT	EPA 200.8 ¹	EPA 200.8 ²

(1) Instrument QC Batch: MA7232
(2) Prep QC Batch: MP7349

RL = Reporting Limit
MCL = Maximum Contamination Level (40 CFR 141)

ND = Not detected

Report of Analysis

Client Sample ID:	#3	Date Sampled:	03/29/17
Lab Sample ID:	LA32014-3	Date Received:	04/01/17
Matrix:	DW - Drinking Water	Percent Solids:	n/a
Project:	School District, Lead in Drinking Water Testing		

Total Metals Analysis

Analyte	Result	MCL	RL	Units	DF	Prep	Analyzed By	Method	Prep Method
Lead	ND	15	1.0	ug/l	1	04/04/17	04/10/17 RT	EPA 200.8 ¹	EPA 200.8 ²

(1) Instrument QC Batch: MA7232
(2) Prep QC Batch: MP7349

RL = Reporting Limit
MCL = Maximum Contamination Level (40 CFR 141)

ND = Not detected

Report of Analysis

Client Sample ID:	#4	Date Sampled:	03/29/17
Lab Sample ID:	LA32014-4	Date Received:	04/01/17
Matrix:	DW - Drinking Water	Percent Solids:	n/a
Project:	School District, Lead in Drinking Water Testing		

Total Metals Analysis

Analyte	Result	MCL	RL	Units	DF	Prep	Analyzed By	Method	Prep Method
Lead	ND	15	1.0	ug/l	1	04/04/17	04/09/17 RT	EPA 200.8 ¹	EPA 200.8 ²

(1) Instrument QC Batch: MA7223
(2) Prep QC Batch: MP7349

RL = Reporting Limit
MCL = Maximum Contamination Level (40 CFR 141)

ND = Not detected

Report of Analysis

Client Sample ID:	#5	Date Sampled:	03/29/17
Lab Sample ID:	LA32014-5	Date Received:	04/01/17
Matrix:	DW - Drinking Water	Percent Solids:	n/a
Project:	School District, Lead in Drinking Water Testing		

Total Metals Analysis

Analyte	Result	MCL	RL	Units	DF	Prep	Analyzed By	Method	Prep Method
Lead	ND	15	1.0	ug/l	1	04/04/17	04/09/17 RT	EPA 200.8 ¹	EPA 200.8 ²

(1) Instrument QC Batch: MA7223
(2) Prep QC Batch: MP7349

RL = Reporting Limit
MCL = Maximum Contamination Level (40 CFR 141)

ND = Not detected

Report of Analysis

Client Sample ID:	#6	Date Sampled:	03/29/17
Lab Sample ID:	LA32014-6	Date Received:	04/01/17
Matrix:	DW - Drinking Water	Percent Solids:	n/a
Project:	School District, Lead in Drinking Water Testing		

Total Metals Analysis

Analyte	Result	MCL	RL	Units	DF	Prep	Analyzed By	Method	Prep Method
Lead	1.5	15	1.0	ug/l	1	04/04/17	04/09/17 RT	EPA 200.8 ¹	EPA 200.8 ²

(1) Instrument QC Batch: MA7223
(2) Prep QC Batch: MP7349

RL = Reporting Limit
MCL = Maximum Contamination Level (40 CFR 141)

ND = Not detected



Misc. Forms

Custody Documents and Other Forms

Includes the following where applicable:

- Chain of Custody

LA32014

Collection Log
for experienced sample collectors

Complete copy of this form for each sample collected. Your drinking water sample cannot be tested unless a copy of this form is shipped to the lab with each sample. In addition, the sample cannot be tested unless the Sample Identification Number matches the number on the sample container label.

☒ Check this box to confirm that water had not been used at this tap or other taps in the area for 6 hours and no flushing was done prior to sampling

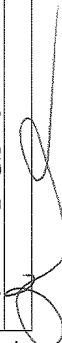
Name of School District	Laveen Elementary District
School Name	Cheatham Elementary
Building (name/number)	C
Type of Fixture (tap, drinking fountain etc.)	Kitchen Sink
Location of Fixture (example, room number)	By Door 189C
Sample Identification Number (Write this number on the sample container and on this sheet)	#1
Date of Collection	3-29-17
Time of Collection	6:30 AM
Printed Name of Sample Collector	Josie Gerson
Signature Sample Collector	

Notes Sample collector:

Robert Spots on was present @ time of Test

For Lab use only	
Analyze this drinking water sample for lead	
Date and Time Lab received	
Signature	
Notes:	

For relinquishing samples upon delivery to labs only

Relinquished date and signature

 3/31/17 1415

These samples were collected for lead screening purposes only and cannot be used for compliance.

3/31/17 1700 Red-X

04-11-17 0915 LA Chem R

04-11-17 0945 Nutsby

<http://www.azdeq.gov/LeadScreeningProg>

Page 2 of 2

(5 on each 34-1049) JWS

ADEQ Public School Drinking Water Lead Screening Program
Sampling Plan & Collection Log

Collection Log

for experienced sample collectors

Complete copy of this form for each sample collected. Your drinking water sample cannot be tested unless a copy of this form is shipped to the lab with each sample. In addition, the sample cannot be tested unless the Sample Identification Number matches the number on the sample container label.

☒ Check this box to confirm that **water had not been used at this tap or other taps in the area for 6 hours** and **no flushing** was done prior to sampling

Name of School District	Laveen Elementary District
School Name	Cheatham Elementary
Building (name/number)	E Gym Lobby
Type of Fixture (tap, drinking fountain etc.)	Drinking Fountain
Location of Fixture (example, room number)	By Door E 177
Sample Identification Number (Write this number on the sample container and on this sheet)	A 2
Date of Collection	3-29-17
Time of Collection	6:33
Printed Name of Sample Collector	Jessie Gutierrez
Signature Sample Collector	

Notes Sample collector:

Robert Jacobson was present @ time of Test

For Lab use only	
Analyze this drinking water sample for lead	
Date and Time Lab received	
Signature	
Notes:	

For relinquishing samples upon delivery to labs only

Relinquished date and signature

These samples were collected for lead screening purposes only and cannot be used for compliance.

LA32014

ADEQ Public School Drinking Water Lead Screening Program
Sampling Plan & Collection Log

Collection Log
for experienced sample collectors

Complete copy of this form for each sample collected. Your drinking water sample cannot be tested unless a copy of this form is shipped to the lab with each sample. In addition, the sample cannot be tested unless the Sample Identification Number matches the number on the sample container label.

☒ Check this box to confirm that water had not been used at this tap or other taps in the area for 6 hours and no flushing was done prior to sampling

Name of School District	Laveen Elementary District
School Name	Cheatham Elementary
Building (name/number)	G Postman Building
Type of Fixture (tap, drinking fountain etc.)	Drinking Fountain
Location of Fixture (example, room number)	By Gate R/R
Sample Identification Number (Write this number on the sample container and on this sheet)	#3
Date of Collection	3-25-17
Time of Collection	6:36 AM
Printed Name of Sample Collector	Jesse Guzman
Signature Sample Collector	

Notes Sample collector:

Robert Jacobsen was present @ time of Tap

For Lab use only	
Analyze this drinking water sample for lead	
Date and Time Lab received	
Signature	
Notes:	

For relinquishing samples upon delivery to labs only

Relinquished date and signature

These samples were collected for lead screening purposes only and cannot be used for compliance.

ADEQ Public School Drinking Water Lead Screening Program
Sampling Plan & Collection Log

Collection Log
for experienced sample collectors

Complete copy of this form for each sample collected. Your drinking water sample cannot be tested unless a copy of this form is shipped to the lab with each sample. In addition, the sample cannot be tested unless the Sample Identification Number matches the number on the sample container label.

☒ Check this box to confirm that water had not been used at this tap or other taps in the area for 6 hours and no flushing was done prior to sampling

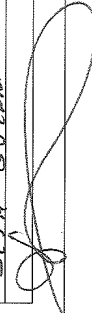
Name of School District	Laveen Elementary District
School Name	Cheatham Elementary
Building (name/number)	B
Type of Fixture (tap, drinking fountain etc.)	Drinking Fountain
Location of Fixture (example, room number)	By Door 150
Sample Identification Number (Write this number on the sample container and on this sheet)	#4
Date of Collection	3-29-17
Time of Collection	6:40
Printed Name of Sample Collector	Jesse Guzman
Signature Sample Collector	

Notes Sample collector:

Robert Jackson was present @ time of Test.

For Lab use only	
Analyze this drinking water sample for lead	
Date and Time Lab received	
Signature	
Notes:	

For relinquishing samples upon delivery to labs only

Relinquished date and signature

These samples were collected for lead screening purposes only and cannot be used for compliance.

Collection Log
for experienced sample collectors

Complete copy of this form for each sample collected. Your drinking water sample cannot be tested unless a copy of this form is shipped to the lab with each sample. In addition, the sample cannot be tested unless the Sample Identification Number matches the number on the sample container label.

☒ Check this box to confirm that **water had not been used at this tap or other taps in the area for 6 hours** and **no flushing** was done prior to sampling

Name of School District	Laveen Elementary District
School Name	Cheatham Elementary
Building (name/number)	A
Type of Fixture (tap, drinking fountain etc.)	Drinking Fountain
Location of Fixture (example, room number)	A108
Sample Identification Number (Write this number on the sample container and on this sheet)	H 5
Date of Collection	3-29-17
Time of Collection	6:43
Printed Name of Sample Collector	Jesse Guzman
Signature Sample Collector	

Notes Sample collector:

Robert Jacobson was present @ time of test

For Lab use only	
Analyze this drinking water sample for lead	
Date and Time Lab received	
Signature	
Notes:	

For relinquishing samples upon delivery to labs only

Relinquished date and signature

These samples were collected for lead screening purposes only and cannot be used for compliance.

LA 32014

ADEQ Public School Drinking Water Lead Screening Program
Sampling Plan & Collection Log

Collection Log
for experienced sample collectors

Complete copy of this form for each sample collected. Your drinking water sample cannot be tested unless a copy of this form is shipped to the lab with each sample. In addition, the sample cannot be tested unless the Sample Identification Number matches the number on the sample container label.

☒ Check this box to confirm that **water had not been used at this tap or other taps in the area for 6 hours** and **no** flushing was done prior to sampling

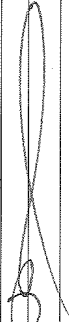
Name of School District	Laveen Elementary District
School Name	Cheatham Elementary
Building (name/number)	D
Type of Fixture (tap, drinking fountain etc.)	Drinking Fountain
Location of Fixture (example, room number)	By Door 224
Sample Identification Number (Write this number on the sample container and on this sheet)	#6
Date of Collection	3-29-17
Time of Collection	6:46
Printed Name of Sample Collector	Jesse Guzman
Signature Sample Collector	

Notes Sample collector:

Robert Johnson was present @ time of Test.

For Lab use only	
Analyze this drinking water sample for lead	
Date and Time Lab received	
Signature	
Notes:	

For relinquishing samples upon delivery to labs only

Relinquished date and signature

These samples were collected for lead screening purposes only and cannot be used for compliance.

<http://www.azdeq.gov/LeadScreeningProg>

District	School	Building No	Building Desc	Building Use	Year Built	Number of Bottles Per Building
Laveen Elementary District	Cheatham Elementary	1001	Building A	Admin	2003	1
Laveen Elementary District	Cheatham Elementary	1002	Building B	Classrooms	2003	1
Laveen Elementary District	Cheatham Elementary	1003	Building C	Gym, Cafe, Library, Computer lab, Music	2003	1
Laveen Elementary District	Cheatham Elementary	1004	Building D	Classrooms	2003	1
Laveen Elementary District	Cheatham Elementary	1005	Building E	Classrooms	2006	1
Laveen Elementary District	Cheatham Elementary	1006	Building F	Classrooms	2006	1
Laveen Elementary District	Cheatham Elementary	1007	Restroom Building	Student/Staff restrooms, PE equipment storage	2008	1
Laveen Elementary District	Cheatham Elementary	1008	Gym	Gym, Art, Science, Band, Music	2015	1
4725 W South Mountain Ave Laveen AZ 85339						8
Address:						Number of Bottles Per

LA32014: Chain of Custody

Page 7 of 10

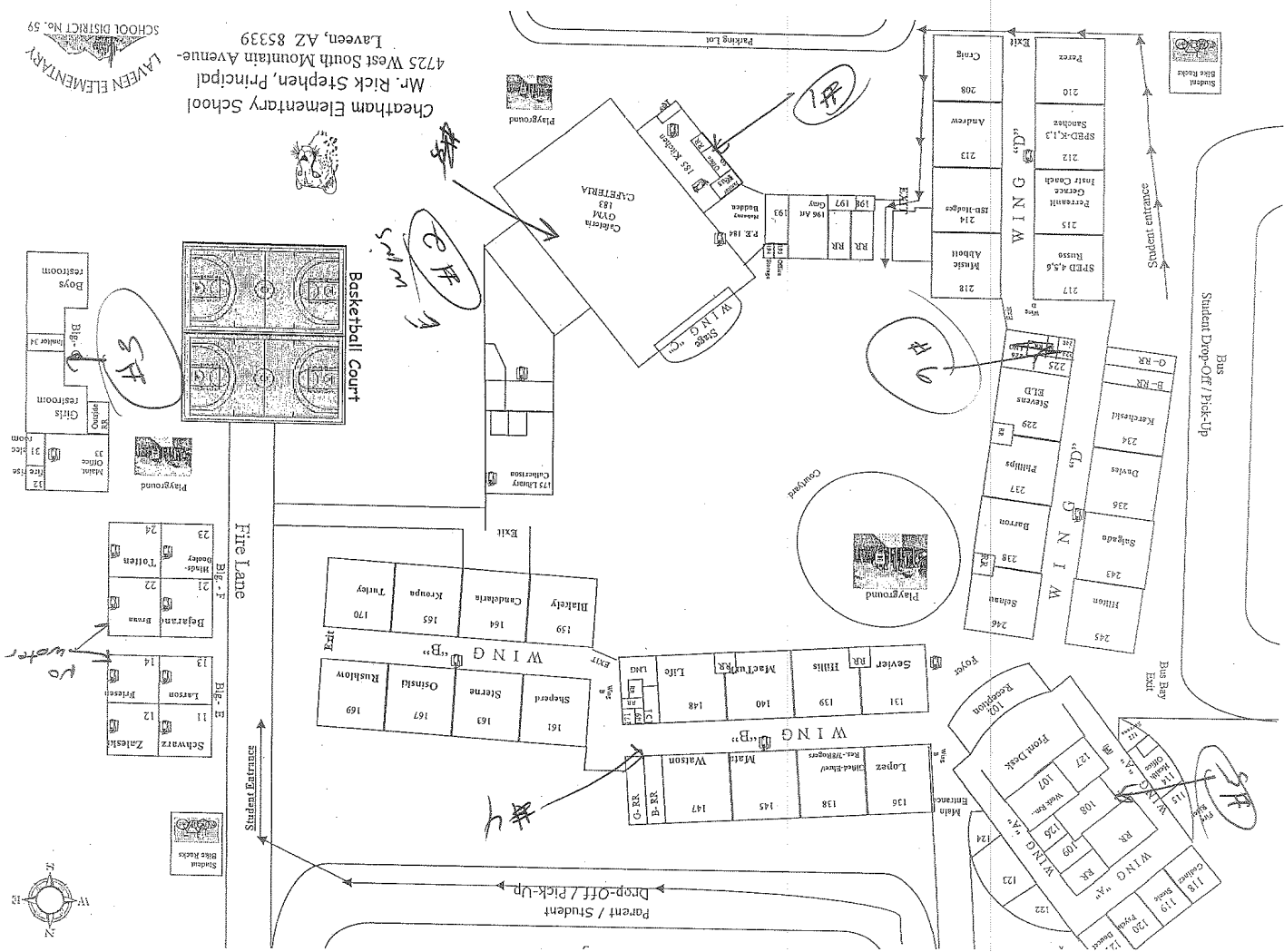

LA32014: Chain of Custody

Page 8 of 10

UNITED STATES
ACCUTEST
1741 W. UNIVERSITY DR.
SUITE 400
TAMPA, FL 33613
UNITED STATES US

CHG. 1000

BILL RECIPIENT

TO HOLD AT FEDEX- SAMPLES
ACCUTEST LABORATORIES-LAFAYETTE, LA
109 COMMISSION BLVD

LAFAYETTE LA 70508
(337) 237-4775 REF: ADEQ

DEPT.

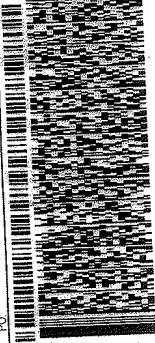

TRK# 7787 9932 6411
[0201]
SATURDAY HOLD
PRIORITY OVERNIGHT
HLD
LFTA
LFT
LAJUS

X0 LFTA



LAJUS 05/04/14

Desired (no) (Bura)

SGS Accutest Sample Receipt Summary

Job Number: LA32014

Client: ADEQ

Project: CHEATHAM ELEMENTARY

Date / Time Received: 4/1/2017 9:45:00 AM

Delivery Method: FedEx

Airbill #s: 778799326411

Cooler Temps (Initial/Adjusted): #1: (24.1/24.1):

Cooler Security

	<u>Y</u>	<u>or</u>	<u>N</u>		<u>Y</u>	<u>or</u>	<u>N</u>
1. Custody Seals Present:	<input checked="" type="checkbox"/>		<input type="checkbox"/>	3. COC Present:	<input checked="" type="checkbox"/>		<input type="checkbox"/>
2. Custody Seals Intact:	<input checked="" type="checkbox"/>		<input type="checkbox"/>	4. Smpl Dates/Time OK	<input checked="" type="checkbox"/>		<input type="checkbox"/>

Cooler Temperature

	<u>Y</u>	<u>or</u>	<u>N</u>
1. Temp criteria achieved:	<input type="checkbox"/>		<input type="checkbox"/>
2. Thermometer ID:	_____ ; _____		
3. Cooler media:	<u>No Ice</u>		
4. No. Coolers:	<u>1</u>		

Quality Control Preservation

	<u>Y</u>	<u>or</u>	<u>N</u>	<u>N/A</u>
1. Trip Blank present / cooler:	<input type="checkbox"/>		<input type="checkbox"/>	<input checked="" type="checkbox"/>
2. Trip Blank listed on COC:	<input type="checkbox"/>		<input type="checkbox"/>	<input checked="" type="checkbox"/>
3. Samples preserved properly:	<input checked="" type="checkbox"/>		<input type="checkbox"/>	
4. VOCs headspace free:	<input type="checkbox"/>		<input type="checkbox"/>	<input checked="" type="checkbox"/>

Sample Integrity - Documentation

	<u>Y</u>	<u>or</u>	<u>N</u>
1. Sample labels present on bottles:	<input checked="" type="checkbox"/>		<input type="checkbox"/>
2. Container labeling complete:	<input checked="" type="checkbox"/>		<input type="checkbox"/>
3. Sample container label / COC agree:	<input checked="" type="checkbox"/>		<input type="checkbox"/>

Sample Integrity - Condition

	<u>Y</u>	<u>or</u>	<u>N</u>
1. Sample recvd within HT:	<input checked="" type="checkbox"/>		<input type="checkbox"/>
2. All containers accounted for:	<input checked="" type="checkbox"/>		<input type="checkbox"/>
3. Condition of sample:	<u>Intact</u>		

Sample Integrity - Instructions

	<u>Y</u>	<u>or</u>	<u>N</u>	<u>N/A</u>
1. Analysis requested is clear:	<input checked="" type="checkbox"/>		<input type="checkbox"/>	
2. Bottles received for unspecified tests	<input type="checkbox"/>		<input checked="" type="checkbox"/>	
3. Sufficient volume recvd for analysis:	<input checked="" type="checkbox"/>		<input type="checkbox"/>	
4. Compositing instructions clear:	<input type="checkbox"/>		<input type="checkbox"/>	<input checked="" type="checkbox"/>
5. Filtering instructions clear:	<input type="checkbox"/>		<input type="checkbox"/>	<input checked="" type="checkbox"/>

Comments

LA32014: Chain of Custody

Page 10 of 10

Metals Analysis

5

QC Data Summaries

Includes the following where applicable:

- **Method Blank Summaries**
- **Matrix Spike and Duplicate Summaries**
- **Blank Spike and Lab Control Sample Summaries**
- **Serial Dilution Summaries**

BLANK RESULTS SUMMARY
Part 2 - Method Blanks

Login Number: LA32014
Account: ADEQAZP - Arizona Dept. of Environmental Quality
Project: School District, Lead in Drinking Water Testing

QC Batch ID: MP7349
Matrix Type: DRINKING WATER

Methods: EPA 200.8
Units: mg/l

Prep Date: 04/04/17

Metal	RL	IDL	MDL	MB raw	final
Aluminum	0.040	.048	.026		
Antimony	0.010	.0016	.0016		
Barium	0.010	.00015	.00064		
Beryllium	0.0010	.00003	.00013		
Boron	0.040	.0023	.005		
Calcium	0.40	.027	.057		
Lithium	0.0040	.0001	.00021		
Lead	0.0010	.000045	.00026	-0.00022	<0.0010
Molybdenum	0.0040	.0003	.00087		
Potassium	0.20	.034	.018		
Uranium	0.0020		.00016		

Associated samples MP7349: LA32014-1, LA32014-2, LA32014-3, LA32014-4, LA32014-5, LA32014-6

Results < IDL are shown as zero for calculation purposes
(*) Outside of QC limits
(anr) Analyte not requested

MATRIX SPIKE AND DUPLICATE RESULTS SUMMARY

Login Number: LA32014
 Account: ADEQAZP - Arizona Dept. of Environmental Quality
 Project: School District, Lead in Drinking Water Testing

QC Batch ID: MP7349
 Matrix Type: DRINKING WATER

Methods: EPA 200.8
 Units: mg/l

Prep Date: 04/04/17

Metal	LA32013-5 Original MS		Spikelot MPICPMS5 % Rec		QC Limits
Aluminum					
Antimony					
Barium					
Beryllium					
Boron					
Calcium					
Lithium					
Lead	0.00081	0.21	0.20	104.6	70-130
Molybdenum					
Potassium					
Uranium					

Associated samples MP7349: LA32014-1, LA32014-2, LA32014-3, LA32014-4, LA32014-5, LA32014-6

Results < IDL are shown as zero for calculation purposes

(*) Outside of QC limits

(N) Matrix Spike Rec. outside of QC limits

(anr) Analyte not requested

MATRIX SPIKE AND DUPLICATE RESULTS SUMMARY

Login Number: LA32014
 Account: ADEQAZP - Arizona Dept. of Environmental Quality
 Project: School District, Lead in Drinking Water Testing

QC Batch ID: MP7349
 Matrix Type: DRINKING WATER

Methods: EPA 200.8
 Units: mg/l

Prep Date: 04/04/17

Metal	LA32013-5 Original MSD	Spikelot MPICPMS5 % Rec	MSD RPD	QC Limit
Aluminum				
Antimony				
Barium				
Beryllium				
Boron				
Calcium				
Lithium				
Lead	0.00081 0.21	0.20 104.6	0.0	20
Molybdenum				
Potassium				
Uranium				

Associated samples MP7349: LA32014-1, LA32014-2, LA32014-3, LA32014-4, LA32014-5, LA32014-6

Results < IDL are shown as zero for calculation purposes

(*) Outside of QC limits

(N) Matrix Spike Rec. outside of QC limits

(anr) Analyte not requested

SPIKE BLANK AND LAB CONTROL SAMPLE SUMMARY

Login Number: LA32014
 Account: ADEQAZP - Arizona Dept. of Environmental Quality
 Project: School District, Lead in Drinking Water Testing

QC Batch ID: MP7349
 Matrix Type: DRINKING WATER

Methods: EPA 200.8
 Units: mg/l

Prep Date: 04/04/17

Metal	BSP Result	Spikelot MPICPMS5	% Rec	QC Limits
Aluminum				
Antimony				
Barium				
Beryllium				
Boron				
Calcium				
Lithium				
Lead	0.21	0.20	105.0	85-115
Molybdenum				
Potassium				
Uranium				

Associated samples MP7349: LA32014-1, LA32014-2, LA32014-3, LA32014-4, LA32014-5, LA32014-6

Results < IDL are shown as zero for calculation purposes
 (*) Outside of QC limits
 (anr) Analyte not requested

SERIAL DILUTION RESULTS SUMMARY

Login Number: LA32014
 Account: ADEQAZP - Arizona Dept. of Environmental Quality
 Project: School District, Lead in Drinking Water Testing

QC Batch ID: MP7349
 Matrix Type: DRINKING WATER

Methods: EPA 200.8
 Units: ug/l

Prep Date: 04/04/17

Metal	LA32013-5 Original	SDL 1:5	%DIF	QC Limits
Aluminum				
Antimony				
Barium				
Beryllium				
Boron				
Calcium				
Lithium				
Lead	0.407	1.02	150.0(a)	0-10
Molybdenum				
Potassium				
Uranium				

Associated samples MP7349: LA32014-1, LA32014-2, LA32014-3, LA32014-4, LA32014-5, LA32014-6

Results < IDL are shown as zero for calculation purposes

(*) Outside of QC limits

(anr) Analyte not requested

(a) Percent difference acceptable due to low initial sample concentration (< 50 times IDL).