

### Technical Report for

**Arizona Dept. of Environmental Quality**

**School District, Lead in Drinking Water Testing**

**Maurice C Cash School/Laveen Elementary District**

**SGS Accutest Job Number: LA32009**

**Sampling Date: 03/28/17**

#### Report to:

**Arizona Dept. of Environmental Quality**  
1110 West Washington Street  
Phoenix, AZ 85007  
db2@azdeq.gov; vs3@azdeq.gov;  
machiche.ana@azdeq.gov; diaz.stephanie@azdeq.gov;  
ATTN: David Burchard

**Total number of pages in report: 24**



Test results contained within this data package meet the requirements  
of the National Environmental Laboratory Accreditation Program  
and/or state specific certification programs as applicable.

*Ron Benjamin*  
**Ron Benjamin**  
**Lab Director**

**Client Service contact: Anita Patel 337-237-4775**

Certifications: LDEQ(2048), LDHH(LA150012), AR(14-045-04), AZ(AZ0805), FL(E87657), IL(200082), KY(#31),  
NC(487), SC(73004001), NJ(LA007), TX(T104704186-15-7), WV(257)

This report shall not be reproduced, except in its entirety, without the written approval of SGS Accutest.  
Test results relate only to samples analyzed.

# Table of Contents

-1-

**Section 1: Sample Summary ..... 3**

**Section 2: Summary of Hits ..... 4**

**Section 3: Sample Results ..... 5**

**3.1:** LA32009-1: #1 ..... 6

**3.2:** LA32009-2: #2 ..... 7

**3.3:** LA32009-3: #3 ..... 8

**3.4:** LA32009-4: #4 ..... 9

**Section 4: Misc. Forms ..... 10**

**4.1:** Chain of Custody ..... 11

**Section 5: Metals Analysis - QC Data Summaries ..... 19**

**5.1:** Prep QC MP7347: Pb ..... 20



Sample Summary

Arizona Dept. of Environmental Quality

Job No: LA32009

School District, Lead in Drinking Water Testing  
Project No: Maurice C Cash School/Laveen Elementary District

Sample Number	Collected Date	Time By	Received	Matrix Code	Type	Client Sample ID
LA32009-1	03/28/17	06:17 JG	04/01/17	DW	Drinking Water	#1
LA32009-2	03/28/17	06:22 JG	04/01/17	DW	Drinking Water	#2
LA32009-3	03/28/17	06:26 JG	04/01/17	DW	Drinking Water	#3
LA32009-4	03/28/17	06:30 JG	04/01/17	DW	Drinking Water	#4

Summary of Hits

Job Number: LA32009  
Account: Arizona Dept. of Environmental Quality  
Project: School District, Lead in Drinking Water Testing  
Collected: 03/28/17

Lab Sample ID	Client Sample ID	Result/ Analyte	RL	MDL	Units	Method
---------------	------------------	--------------------	----	-----	-------	--------

LA32009-1 #1

No hits reported in this sample.

LA32009-2 #2

No hits reported in this sample.

LA32009-3 #3

No hits reported in this sample.

LA32009-4 #4

No hits reported in this sample.



### **Sample Results**

### **Report of Analysis**

---

Report of Analysis

Client Sample ID:	#1	Date Sampled:	03/28/17
Lab Sample ID:	LA32009-1	Date Received:	04/01/17
Matrix:	DW - Drinking Water	Percent Solids:	n/a
Project:	School District, Lead in Drinking Water Testing		

Total Metals Analysis

Analyte	Result	MCL	RL	Units	DF	Prep	Analyzed By	Method	Prep Method
Lead	ND	15	1.0	ug/l	1	04/04/17	04/09/17 RT	EPA 200.8 <sup>1</sup>	EPA 200.8 <sup>2</sup>

(1) Instrument QC Batch: MA7223  
(2) Prep QC Batch: MP7347

RL = Reporting Limit  
MCL = Maximum Contamination Level (40 CFR 141)

ND = Not detected

Report of Analysis

Client Sample ID:	#2	Date Sampled:	03/28/17
Lab Sample ID:	LA32009-2	Date Received:	04/01/17
Matrix:	DW - Drinking Water	Percent Solids:	n/a
Project:	School District, Lead in Drinking Water Testing		

Total Metals Analysis

Analyte	Result	MCL	RL	Units	DF	Prep	Analyzed By	Method	Prep Method
Lead	ND	15	1.0	ug/l	1	04/04/17	04/09/17 RT	EPA 200.8 <sup>1</sup>	EPA 200.8 <sup>2</sup>

(1) Instrument QC Batch: MA7223  
(2) Prep QC Batch: MP7347

RL = Reporting Limit  
MCL = Maximum Contamination Level (40 CFR 141)

ND = Not detected

Report of Analysis

Client Sample ID:	#3	Date Sampled:	03/28/17
Lab Sample ID:	LA32009-3	Date Received:	04/01/17
Matrix:	DW - Drinking Water	Percent Solids:	n/a
Project:	School District, Lead in Drinking Water Testing		

Total Metals Analysis

Analyte	Result	MCL	RL	Units	DF	Prep	Analyzed By	Method	Prep Method
Lead	ND	15	1.0	ug/l	1	04/04/17	04/09/17 RT	EPA 200.8 <sup>1</sup>	EPA 200.8 <sup>2</sup>

(1) Instrument QC Batch: MA7223  
(2) Prep QC Batch: MP7347

RL = Reporting Limit  
MCL = Maximum Contamination Level (40 CFR 141)

ND = Not detected



Report of Analysis

Client Sample ID:	#4	Date Sampled:	03/28/17
Lab Sample ID:	LA32009-4	Date Received:	04/01/17
Matrix:	DW - Drinking Water	Percent Solids:	n/a
Project:	School District, Lead in Drinking Water Testing		

Total Metals Analysis

Analyte	Result	MCL	RL	Units	DF	Prep	Analyzed By	Method	Prep Method
Lead	ND	15	1.0	ug/l	1	04/04/17	04/09/17 RT	EPA 200.8 <sup>1</sup>	EPA 200.8 <sup>2</sup>

(1) Instrument QC Batch: MA7223  
(2) Prep QC Batch: MP7347

RL = Reporting Limit  
MCL = Maximum Contamination Level (40 CFR 141)

ND = Not detected

## **Misc. Forms**

---

### **Custody Documents and Other Forms**

---

**Includes the following where applicable:**

- Chain of Custody

LA32009

# Collection Log

for experienced sample collectors

Complete copy of this form for each sample collected. Your drinking water sample cannot be tested unless a copy of this form is shipped to the lab with each sample. In addition, the sample cannot be tested unless the Sample Identification Number matches the number on the sample container label.

☒ Check this box to confirm that **water had not been used at this tap or other taps in the area for 6 hours** and **no** flushing was done prior to sampling

Name of School District	Laveen Elementary District
School Name	Maurice C Cash School
Building (name/number)	C
Type of Fixture (tap, drinking fountain etc.)	Water Fountain
Location of Fixture (example, room number)	Cafe
Sample Identification Number ( <b>Write this number on the sample container and on this sheet</b> )	#1
Date of Collection	3-28-17
Time of Collection	6:17 AM
Printed Name of Sample Collector	Jesse Gaudin
Signature Sample Collector	

Notes Sample collector:

Robert Jackson was present @ time of test

For Lab use only	
Analyze this drinking water sample for lead	
Date and Time Lab received	
Signature	
Notes:	

For relinquishing samples upon delivery to labs only

Relinquished date and signature

 3/31/17 3/31/17 1415

These samples were collected for lead screening purposes only and cannot be used for compliance. FedEx

 3/31/17 1700

FedEx 04-01-17 0915  LA 2017  
Jackson (D) 04-01-17 0915  LA 2017

<http://www.azdeq.gov/LeadScreeningProg>

030116 (54.100410) (3wd)

Page 2 of 2

LA32009: Chain of Custody

Page 1 of 8

LA32009

ADEQ Public School Drinking Water Lead Screening Program  
Sampling Plan & Collection Log

**Collection Log**  
for experienced sample collectors

Complete copy of this form for each sample collected. Your drinking water sample cannot be tested unless a copy of this form is shipped to the lab with each sample. In addition, the sample cannot be tested unless the Sample Identification Number matches the number on the sample container label.

- ☒ Check this box to confirm that **water had not been used at this tap or other taps in the area for 6 hours** and **no flushing** was done prior to sampling

Name of School District	Laveen Elementary District
School Name	Maurice C Cash School
Building (name/number)	D
Type of Fixture (tap, drinking fountain etc.)	Drinking Fountain
Location of Fixture (example, room number)	By D142
Sample Identification Number (Write this number on the sample container and on this sheet)	#2
Date of Collection	3-28-17
Time of Collection	6:22 AM
Printed Name of Sample Collector	Steve Garner
Signature Sample Collector	

Notes Sample collector:

Robert Jackson was present at time of Test

For Lab use only	
Analyze this drinking water sample for lead	
Date and Time Lab received	
Signature	
Notes:	

For relinquishing samples upon delivery to labs only

Relinquished date and signature

These samples were collected for lead screening purposes only and cannot be used for compliance.

<http://www.azdeq.gov/LeadScreeningProg>

LA32009

ADEQ Public School Drinking Water Lead Screening Program  
Sampling Plan & Collection Log

Collection Log

for experienced sample collectors

Complete copy of this form for each sample collected. Your drinking water sample cannot be tested unless a copy of this form is shipped to the lab with each sample. In addition, the sample cannot be tested unless the Sample Identification Number matches the number on the sample container label.

☒ Check this box to confirm that water had not been used at this tap or other taps in the area for 6 hours and no flushing was done prior to sampling

Name of School District	Laveen Elementary District
School Name	Maurice C Cash School
Building (name/number)	B
Type of Fixture (tap, drinking fountain etc.)	Drinking Fountain
Location of Fixture (example, room number)	Classroom B106
Sample Identification Number (Write this number on the sample container and on this sheet)	43
Date of Collection	3-28-17
Time of Collection	6:26 AM
Printed Name of Sample Collector	Robert Jacobson
Signature Sample Collector	

Notes Sample collector:

Robert Jacobson was present @ testing time

For Lab use only	
Analyze this drinking water sample for lead	
Date and Time Lab received	
Signature	
Notes:	

For relinquishing samples upon delivery to labs only

Relinquished date and signature

These samples were collected for lead screening purposes only and cannot be used for compliance.

LA32009

ADEQ Public School Drinking Water Lead Screening Program  
Sampling Plan & Collection Log

Collection Log

for experienced sample collectors

Complete copy of this form for each sample collected. Your drinking water sample cannot be tested unless a copy of this form is shipped to the lab with each sample. In addition, the sample cannot be tested unless the Sample Identification Number matches the number on the sample container label.

☒ Check this box to confirm that water had not been used at this tap or other taps in the area for 6 hours and no flushing was done prior to sampling

Name of School District	Laveen Elementary District
School Name	Maurice C Cash School
Building (name/number)	A
Type of Fixture (tap, drinking fountain etc.)	Sink
Location of Fixture (example, room number)	Day Teacher's staff Room
Sample Identification Number (Write this number on the sample container and on this sheet)	#4
Date of Collection	3-28-17
Time of Collection	6:30am
Printed Name of Sample Collector	Robert Jackson
Signature Sample Collector	

Notes Sample collector:

Robert Jackson was present @ time of test.

For Lab use only	
Analyze this drinking water sample for lead	
Date and Time Lab received	
Signature	
Notes:	

For relinquishing samples upon delivery to labs only

Relinquished date and signature

These samples were collected for lead screening purposes only and cannot be used for compliance.

District	School	Building No	Building Desc	Building Use	Year Built	Number of Bottles Per Building
Laveen Elementary District	Maurice C Cash Elementary School	1012	Building A	Administration, Library	2014	1
Laveen Elementary District	Maurice C Cash Elementary School	1013	Building B	Preschool, Kindergarten	2014	1
Laveen Elementary District	Maurice C Cash Elementary School	1014	Building C	Gymnasium, Cafeteria	2014	1
Laveen Elementary District	Maurice C Cash Elementary School	1015	Building D	Classrooms	2014	1
Address:	3851 W Roeser Rd PHX 85041				Number of Bottles Per	4

LA32009: Chain of Custody  
Page 5 of 8

M.C. Cash Elementary School  
Laven Elementary School District #59  
3851 W. Roesser Road  
Phoenix, Arizona 85041

Key  
E = Entrance  
J = Janitor  
F = First Floor  
R = Rest Room

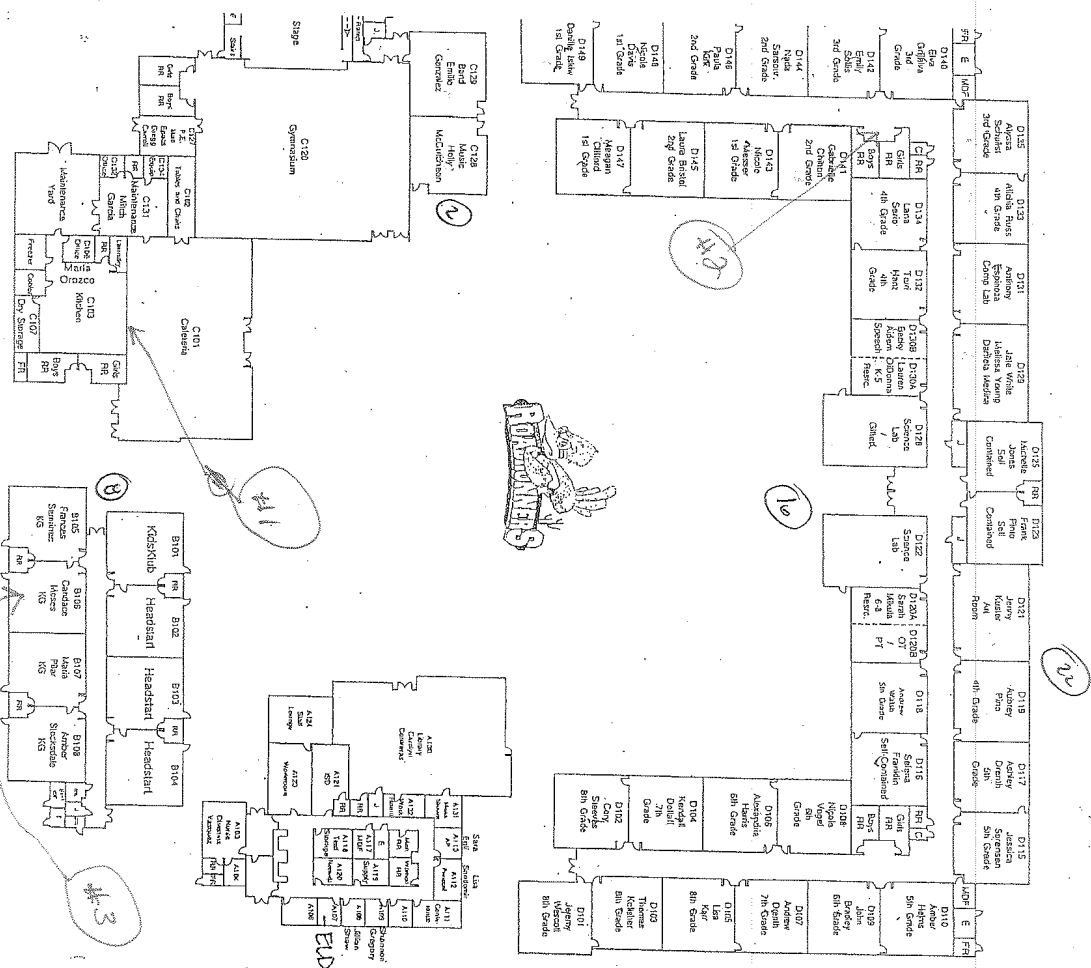



UNITED STATES OF AMERICA  
 ACCUTEST TEMPE SERVICE CENTER  
 1741 W. UNIVERSITY DR.  
 SUITE 400  
 TEMPE, AZ 85281  
 UNITED STATES US

CALL 1-800-438-0000  
 BILL RECIPIENT

TO HOLD AT FEDEX- SAMPLES  
 ACCUTEST LABORATORIES-LAFAYETTE, LA  
 109 COMMISSION BLVD

546391 A086301

LAFAYETTE LA 70508  
 (337) 237-4775 REF ADEQ

NO. PO. DEPT.



TRACK# 7787 9932 6411  
 0201  
 SATURDAY HOLD  
 PRIORITY OVERNIGHT  
 HLD  
 LFTA  
 LFT  
 LAJUS

X0 LFTA



LA 0524-1116

Deal (No)  
 (enc)

# SGS Accutest Sample Receipt Summary

Job Number: LA32009

Client: ADEQ

Project: MAURICE C CASH SCHOOL

Date / Time Received: 4/1/2017 9:45:00 AM

Delivery Method: FedEx

Airbill #s: 778799326411

Cooler Temps (Initial/Adjusted): #1: (24.1/24.1):

## Cooler Security

	Y	or	N		Y	or	N
1. Custody Seals Present:	<input checked="" type="checkbox"/>		<input type="checkbox"/>	3. COC Present:	<input checked="" type="checkbox"/>		<input type="checkbox"/>
2. Custody Seals Intact:	<input checked="" type="checkbox"/>		<input type="checkbox"/>	4. Smpl Dates/Time OK	<input checked="" type="checkbox"/>		<input type="checkbox"/>

## Cooler Temperature

	Y	or	N
1. Temp criteria achieved:	<input type="checkbox"/>		<input type="checkbox"/>
2. Thermometer ID:	;		
3. Cooler media:	No Ice		
4. No. Coolers:	1		

## Quality Control Preservation

	Y	or	N	N/A
1. Trip Blank present / cooler:	<input type="checkbox"/>		<input type="checkbox"/>	<input checked="" type="checkbox"/>
2. Trip Blank listed on COC:	<input type="checkbox"/>		<input type="checkbox"/>	<input checked="" type="checkbox"/>
3. Samples preserved properly:	<input checked="" type="checkbox"/>		<input type="checkbox"/>	
4. VOCs headspace free:	<input type="checkbox"/>		<input type="checkbox"/>	<input checked="" type="checkbox"/>

## Sample Integrity - Documentation

	Y	or	N
1. Sample labels present on bottles:	<input checked="" type="checkbox"/>		<input type="checkbox"/>
2. Container labeling complete:	<input checked="" type="checkbox"/>		<input type="checkbox"/>
3. Sample container label / COC agree:	<input checked="" type="checkbox"/>		<input type="checkbox"/>

## Sample Integrity - Condition

	Y	or	N
1. Sample recvd within HT:	<input checked="" type="checkbox"/>		<input type="checkbox"/>
2. All containers accounted for:	<input checked="" type="checkbox"/>		<input type="checkbox"/>
3. Condition of sample:	Intact		

## Sample Integrity - Instructions

	Y	or	N	N/A
1. Analysis requested is clear:	<input checked="" type="checkbox"/>		<input type="checkbox"/>	
2. Bottles received for unspecified tests	<input type="checkbox"/>		<input checked="" type="checkbox"/>	
3. Sufficient volume recvd for analysis:	<input checked="" type="checkbox"/>		<input type="checkbox"/>	
4. Compositing instructions clear:	<input type="checkbox"/>		<input type="checkbox"/>	<input checked="" type="checkbox"/>
5. Filtering instructions clear:	<input type="checkbox"/>		<input type="checkbox"/>	<input checked="" type="checkbox"/>

Comments

LA32009: Chain of Custody

Page 8 of 8

**Metals Analysis**

5

**QC Data Summaries**

---

**Includes the following where applicable:**

- **Method Blank Summaries**
- **Matrix Spike and Duplicate Summaries**
- **Blank Spike and Lab Control Sample Summaries**
- **Serial Dilution Summaries**

BLANK RESULTS SUMMARY  
Part 2 - Method Blanks

Login Number: LA32009  
Account: ADEQAZP - Arizona Dept. of Environmental Quality  
Project: School District, Lead in Drinking Water Testing

QC Batch ID: MP7347  
Matrix Type: DRINKING WATER

Methods: EPA 200.8  
Units: mg/l

Prep Date: 04/04/17

Metal	RL	IDL	MDL	MB raw	final
Aluminum	0.040	.048	.026		
Antimony	0.010	.0016	.0016		
Barium	0.010	.00015	.00064		
Beryllium	0.0010	.00003	.00013		
Boron	0.040	.0023	.005		
Calcium	0.40	.027	.057		
Lithium	0.0040	.0001	.00021		
Lead	0.0010	.000045	.00026	-0.0000068	<0.0010
Molybdenum	0.0040	.0003	.00087		
Potassium	0.20	.034	.018		
Uranium	0.0020		.00016		

Associated samples MP7347: LA32009-1, LA32009-2, LA32009-3, LA32009-4

Results < IDL are shown as zero for calculation purposes  
(\*) Outside of QC limits  
(anr) Analyte not requested

5.1.1

5

MATRIX SPIKE AND DUPLICATE RESULTS SUMMARY

Login Number: LA32009  
 Account: ADEQAZP - Arizona Dept. of Environmental Quality  
 Project: School District, Lead in Drinking Water Testing

QC Batch ID: MP7347  
 Matrix Type: DRINKING WATER

Methods: EPA 200.8  
 Units: mg/l

Prep Date: 04/04/17

Metal	LA32008-31 Original MS		Spikelet MPICPMS5 % Rec		QC Limits
Aluminum					
Antimony					
Barium					
Beryllium					
Boron					
Calcium					
Lithium					
Lead	0.0022	0.18	0.20	88.9	70-130
Molybdenum					
Potassium					
Uranium					

Associated samples MP7347: LA32009-1, LA32009-2, LA32009-3, LA32009-4

Results < IDL are shown as zero for calculation purposes  
 (\*) Outside of QC limits  
 (N) Matrix Spike Rec. outside of QC limits  
 (anr) Analyte not requested

MATRIX SPIKE AND DUPLICATE RESULTS SUMMARY

Login Number: LA32009  
 Account: ADEQAZP - Arizona Dept. of Environmental Quality  
 Project: School District, Lead in Drinking Water Testing

QC Batch ID: MP7347  
 Matrix Type: DRINKING WATER

Methods: EPA 200.8  
 Units: mg/l

Prep Date: 04/04/17

Metal	LA32008-31 Original MSD	Spikelot MPICPMS5 % Rec	MSD RPD	QC Limit
Aluminum				
Antimony				
Barium				
Beryllium				
Boron				
Calcium				
Lithium				
Lead	0.0022	0.18	0.20	88.9
Molybdenum				
Potassium				
Uranium				

Associated samples MP7347: LA32009-1, LA32009-2, LA32009-3, LA32009-4

Results < IDL are shown as zero for calculation purposes  
 (\*) Outside of QC limits  
 (N) Matrix Spike Rec. outside of QC limits  
 (anr) Analyte not requested

SPIKE BLANK AND LAB CONTROL SAMPLE SUMMARY

Login Number: LA32009  
 Account: ADEQAZP - Arizona Dept. of Environmental Quality  
 Project: School District, Lead in Drinking Water Testing

QC Batch ID: MP7347  
 Matrix Type: DRINKING WATER

Methods: EPA 200.8  
 Units: mg/l

Prep Date: 04/04/17

Metal	BSP Result	Spikelot MPICPMS5	% Rec	QC Limits
Aluminum				
Antimony				
Barium				
Beryllium				
Boron				
Calcium				
Lithium				
Lead	0.19	0.20	95.0	85-115
Molybdenum				
Potassium				
Uranium				

Associated samples MP7347: LA32009-1, LA32009-2, LA32009-3, LA32009-4

Results < IDL are shown as zero for calculation purposes  
 (\*) Outside of QC limits  
 (anr) Analyte not requested

SERIAL DILUTION RESULTS SUMMARY

Login Number: LA32009  
 Account: ADEQAZP - Arizona Dept. of Environmental Quality  
 Project: School District, Lead in Drinking Water Testing

QC Batch ID: MP7347  
 Matrix Type: DRINKING WATER

Methods: EPA 200.8  
 Units: ug/l

Prep Date: 04/04/17

Metal	LA32008-31			QC	
	Original	SDL 1:5	%DIF	Limits	
Aluminum					
Antimony					
Barium					
Beryllium					
Boron					
Calcium					
Lithium					
Lead	1.08	1.02	5.2	0-10	
Molybdenum					
Potassium					
Uranium					

Associated samples MP7347: LA32009-1, LA32009-2, LA32009-3, LA32009-4

Results < IDL are shown as zero for calculation purposes  
 (\*) Outside of QC limits  
 (anr) Analyte not requested