

TestAmerica

THE LEADER IN ENVIRONMENTAL TESTING

ANALYTICAL REPORT

TestAmerica Laboratories, Inc.

TestAmerica Phoenix

4625 East Cotton Ctr Blvd

Suite 189

Phoenix, AZ 85040

Tel: (602)437-3340

TestAmerica Job ID: 550-79402-1

TestAmerica SDG: Creighton School Confirmation Sampling

Client Project/Site: Pb in DW/Creighton School District

For:

Arizona Dept of Environmental Quality

1110 W. Washington St., MC5415B-1

Phoenix, Arizona 85007

Attn: David A Burchard



Authorized for release by:

4/5/2017 5:26:07 PM

Susan Armijo, Project Manager II

(602)659-7664

susan.armijo@testamericainc.com

LINKS

Review your project
results through

TotalAccess

Have a Question?



Visit us at:

www.testamericainc.com

This report has been electronically signed and authorized by the signatory. Electronic signature is intended to be the legally binding equivalent of a traditionally handwritten signature.

Results relate only to the items tested and the sample(s) as received by the laboratory.

Table of Contents

Cover Page	1
Table of Contents	2
Definitions/Glossary	3
Case Narrative	4
Sample Summary	5
Detection Summary	7
Client Sample Results	14
QC Sample Results	24
QC Association Summary	27
Lab Chronicle	31
Certification Summary	42
Method Summary	43
Chain of Custody	44
Receipt Checklists	54



Definitions/Glossary

Client: Arizona Dept of Environmental Quality
Project/Site: Pb in DW/Creighton School District

TestAmerica Job ID: 550-79402-1
SDG: Creighton School Confirmation Sampling

Qualifiers

Metals

Qualifier	Qualifier Description
D2	Sample required dilution due to high concentration of analyte.

Glossary

Abbreviation	These commonly used abbreviations may or may not be present in this report.
α	Listed under the "D" column to designate that the result is reported on a dry weight basis
%R	Percent Recovery
CFL	Contains Free Liquid
CNF	Contains no Free Liquid
DER	Duplicate error ratio (normalized absolute difference)
Dil Fac	Dilution Factor
DL, RA, RE, IN	Indicates a Dilution, Re-analysis, Re-extraction, or additional Initial metals/anion analysis of the sample
DLC	Decision level concentration
MDA	Minimum detectable activity
EDL	Estimated Detection Limit
MDC	Minimum detectable concentration
MDL	Method Detection Limit
ML	Minimum Level (Dioxin)
NC	Not Calculated
ND	Not detected at the reporting limit (or MDL or EDL if shown)
PQL	Practical Quantitation Limit
QC	Quality Control
RER	Relative error ratio
RL	Reporting Limit or Requested Limit (Radiochemistry)
RPD	Relative Percent Difference, a measure of the relative difference between two points
TEF	Toxicity Equivalent Factor (Dioxin)
TEQ	Toxicity Equivalent Quotient (Dioxin)

Case Narrative

Client: Arizona Dept of Environmental Quality
Project/Site: Pb in DW/Creighton School District

TestAmerica Job ID: 550-79402-1
SDG: Creighton School Confirmation Sampling

Job ID: 550-79402-1

Laboratory: TestAmerica Phoenix

Narrative

Job Narrative 550-79402-1

Comments

No additional comments.

Receipt

The samples were received on 3/16/2017 4:15 PM; the samples arrived in good condition, properly preserved and, where required, on ice. The temperature of the cooler at receipt was 24.2° C.

Receipt Exceptions

The following samples for metals were received unpreserved and were preserved upon receipt to the laboratory: Building CC Library Office Sink ID-1 (550-79402-1), Building CC Library Office Sink flush (550-79402-2), Building CC Room 203 Sink (550-79402-3), Building CC Room 211 Faucet (550-79402-4), Building CC Room 211 Drinking Fountain (550-79402-5), Building CC Room 210 Fountain (550-79402-6), Building CC Room 210 Faucet (550-79402-7), Building CC Room 213 Faucet (550-79402-8), Building CC Room 213 Fountain (550-79402-9), Building CC Room 212 Faucet (550-79402-10), Building CC Room 212 Fountain (550-79402-11), Building CC South Side Fountains East (550-79402-12), Building CC 214 Fountain (550-79402-13), Building CC 214 Faucet Sink (550-79402-14), Building CC 214 Restroom Sink (550-79402-15), Building CC 215 Faucet (550-79402-16), Building CC 215 Fountain (550-79402-17), Building CC 216 Faucet (550-79402-18), Building CC 216 Fountain (550-79402-19), Building CC Library Office Sink 1 (550-79402-20), Building CC Library Office Sink 2 (550-79402-21), Building CC Library Office Sink 3 (550-79402-22), Building CC Library Office Sink 4 (550-79402-23), Building CC Library Office Sink Source (550-79402-24), Building J East Side Hose BIB 1 ID (550-79402-25), Building J East Side Hose BIB 2 Flush (550-79402-26), Building J East Side Hose BIB 1 D-2 (550-79402-27), Building J East Side Hose BIB 2 D-2 (550-79402-28), Building J East Side Hose BIB 3 D-2 (550-79402-29), Building J East Side Hose BIB 4 D-2 (550-79402-30), Building J East Side Hose BIB Source (550-79402-31), Building E North Fountains 1 (550-79402-32), Building E North Fountains 2 (550-79402-33), Building E North Fountains 3 (550-79402-34), Building E North Fountains 4 (550-79402-35), Building E West Fountains 1 ID 1 (550-79402-36), Building E West Fountains West # 2 (550-79402-37), Building E West Fountains 1 ID flush (550-79402-38), Building E West Fountains D-2 (550-79402-39), Building E West Fountains D-2 (550-79402-40), Building E West Fountains D-2 (550-79402-41), Building E West Fountains D-2 (550-79402-42), Building E West Fountains Source (550-79402-43), Building F East Side Fountains 1 (550-79402-44), Building F East Side Fountains 2 ID 1 (550-79402-45), Building F East Side Fountains 2 ID Flush (550-79402-46), Building F East Side Fountains 1 (550-79402-47), Building F East Side Fountains 2 (550-79402-48), Building F East Side Fountains 3 (550-79402-49), Building F East Side Fountains 4 (550-79402-50), Building F East Side Fountains Source (550-79402-51), Building K 800 Womens Restroom East (550-79402-52), Building K 800 Womens Restroom West (550-79402-53), Building K Fountains North 1 (550-79402-54), Building K Fountains North 2 (550-79402-55), Building K Room 804 faucet (550-79402-56), Building K Room 803 faucet (550-79402-57), Building K 800 Mens Restroom West (550-79402-58), Building K Room 802 Sink ID1 (550-79402-59), Building K Room 802 Sink Flush (550-79402-60), Building K Room 802 Sink 1 (550-79402-61), Building K Room 802 Sink 2 (550-79402-62), Building K Room 802 Sink 3 (550-79402-63), Building K Room 802 Sink 4 (550-79402-64) and Building K Room 802 Source (550-79402-65). Regulatory documents require a 24-hour waiting period from the time of the addition of the acid preservative to the time of digestion.

Metals

Method(s) 200.8: The following sample was diluted to bring the concentration of target analytes within the calibration range: Building E West Fountains West # 2 (550-79402-37). Elevated reporting limits (RLs) are provided.

Method(s) 200.8: The following sample was diluted to bring the concentration of target analytes within the calibration range: Building CC Library Office Sink Source (550-79402-24) and Building E West Fountains D-2 (550-79402-39). Elevated reporting limits (RLs) are provided.

No additional analytical or quality issues were noted, other than those described above or in the Definitions/Glossary page.

Sample Summary

Client: Arizona Dept of Environmental Quality
Project/Site: Pb in DW/Creighton School District

TestAmerica Job ID: 550-79402-1
SDG: Creighton School Confirmation Sampling

Lab Sample ID	Client Sample ID	Matrix	Collected	Received
550-79402-1	Building CC Library Office Sink ID-1	Drinking Water	03/14/17 08:46	03/16/17 16:15
550-79402-2	Building CC Library Office Sink flush	Drinking Water	03/14/17 08:48	03/16/17 16:15
550-79402-3	Building CC Room 203 Sink	Drinking Water	03/14/17 08:52	03/16/17 16:15
550-79402-4	Building CC Room 211 Faucet	Drinking Water	03/14/17 08:57	03/16/17 16:15
550-79402-5	Building CC Room 211 Drinking Fountain	Drinking Water	03/14/17 08:57	03/16/17 16:15
550-79402-6	Building CC Room 210 Fountain	Drinking Water	03/14/17 09:01	03/16/17 16:15
550-79402-7	Building CC Room 210 Faucet	Drinking Water	03/14/17 09:01	03/16/17 16:15
550-79402-8	Building CC Room 213 Faucet	Drinking Water	03/14/17 09:04	03/16/17 16:15
550-79402-9	Building CC Room 213 Fountain	Drinking Water	03/14/17 09:04	03/16/17 16:15
550-79402-10	Building CC Room 212 Faucet	Drinking Water	03/14/17 09:06	03/16/17 16:15
550-79402-11	Building CC Room 212 Fountain	Drinking Water	03/14/17 09:06	03/16/17 16:15
550-79402-12	Building CC South Side Fountains East	Drinking Water	03/14/17 09:11	03/16/17 16:15
550-79402-13	Building CC 214 Fountain	Drinking Water	03/14/17 09:29	03/16/17 16:15
550-79402-14	Building CC 214 Faucet Sink	Drinking Water	03/14/17 09:29	03/16/17 16:15
550-79402-15	Building CC 214 Restroom Sink	Drinking Water	03/14/17 09:32	03/16/17 16:15
550-79402-16	Building CC 215 Faucet	Drinking Water	03/14/17 09:34	03/16/17 16:15
550-79402-17	Building CC 215 Fountain	Drinking Water	03/14/17 09:34	03/16/17 16:15
550-79402-18	Building CC 216 Faucet	Drinking Water	03/14/17 09:37	03/16/17 16:15
550-79402-19	Building CC 216 Fountain	Drinking Water	03/14/17 09:37	03/16/17 16:15
550-79402-20	Building CC Library Office Sink 1	Drinking Water	03/15/17 08:59	03/16/17 16:15
550-79402-21	Building CC Library Office Sink 2	Drinking Water	03/15/17 09:00	03/16/17 16:15
550-79402-22	Building CC Library Office Sink 3	Drinking Water	03/15/17 09:01	03/16/17 16:15
550-79402-23	Building CC Library Office Sink 4	Drinking Water	03/15/17 09:02	03/16/17 16:15
550-79402-24	Building CC Library Office Sink Source	Drinking Water	03/15/17 09:03	03/16/17 16:15
550-79402-25	Building J East Side Hose BIB 1 ID	Drinking Water	03/14/17 08:07	03/16/17 16:15
550-79402-26	Building J East Side Hose BIB 2 Flush	Drinking Water	03/14/17 08:10	03/16/17 16:15
550-79402-27	Building J East Side Hose BIB 1 D-2	Drinking Water	03/15/17 08:41	03/16/17 16:15
550-79402-28	Building J East Side Hose BIB 2 D-2	Drinking Water	03/15/17 08:42	03/16/17 16:15
550-79402-29	Building J East Side Hose BIB 3 D-2	Drinking Water	03/15/17 08:43	03/16/17 16:15
550-79402-30	Building J East Side Hose BIB 4 D-2	Drinking Water	03/15/17 08:43	03/16/17 16:15
550-79402-31	Building J East Side Hose BIB Source	Drinking Water	03/15/17 08:44	03/16/17 16:15
550-79402-32	Building E North Fountains 1	Drinking Water	03/14/17 07:40	03/16/17 16:15
550-79402-33	Building E North Fountains 2	Drinking Water	03/14/17 07:40	03/16/17 16:15
550-79402-34	Building E North Fountains 3	Drinking Water	03/14/17 07:40	03/16/17 16:15
550-79402-35	Building E North Fountains 4	Drinking Water	03/14/17 07:40	03/16/17 16:15
550-79402-36	Building E West Fountains 1 ID 1	Drinking Water	03/14/17 07:46	03/16/17 16:15
550-79402-37	Building E West Fountains West # 2	Drinking Water	03/14/17 07:46	03/16/17 16:15
550-79402-38	Building E West Fountains 1 ID flush	Drinking Water	03/14/17 07:48	03/16/17 16:15
550-79402-39	Building E West Fountains D-2	Drinking Water	03/15/17 08:16	03/16/17 16:15
550-79402-40	Building E West Fountains D-2	Drinking Water	03/15/17 08:18	03/16/17 16:15
550-79402-41	Building E West Fountains D-2	Drinking Water	03/15/17 08:19	03/16/17 16:15
550-79402-42	Building E West Fountains D-2	Drinking Water	03/15/17 08:20	03/16/17 16:15
550-79402-43	Building E West Fountains Source	Drinking Water	03/15/17 08:21	03/16/17 16:15
550-79402-44	Building F East Side Fountains 1	Drinking Water	03/14/17 07:58	03/16/17 16:15
550-79402-45	Building F East Side Fountains 2 ID 1	Drinking Water	03/14/17 07:58	03/16/17 16:15
550-79402-46	Building F East Side Fountains 2 ID Flush	Drinking Water	03/14/17 08:00	03/16/17 16:15
550-79402-47	Building F East Side Fountains 1	Drinking Water	03/15/17 08:30	03/16/17 16:15
550-79402-48	Building F East Side Fountains 2	Drinking Water	03/15/17 08:32	03/16/17 16:15
550-79402-49	Building F East Side Fountains 3	Drinking Water	03/15/17 08:33	03/16/17 16:15
550-79402-50	Building F East Side Fountains 4	Drinking Water	03/15/17 08:34	03/16/17 16:15
550-79402-51	Building F East Side Fountains Source	Drinking Water	03/15/17 08:35	03/16/17 16:15
550-79402-52	Building K 800 Womens Restroom East	Drinking Water	03/14/17 08:15	03/16/17 16:15
550-79402-53	Building K 800 Womens Restroom West	Drinking Water	03/14/17 08:16	03/16/17 16:15

TestAmerica Phoenix

Sample Summary

Client: Arizona Dept of Environmental Quality
Project/Site: Pb in DW/Creighton School District

TestAmerica Job ID: 550-79402-1
SDG: Creighton School Confirmation Sampling

Lab Sample ID	Client Sample ID	Matrix	Collected	Received
550-79402-54	Building K Fountains North 1	Drinking Water	03/14/17 08:16	03/16/17 16:15
550-79402-55	Building K Fountains North 2	Drinking Water	03/14/17 08:17	03/16/17 16:15
550-79402-56	Building K Room 804 faucet	Drinking Water	03/14/17 08:20	03/16/17 16:15
550-79402-57	Building K Room 803 faucet	Drinking Water	03/14/17 08:20	03/16/17 16:15
550-79402-58	Building K 800 Mens Restroom West	Drinking Water	03/14/17 08:24	03/16/17 16:15
550-79402-59	Building K Room 802 Sink ID1	Drinking Water	03/14/17 08:34	03/16/17 16:15
550-79402-60	Building K Room 802 Sink Flush	Drinking Water	03/14/17 08:35	03/16/17 16:15
550-79402-61	Building K Room 802 Sink 1	Drinking Water	03/15/17 08:52	03/16/17 16:15
550-79402-62	Building K Room 802 Sink 2	Drinking Water	03/15/17 08:50	03/16/17 16:15
550-79402-63	Building K Room 802 Sink 3	Drinking Water	03/15/17 08:51	03/16/17 16:15
550-79402-64	Building K Room 802 Sink 4	Drinking Water	03/15/17 08:53	03/16/17 16:15
550-79402-65	Building K Room 802 Source	Drinking Water	03/15/17 08:54	03/16/17 16:15

Detection Summary

Client: Arizona Dept of Environmental Quality
Project/Site: Pb in DW/Creighton School District

TestAmerica Job ID: 550-79402-1
SDG: Creighton School Confirmation Sampling

Client Sample ID: Building CC Library Office Sink ID-1

Lab Sample ID: 550-79402-1

Analyte	Result	Qualifier	RL	Unit	Dil Fac	D	Method	Prep Type
Lead	69		0.50	ppb	1		200.8	Total/NA

Client Sample ID: Building CC Library Office Sink flush

Lab Sample ID: 550-79402-2

Analyte	Result	Qualifier	RL	Unit	Dil Fac	D	Method	Prep Type
Lead	5.5		0.50	ppb	1		200.8	Total/NA

Client Sample ID: Building CC Room 203 Sink

Lab Sample ID: 550-79402-3

Analyte	Result	Qualifier	RL	Unit	Dil Fac	D	Method	Prep Type
Lead	16		0.50	ppb	1		200.8	Total/NA

Client Sample ID: Building CC Room 211 Faucet

Lab Sample ID: 550-79402-4

Analyte	Result	Qualifier	RL	Unit	Dil Fac	D	Method	Prep Type
Lead	5.0		0.50	ppb	1		200.8	Total/NA

Client Sample ID: Building CC Room 211 Drinking Fountain

Lab Sample ID: 550-79402-5

Analyte	Result	Qualifier	RL	Unit	Dil Fac	D	Method	Prep Type
Lead	0.94		0.50	ppb	1		200.8	Total/NA

Client Sample ID: Building CC Room 210 Fountain

Lab Sample ID: 550-79402-6

Analyte	Result	Qualifier	RL	Unit	Dil Fac	D	Method	Prep Type
Lead	58		0.50	ppb	1		200.8	Total/NA

Client Sample ID: Building CC Room 210 Faucet

Lab Sample ID: 550-79402-7

Analyte	Result	Qualifier	RL	Unit	Dil Fac	D	Method	Prep Type
Lead	69		0.50	ppb	1		200.8	Total/NA

Client Sample ID: Building CC Room 213 Faucet

Lab Sample ID: 550-79402-8

Analyte	Result	Qualifier	RL	Unit	Dil Fac	D	Method	Prep Type
Lead	5.2		0.50	ppb	1		200.8	Total/NA

Client Sample ID: Building CC Room 213 Fountain

Lab Sample ID: 550-79402-9

Analyte	Result	Qualifier	RL	Unit	Dil Fac	D	Method	Prep Type
Lead	1.6		0.50	ppb	1		200.8	Total/NA

Client Sample ID: Building CC Room 212 Faucet

Lab Sample ID: 550-79402-10

Analyte	Result	Qualifier	RL	Unit	Dil Fac	D	Method	Prep Type
Lead	1.8		0.50	ppb	1		200.8	Total/NA

Client Sample ID: Building CC Room 212 Fountain

Lab Sample ID: 550-79402-11

Analyte	Result	Qualifier	RL	Unit	Dil Fac	D	Method	Prep Type
Lead								

This Detection Summary does not include radiochemical test results.

TestAmerica Phoenix

Detection Summary

Client: Arizona Dept of Environmental Quality
Project/Site: Pb in DW/Creighton School District

TestAmerica Job ID: 550-79402-1
SDG: Creighton School Confirmation Sampling

Client Sample ID: Building CC Room 212 Fountain (Continued)

Lab Sample ID: 550-79402-11

Analyte	Result	Qualifier	RL	Unit	Dil Fac	D	Method	Prep Type
Lead	2.4		0.50	ppb	1		200.8	Total/NA

Client Sample ID: Building CC South Side Fountains East

Lab Sample ID: 550-79402-12

Analyte	Result	Qualifier	RL	Unit	Dil Fac	D	Method	Prep Type
Lead	370		0.50	ppb	1		200.8	Total/NA

Client Sample ID: Building CC 214 Fountain

Lab Sample ID: 550-79402-13

Analyte	Result	Qualifier	RL	Unit	Dil Fac	D	Method	Prep Type
Lead	0.80		0.50	ppb	1		200.8	Total/NA

Client Sample ID: Building CC 214 Faucet Sink

Lab Sample ID: 550-79402-14

Analyte	Result	Qualifier	RL	Unit	Dil Fac	D	Method	Prep Type
Lead	3.7		0.50	ppb	1		200.8	Total/NA

Client Sample ID: Building CC 214 Restroom Sink

Lab Sample ID: 550-79402-15

Analyte	Result	Qualifier	RL	Unit	Dil Fac	D	Method	Prep Type
Lead	1.7		0.50	ppb	1		200.8	Total/NA

Client Sample ID: Building CC 215 Faucet

Lab Sample ID: 550-79402-16

Analyte	Result	Qualifier	RL	Unit	Dil Fac	D	Method	Prep Type
Lead	20		0.50	ppb	1		200.8	Total/NA

Client Sample ID: Building CC 215 Fountain

Lab Sample ID: 550-79402-17

Analyte	Result	Qualifier	RL	Unit	Dil Fac	D	Method	Prep Type
Lead	1.3		0.50	ppb	1		200.8	Total/NA

Client Sample ID: Building CC 216 Faucet

Lab Sample ID: 550-79402-18

Analyte	Result	Qualifier	RL	Unit	Dil Fac	D	Method	Prep Type
Lead	1.6		0.50	ppb	1		200.8	Total/NA

Client Sample ID: Building CC 216 Fountain

Lab Sample ID: 550-79402-19

Analyte	Result	Qualifier	RL	Unit	Dil Fac	D	Method	Prep Type
Lead	0.87		0.50	ppb	1		200.8	Total/NA

Client Sample ID: Building CC Library Office Sink 1

Lab Sample ID: 550-79402-20

Analyte	Result	Qualifier	RL	Unit	Dil Fac	D	Method	Prep Type
Lead	42		0.50	ppb	1		200.8	Total/NA

Client Sample ID: Building CC Library Office Sink 2

Lab Sample ID: 550-79402-21

Analyte	Result	Qualifier	RL	Unit	Dil Fac	D	Method	Prep Type
Lead								

This Detection Summary does not include radiochemical test results.

TestAmerica Phoenix

Detection Summary

Client: Arizona Dept of Environmental Quality
Project/Site: Pb in DW/Creighton School District

TestAmerica Job ID: 550-79402-1
SDG: Creighton School Confirmation Sampling

Client Sample ID: Building CC Library Office Sink 2 (Continued)

Lab Sample ID: 550-79402-21

Analyte	Result	Qualifier	RL	Unit	Dil Fac	D	Method	Prep Type
Lead	4.7		0.50	ppb	1		200.8	Total/NA

Client Sample ID: Building CC Library Office Sink 3

Lab Sample ID: 550-79402-22

Analyte	Result	Qualifier	RL	Unit	Dil Fac	D	Method	Prep Type
Lead	5.9		0.50	ppb	1		200.8	Total/NA

Client Sample ID: Building CC Library Office Sink 4

Lab Sample ID: 550-79402-23

Analyte	Result	Qualifier	RL	Unit	Dil Fac	D	Method	Prep Type
Lead	5.2		0.50	ppb	1		200.8	Total/NA

Client Sample ID: Building CC Library Office Sink Source

Lab Sample ID: 550-79402-24

Analyte	Result	Qualifier	RL	Unit	Dil Fac	D	Method	Prep Type
Lead	2700	D2	50	ppb	100		200.8	Total/NA

Client Sample ID: Building J East Side Hose BIB 1 ID

Lab Sample ID: 550-79402-25

Analyte	Result	Qualifier	RL	Unit	Dil Fac	D	Method	Prep Type
Lead	9.7		0.50	ppb	1		200.8	Total/NA

Client Sample ID: Building J East Side Hose BIB 2 Flush

Lab Sample ID: 550-79402-26

Analyte	Result	Qualifier	RL	Unit	Dil Fac	D	Method	Prep Type
Lead	39		0.50	ppb	1		200.8	Total/NA

Client Sample ID: Building J East Side Hose BIB 1 D-2

Lab Sample ID: 550-79402-27

Analyte	Result	Qualifier	RL	Unit	Dil Fac	D	Method	Prep Type
Lead	22		0.50	ppb	1		200.8	Total/NA

Client Sample ID: Building J East Side Hose BIB 2 D-2

Lab Sample ID: 550-79402-28

Analyte	Result	Qualifier	RL	Unit	Dil Fac	D	Method	Prep Type
Lead	12		0.50	ppb	1		200.8	Total/NA

Client Sample ID: Building J East Side Hose BIB 3 D-2

Lab Sample ID: 550-79402-29

Analyte	Result	Qualifier	RL	Unit	Dil Fac	D	Method	Prep Type
Lead	16		0.50	ppb	1		200.8	Total/NA

Client Sample ID: Building J East Side Hose BIB 4 D-2

Lab Sample ID: 550-79402-30

Analyte	Result	Qualifier	RL	Unit	Dil Fac	D	Method	Prep Type
Lead	29		0.50	ppb	1		200.8	Total/NA

Client Sample ID: Building J East Side Hose BIB Source

Lab Sample ID: 550-79402-31

This Detection Summary does not include radiochemical test results.

TestAmerica Phoenix

Detection Summary

Client: Arizona Dept of Environmental Quality
Project/Site: Pb in DW/Creighton School District

TestAmerica Job ID: 550-79402-1
SDG: Creighton School Confirmation Sampling

Client Sample ID: Building J East Side Hose BIB Source (Continued)

Lab Sample ID: 550-79402-31

Analyte	Result	Qualifier	RL	Unit	Dil Fac	D	Method	Prep Type
Lead	9.9		0.50	ppb	1		200.8	Total/NA

Client Sample ID: Building E North Fountains 1

Lab Sample ID: 550-79402-32

No Detections.

Client Sample ID: Building E North Fountains 2

Lab Sample ID: 550-79402-33

No Detections.

Client Sample ID: Building E North Fountains 3

Lab Sample ID: 550-79402-34

Analyte	Result	Qualifier	RL	Unit	Dil Fac	D	Method	Prep Type
Lead	2.0		0.50	ppb	1		200.8	Total/NA

Client Sample ID: Building E North Fountains 4

Lab Sample ID: 550-79402-35

Analyte	Result	Qualifier	RL	Unit	Dil Fac	D	Method	Prep Type
Lead	1.9		0.50	ppb	1		200.8	Total/NA

Client Sample ID: Building E West Fountains 1 ID 1

Lab Sample ID: 550-79402-36

Analyte	Result	Qualifier	RL	Unit	Dil Fac	D	Method	Prep Type
Lead	110		0.50	ppb	1		200.8	Total/NA

Client Sample ID: Building E West Fountains West # 2

Lab Sample ID: 550-79402-37

Analyte	Result	Qualifier	RL	Unit	Dil Fac	D	Method	Prep Type
Lead	1300	D2	5.0	ppb	10		200.8	Total/NA

Client Sample ID: Building E West Fountains 1 ID flush

Lab Sample ID: 550-79402-38

Analyte	Result	Qualifier	RL	Unit	Dil Fac	D	Method	Prep Type
Lead	2.4		0.50	ppb	1		200.8	Total/NA

Client Sample ID: Building E West Fountains D-2

Lab Sample ID: 550-79402-39

Analyte	Result	Qualifier	RL	Unit	Dil Fac	D	Method	Prep Type
Lead	1400	D2	50	ppb	100		200.8	Total/NA

Client Sample ID: Building E West Fountains D-2

Lab Sample ID: 550-79402-40

Analyte	Result	Qualifier	RL	Unit	Dil Fac	D	Method	Prep Type
Lead	120		0.50	ppb	1		200.8	Total/NA

Client Sample ID: Building E West Fountains D-2

Lab Sample ID: 550-79402-41

Analyte	Result	Qualifier	RL	Unit	Dil Fac	D	Method	Prep Type
Lead	35		0.50	ppb	1		200.8	Total/NA

This Detection Summary does not include radiochemical test results.

TestAmerica Phoenix

Detection Summary

Client: Arizona Dept of Environmental Quality
Project/Site: Pb in DW/Creighton School District

TestAmerica Job ID: 550-79402-1
SDG: Creighton School Confirmation Sampling

Client Sample ID: Building E West Fountains D-2

Lab Sample ID: 550-79402-42

Analyte	Result	Qualifier	RL	Unit	Dil Fac	D	Method	Prep Type
Lead	23		0.50	ppb	1		200.8	Total/NA

Client Sample ID: Building E West Fountains Source

Lab Sample ID: 550-79402-43

Analyte	Result	Qualifier	RL	Unit	Dil Fac	D	Method	Prep Type
Lead	29		0.50	ppb	1		200.8	Total/NA

Client Sample ID: Building F East Side Fountains 1

Lab Sample ID: 550-79402-44

Analyte	Result	Qualifier	RL	Unit	Dil Fac	D	Method	Prep Type
Lead	25		0.50	ppb	1		200.8	Total/NA

Client Sample ID: Building F East Side Fountains 2 ID 1

Lab Sample ID: 550-79402-45

Analyte	Result	Qualifier	RL	Unit	Dil Fac	D	Method	Prep Type
Lead	39		0.50	ppb	1		200.8	Total/NA

Client Sample ID: Building F East Side Fountains 2 ID Flush

Lab Sample ID: 550-79402-46

Analyte	Result	Qualifier	RL	Unit	Dil Fac	D	Method	Prep Type
Lead	15		0.50	ppb	1		200.8	Total/NA

Client Sample ID: Building F East Side Fountains 1

Lab Sample ID: 550-79402-47

Analyte	Result	Qualifier	RL	Unit	Dil Fac	D	Method	Prep Type
Lead	23		0.50	ppb	1		200.8	Total/NA

Client Sample ID: Building F East Side Fountains 2

Lab Sample ID: 550-79402-48

Analyte	Result	Qualifier	RL	Unit	Dil Fac	D	Method	Prep Type
Lead	16		0.50	ppb	1		200.8	Total/NA

Client Sample ID: Building F East Side Fountains 3

Lab Sample ID: 550-79402-49

Analyte	Result	Qualifier	RL	Unit	Dil Fac	D	Method	Prep Type
Lead	29		0.50	ppb	1		200.8	Total/NA

Client Sample ID: Building F East Side Fountains 4

Lab Sample ID: 550-79402-50

Analyte	Result	Qualifier	RL	Unit	Dil Fac	D	Method	Prep Type
Lead	18		0.50	ppb	1		200.8	Total/NA

Client Sample ID: Building F East Side Fountains Source

Lab Sample ID: 550-79402-51

Analyte	Result	Qualifier	RL	Unit	Dil Fac	D	Method	Prep Type
Lead	130		0.50	ppb	1		200.8	Total/NA

Client Sample ID: Building K 800 Womens Restroom East

Lab Sample ID: 550-79402-52

Analyte	Result	Qualifier	RL	Unit	Dil Fac	D	Method	Prep Type
Lead								

This Detection Summary does not include radiochemical test results.

TestAmerica Phoenix

Detection Summary

Client: Arizona Dept of Environmental Quality
Project/Site: Pb in DW/Creighton School District

TestAmerica Job ID: 550-79402-1
SDG: Creighton School Confirmation Sampling

Client Sample ID: Building K 800 Womens Restroom East (Continued)

Lab Sample ID: 550-79402-52

Analyte	Result	Qualifier	RL	Unit	Dil Fac	D	Method	Prep Type
Lead	36		0.50	ppb	1		200.8	Total/NA

Client Sample ID: Building K 800 Womens Restroom West

Lab Sample ID: 550-79402-53

Analyte	Result	Qualifier	RL	Unit	Dil Fac	D	Method	Prep Type
Lead	37		0.50	ppb	1		200.8	Total/NA

Client Sample ID: Building K Fountains North 1

Lab Sample ID: 550-79402-54

Analyte	Result	Qualifier	RL	Unit	Dil Fac	D	Method	Prep Type
Lead	1.8		0.50	ppb	1		200.8	Total/NA

Client Sample ID: Building K Fountains North 2

Lab Sample ID: 550-79402-55

Analyte	Result	Qualifier	RL	Unit	Dil Fac	D	Method	Prep Type
Lead	2.0		0.50	ppb	1		200.8	Total/NA

Client Sample ID: Building K Room 804 faucet

Lab Sample ID: 550-79402-56

Analyte	Result	Qualifier	RL	Unit	Dil Fac	D	Method	Prep Type
Lead	15		0.50	ppb	1		200.8	Total/NA

Client Sample ID: Building K Room 803 faucet

Lab Sample ID: 550-79402-57

Analyte	Result	Qualifier	RL	Unit	Dil Fac	D	Method	Prep Type
Lead	8.7		0.50	ppb	1		200.8	Total/NA

Client Sample ID: Building K 800 Mens Restroom West

Lab Sample ID: 550-79402-58

Analyte	Result	Qualifier	RL	Unit	Dil Fac	D	Method	Prep Type
Lead	5.6		0.50	ppb	1		200.8	Total/NA

Client Sample ID: Building K Room 802 Sink ID1

Lab Sample ID: 550-79402-59

Analyte	Result	Qualifier	RL	Unit	Dil Fac	D	Method	Prep Type
Lead	34		0.50	ppb	1		200.8	Total/NA

Client Sample ID: Building K Room 802 Sink Flush

Lab Sample ID: 550-79402-60

Analyte	Result	Qualifier	RL	Unit	Dil Fac	D	Method	Prep Type
Lead	6.5		0.50	ppb	1		200.8	Total/NA

Client Sample ID: Building K Room 802 Sink 1

Lab Sample ID: 550-79402-61

Analyte	Result	Qualifier	RL	Unit	Dil Fac	D	Method	Prep Type
Lead	20		0.50	ppb	1		200.8	Total/NA

Client Sample ID: Building K Room 802 Sink 2

Lab Sample ID: 550-79402-62

This Detection Summary does not include radiochemical test results.

TestAmerica Phoenix

Detection Summary

Client: Arizona Dept of Environmental Quality
Project/Site: Pb in DW/Creighton School District

TestAmerica Job ID: 550-79402-1
SDG: Creighton School Confirmation Sampling

Client Sample ID: Building K Room 802 Sink 2 (Continued)

Lab Sample ID: 550-79402-62

Analyte	Result	Qualifier	RL	Unit	Dil Fac	D	Method	Prep Type
Lead	18		0.50	ppb	1		200.8	Total/NA

Client Sample ID: Building K Room 802 Sink 3

Lab Sample ID: 550-79402-63

Analyte	Result	Qualifier	RL	Unit	Dil Fac	D	Method	Prep Type
Lead	20		0.50	ppb	1		200.8	Total/NA

Client Sample ID: Building K Room 802 Sink 4

Lab Sample ID: 550-79402-64

Analyte	Result	Qualifier	RL	Unit	Dil Fac	D	Method	Prep Type
Lead	25		0.50	ppb	1		200.8	Total/NA

Client Sample ID: Building K Room 802 Source

Lab Sample ID: 550-79402-65

Analyte	Result	Qualifier	RL	Unit	Dil Fac	D	Method	Prep Type
Lead	64		0.50	ppb	1		200.8	Total/NA

This Detection Summary does not include radiochemical test results.

TestAmerica Phoenix

Client Sample Results

Client: Arizona Dept of Environmental Quality
Project/Site: Pb in DW/Creighton School District

TestAmerica Job ID: 550-79402-1
SDG: Creighton School Confirmation Sampling

Client Sample ID: Building CC Library Office Sink ID-1

Lab Sample ID: 550-79402-1

Date Collected: 03/14/17 08:46

Matrix: Drinking Water

Date Received: 03/16/17 16:15

Method: 200.8 - Metals (ICP/MS)

Analyte	Result	Qualifier	RL	Unit	D	Prepared	Analyzed	Dil Fac
Lead	69		0.50	ppb		03/22/17 07:28	03/25/17 09:17	1

Client Sample ID: Building CC Library Office Sink flush

Lab Sample ID: 550-79402-2

Date Collected: 03/14/17 08:48

Matrix: Drinking Water

Date Received: 03/16/17 16:15

Method: 200.8 - Metals (ICP/MS)

Analyte	Result	Qualifier	RL	Unit	D	Prepared	Analyzed	Dil Fac
Lead	5.5		0.50	ppb		03/22/17 07:28	03/25/17 09:18	1

Client Sample ID: Building CC Room 203 Sink

Lab Sample ID: 550-79402-3

Date Collected: 03/14/17 08:52

Matrix: Drinking Water

Date Received: 03/16/17 16:15

Method: 200.8 - Metals (ICP/MS)

Analyte	Result	Qualifier	RL	Unit	D	Prepared	Analyzed	Dil Fac
Lead	16		0.50	ppb		03/22/17 07:28	03/25/17 09:20	1

Client Sample ID: Building CC Room 211 Faucet

Lab Sample ID: 550-79402-4

Date Collected: 03/14/17 08:57

Matrix: Drinking Water

Date Received: 03/16/17 16:15

Method: 200.8 - Metals (ICP/MS)

Analyte	Result	Qualifier	RL	Unit	D	Prepared	Analyzed	Dil Fac
Lead	5.0		0.50	ppb		03/22/17 07:28	03/25/17 09:22	1

Client Sample ID: Building CC Room 211 Drinking Fountain

Lab Sample ID: 550-79402-5

Date Collected: 03/14/17 08:57

Matrix: Drinking Water

Date Received: 03/16/17 16:15

Method: 200.8 - Metals (ICP/MS)

Analyte	Result	Qualifier	RL	Unit	D	Prepared	Analyzed	Dil Fac
Lead	0.94		0.50	ppb		03/22/17 07:28	03/25/17 09:24	1

Client Sample ID: Building CC Room 210 Fountain

Lab Sample ID: 550-79402-6

Date Collected: 03/14/17 09:01

Matrix: Drinking Water

Date Received: 03/16/17 16:15

Method: 200.8 - Metals (ICP/MS)

Analyte	Result	Qualifier	RL	Unit	D	Prepared	Analyzed	Dil Fac
Lead	58		0.50	ppb		03/22/17 07:28	03/25/17 09:26	1

Client Sample ID: Building CC Room 210 Faucet

Lab Sample ID: 550-79402-7

Date Collected: 03/14/17 09:01

Matrix: Drinking Water

Date Received: 03/16/17 16:15

Method: 200.8 - Metals (ICP/MS)

Analyte	Result	Qualifier	RL	Unit	D	Prepared	Analyzed	Dil Fac
Lead	69		0.50	ppb		03/22/17 07:28	03/25/17 09:28	1

TestAmerica Phoenix

Client Sample Results

Client: Arizona Dept of Environmental Quality
Project/Site: Pb in DW/Creighton School District

TestAmerica Job ID: 550-79402-1
SDG: Creighton School Confirmation Sampling

Client Sample ID: Building CC Room 213 Faucet

Lab Sample ID: 550-79402-8

Date Collected: 03/14/17 09:04

Matrix: Drinking Water

Date Received: 03/16/17 16:15

Method: 200.8 - Metals (ICP/MS)

Analyte	Result	Qualifier	RL	Unit	D	Prepared	Analyzed	Dil Fac
Lead	5.2		0.50	ppb		03/22/17 07:28	03/25/17 09:30	1

Client Sample ID: Building CC Room 213 Fountain

Lab Sample ID: 550-79402-9

Date Collected: 03/14/17 09:04

Matrix: Drinking Water

Date Received: 03/16/17 16:15

Method: 200.8 - Metals (ICP/MS)

Analyte	Result	Qualifier	RL	Unit	D	Prepared	Analyzed	Dil Fac
Lead	1.6		0.50	ppb		03/22/17 07:28	03/25/17 09:32	1

Client Sample ID: Building CC Room 212 Faucet

Lab Sample ID: 550-79402-10

Date Collected: 03/14/17 09:06

Matrix: Drinking Water

Date Received: 03/16/17 16:15

Method: 200.8 - Metals (ICP/MS)

Analyte	Result	Qualifier	RL	Unit	D	Prepared	Analyzed	Dil Fac
Lead	1.8		0.50	ppb		03/22/17 07:28	03/25/17 09:37	1

Client Sample ID: Building CC Room 212 Fountain

Lab Sample ID: 550-79402-11

Date Collected: 03/14/17 09:06

Matrix: Drinking Water

Date Received: 03/16/17 16:15

Method: 200.8 - Metals (ICP/MS)

Analyte	Result	Qualifier	RL	Unit	D	Prepared	Analyzed	Dil Fac
Lead	2.4		0.50	ppb		03/22/17 07:28	03/25/17 09:39	1

Client Sample ID: Building CC South Side Fountains East

Lab Sample ID: 550-79402-12

Date Collected: 03/14/17 09:11

Matrix: Drinking Water

Date Received: 03/16/17 16:15

Method: 200.8 - Metals (ICP/MS)

Analyte	Result	Qualifier	RL	Unit	D	Prepared	Analyzed	Dil Fac
Lead	370		0.50	ppb		03/22/17 07:28	03/25/17 09:41	1

Client Sample ID: Building CC 214 Fountain

Lab Sample ID: 550-79402-13

Date Collected: 03/14/17 09:29

Matrix: Drinking Water

Date Received: 03/16/17 16:15

Method: 200.8 - Metals (ICP/MS)

Analyte	Result	Qualifier	RL	Unit	D	Prepared	Analyzed	Dil Fac
Lead	0.80		0.50	ppb		03/22/17 07:28	03/25/17 09:43	1

Client Sample ID: Building CC 214 Faucet Sink

Lab Sample ID: 550-79402-14

Date Collected: 03/14/17 09:29

Matrix: Drinking Water

Date Received: 03/16/17 16:15

Method: 200.8 - Metals (ICP/MS)

Analyte	Result	Qualifier	RL	Unit	D	Prepared	Analyzed	Dil Fac
Lead	3.7		0.50	ppb		03/22/17 07:28	03/25/17 09:45	1

TestAmerica Phoenix

Client Sample Results

Client: Arizona Dept of Environmental Quality
Project/Site: Pb in DW/Creighton School District

TestAmerica Job ID: 550-79402-1
SDG: Creighton School Confirmation Sampling

Client Sample ID: Building CC 214 Restroom Sink

Lab Sample ID: 550-79402-15

Date Collected: 03/14/17 09:32

Matrix: Drinking Water

Date Received: 03/16/17 16:15

Method: 200.8 - Metals (ICP/MS)

Analyte	Result	Qualifier	RL	Unit	D	Prepared	Analyzed	Dil Fac
Lead	1.7		0.50	ppb		03/22/17 07:28	03/25/17 09:47	1

Client Sample ID: Building CC 215 Faucet

Lab Sample ID: 550-79402-16

Date Collected: 03/14/17 09:34

Matrix: Drinking Water

Date Received: 03/16/17 16:15

Method: 200.8 - Metals (ICP/MS)

Analyte	Result	Qualifier	RL	Unit	D	Prepared	Analyzed	Dil Fac
Lead	20		0.50	ppb		03/22/17 07:28	03/25/17 09:49	1

Client Sample ID: Building CC 215 Fountain

Lab Sample ID: 550-79402-17

Date Collected: 03/14/17 09:34

Matrix: Drinking Water

Date Received: 03/16/17 16:15

Method: 200.8 - Metals (ICP/MS)

Analyte	Result	Qualifier	RL	Unit	D	Prepared	Analyzed	Dil Fac
Lead	1.3		0.50	ppb		03/22/17 07:28	03/25/17 09:51	1

Client Sample ID: Building CC 216 Faucet

Lab Sample ID: 550-79402-18

Date Collected: 03/14/17 09:37

Matrix: Drinking Water

Date Received: 03/16/17 16:15

Method: 200.8 - Metals (ICP/MS)

Analyte	Result	Qualifier	RL	Unit	D	Prepared	Analyzed	Dil Fac
Lead	1.6		0.50	ppb		03/22/17 07:28	03/25/17 09:53	1

Client Sample ID: Building CC 216 Fountain

Lab Sample ID: 550-79402-19

Date Collected: 03/14/17 09:37

Matrix: Drinking Water

Date Received: 03/16/17 16:15

Method: 200.8 - Metals (ICP/MS)

Analyte	Result	Qualifier	RL	Unit	D	Prepared	Analyzed	Dil Fac
Lead	0.87		0.50	ppb		03/22/17 07:28	03/25/17 09:54	1

Client Sample ID: Building CC Library Office Sink 1

Lab Sample ID: 550-79402-20

Date Collected: 03/15/17 08:59

Matrix: Drinking Water

Date Received: 03/16/17 16:15

Method: 200.8 - Metals (ICP/MS)

Analyte	Result	Qualifier	RL	Unit	D	Prepared	Analyzed	Dil Fac
Lead	42		0.50	ppb		04/04/17 06:40	04/04/17 13:14	1

Client Sample ID: Building CC Library Office Sink 2

Lab Sample ID: 550-79402-21

Date Collected: 03/15/17 09:00

Matrix: Drinking Water

Date Received: 03/16/17 16:15

Method: 200.8 - Metals (ICP/MS)

Analyte	Result	Qualifier	RL	Unit	D	Prepared	Analyzed	Dil Fac
Lead	4.7		0.50	ppb		04/04/17 06:40	04/04/17 13:16	1

TestAmerica Phoenix

Client Sample Results

Client: Arizona Dept of Environmental Quality
Project/Site: Pb in DW/Creighton School District

TestAmerica Job ID: 550-79402-1
SDG: Creighton School Confirmation Sampling

Client Sample ID: Building CC Library Office Sink 3

Lab Sample ID: 550-79402-22

Date Collected: 03/15/17 09:01

Matrix: Drinking Water

Date Received: 03/16/17 16:15

Method: 200.8 - Metals (ICP/MS)

Analyte	Result	Qualifier	RL	Unit	D	Prepared	Analyzed	Dil Fac
Lead	5.9		0.50	ppb		04/04/17 06:40	04/04/17 13:18	1

Client Sample ID: Building CC Library Office Sink 4

Lab Sample ID: 550-79402-23

Date Collected: 03/15/17 09:02

Matrix: Drinking Water

Date Received: 03/16/17 16:15

Method: 200.8 - Metals (ICP/MS)

Analyte	Result	Qualifier	RL	Unit	D	Prepared	Analyzed	Dil Fac
Lead	5.2		0.50	ppb		04/04/17 06:40	04/04/17 13:20	1

Client Sample ID: Building CC Library Office Sink Source

Lab Sample ID: 550-79402-24

Date Collected: 03/15/17 09:03

Matrix: Drinking Water

Date Received: 03/16/17 16:15

Method: 200.8 - Metals (ICP/MS)

Analyte	Result	Qualifier	RL	Unit	D	Prepared	Analyzed	Dil Fac
Lead	2700	D2	50	ppb		04/04/17 06:40	04/05/17 08:48	100

Client Sample ID: Building J East Side Hose BIB 1 ID

Lab Sample ID: 550-79402-25

Date Collected: 03/14/17 08:07

Matrix: Drinking Water

Date Received: 03/16/17 16:15

Method: 200.8 - Metals (ICP/MS)

Analyte	Result	Qualifier	RL	Unit	D	Prepared	Analyzed	Dil Fac
Lead	9.7		0.50	ppb		04/04/17 06:40	04/04/17 13:24	1

Client Sample ID: Building J East Side Hose BIB 2 Flush

Lab Sample ID: 550-79402-26

Date Collected: 03/14/17 08:10

Matrix: Drinking Water

Date Received: 03/16/17 16:15

Method: 200.8 - Metals (ICP/MS)

Analyte	Result	Qualifier	RL	Unit	D	Prepared	Analyzed	Dil Fac
Lead	39		0.50	ppb		04/04/17 06:40	04/04/17 13:30	1

Client Sample ID: Building J East Side Hose BIB 1 D-2

Lab Sample ID: 550-79402-27

Date Collected: 03/15/17 08:41

Matrix: Drinking Water

Date Received: 03/16/17 16:15

Method: 200.8 - Metals (ICP/MS)

Analyte	Result	Qualifier	RL	Unit	D	Prepared	Analyzed	Dil Fac
Lead	22		0.50	ppb		04/04/17 06:40	04/04/17 13:32	1

Client Sample ID: Building J East Side Hose BIB 2 D-2

Lab Sample ID: 550-79402-28

Date Collected: 03/15/17 08:42

Matrix: Drinking Water

Date Received: 03/16/17 16:15

Method: 200.8 - Metals (ICP/MS)

Analyte	Result	Qualifier	RL	Unit	D	Prepared	Analyzed	Dil Fac
Lead	12		0.50	ppb		04/04/17 06:40	04/04/17 13:34	1

TestAmerica Phoenix

Client Sample Results

Client: Arizona Dept of Environmental Quality
Project/Site: Pb in DW/Creighton School District

TestAmerica Job ID: 550-79402-1
SDG: Creighton School Confirmation Sampling

Client Sample ID: Building J East Side Hose BIB 3 D-2

Lab Sample ID: 550-79402-29

Date Collected: 03/15/17 08:43

Matrix: Drinking Water

Date Received: 03/16/17 16:15

Method: 200.8 - Metals (ICP/MS)

Analyte	Result	Qualifier	RL	Unit	D	Prepared	Analyzed	Dil Fac
Lead	16		0.50	ppb		04/04/17 06:40	04/04/17 13:36	1

Client Sample ID: Building J East Side Hose BIB 4 D-2

Lab Sample ID: 550-79402-30

Date Collected: 03/15/17 08:43

Matrix: Drinking Water

Date Received: 03/16/17 16:15

Method: 200.8 - Metals (ICP/MS)

Analyte	Result	Qualifier	RL	Unit	D	Prepared	Analyzed	Dil Fac
Lead	29		0.50	ppb		04/04/17 06:40	04/04/17 13:38	1

Client Sample ID: Building J East Side Hose BIB Source

Lab Sample ID: 550-79402-31

Date Collected: 03/15/17 08:44

Matrix: Drinking Water

Date Received: 03/16/17 16:15

Method: 200.8 - Metals (ICP/MS)

Analyte	Result	Qualifier	RL	Unit	D	Prepared	Analyzed	Dil Fac
Lead	9.9		0.50	ppb		04/04/17 06:40	04/04/17 13:39	1

Client Sample ID: Building E North Fountains 1

Lab Sample ID: 550-79402-32

Date Collected: 03/14/17 07:40

Matrix: Drinking Water

Date Received: 03/16/17 16:15

Method: 200.8 - Metals (ICP/MS)

Analyte	Result	Qualifier	RL	Unit	D	Prepared	Analyzed	Dil Fac
Lead	ND		0.50	ppb		04/04/17 06:40	04/04/17 13:41	1

Client Sample ID: Building E North Fountains 2

Lab Sample ID: 550-79402-33

Date Collected: 03/14/17 07:40

Matrix: Drinking Water

Date Received: 03/16/17 16:15

Method: 200.8 - Metals (ICP/MS)

Analyte	Result	Qualifier	RL	Unit	D	Prepared	Analyzed	Dil Fac
Lead	ND		0.50	ppb		04/04/17 06:40	04/04/17 13:09	1

Client Sample ID: Building E North Fountains 3

Lab Sample ID: 550-79402-34

Date Collected: 03/14/17 07:40

Matrix: Drinking Water

Date Received: 03/16/17 16:15

Method: 200.8 - Metals (ICP/MS)

Analyte	Result	Qualifier	RL	Unit	D	Prepared	Analyzed	Dil Fac
Lead	2.0		0.50	ppb		04/04/17 06:40	04/04/17 13:47	1

Client Sample ID: Building E North Fountains 4

Lab Sample ID: 550-79402-35

Date Collected: 03/14/17 07:40

Matrix: Drinking Water

Date Received: 03/16/17 16:15

Method: 200.8 - Metals (ICP/MS)

Analyte	Result	Qualifier	RL	Unit	D	Prepared	Analyzed	Dil Fac
Lead	1.9		0.50	ppb		04/04/17 06:40	04/04/17 13:49	1

TestAmerica Phoenix

Client Sample Results

Client: Arizona Dept of Environmental Quality
Project/Site: Pb in DW/Creighton School District

TestAmerica Job ID: 550-79402-1
SDG: Creighton School Confirmation Sampling

Client Sample ID: Building E West Fountains 1 ID 1

Lab Sample ID: 550-79402-36

Date Collected: 03/14/17 07:46

Matrix: Drinking Water

Date Received: 03/16/17 16:15

Method: 200.8 - Metals (ICP/MS)

Analyte	Result	Qualifier	RL	Unit	D	Prepared	Analyzed	Dil Fac
Lead	110		0.50	ppb		04/04/17 06:40	04/04/17 13:51	1

Client Sample ID: Building E West Fountains West # 2

Lab Sample ID: 550-79402-37

Date Collected: 03/14/17 07:46

Matrix: Drinking Water

Date Received: 03/16/17 16:15

Method: 200.8 - Metals (ICP/MS)

Analyte	Result	Qualifier	RL	Unit	D	Prepared	Analyzed	Dil Fac
Lead	1300	D2	5.0	ppb		03/25/17 15:09	04/04/17 13:59	10

Client Sample ID: Building E West Fountains 1 ID flush

Lab Sample ID: 550-79402-38

Date Collected: 03/14/17 07:48

Matrix: Drinking Water

Date Received: 03/16/17 16:15

Method: 200.8 - Metals (ICP/MS)

Analyte	Result	Qualifier	RL	Unit	D	Prepared	Analyzed	Dil Fac
Lead	2.4		0.50	ppb		04/04/17 06:40	04/04/17 13:53	1

Client Sample ID: Building E West Fountains D-2

Lab Sample ID: 550-79402-39

Date Collected: 03/15/17 08:16

Matrix: Drinking Water

Date Received: 03/16/17 16:15

Method: 200.8 - Metals (ICP/MS)

Analyte	Result	Qualifier	RL	Unit	D	Prepared	Analyzed	Dil Fac
Lead	1400	D2	50	ppb		03/25/17 15:09	04/05/17 08:46	100

Client Sample ID: Building E West Fountains D-2

Lab Sample ID: 550-79402-40

Date Collected: 03/15/17 08:18

Matrix: Drinking Water

Date Received: 03/16/17 16:15

Method: 200.8 - Metals (ICP/MS)

Analyte	Result	Qualifier	RL	Unit	D	Prepared	Analyzed	Dil Fac
Lead	120		0.50	ppb		04/04/17 06:40	04/04/17 13:55	1

Client Sample ID: Building E West Fountains D-2

Lab Sample ID: 550-79402-41

Date Collected: 03/15/17 08:19

Matrix: Drinking Water

Date Received: 03/16/17 16:15

Method: 200.8 - Metals (ICP/MS)

Analyte	Result	Qualifier	RL	Unit	D	Prepared	Analyzed	Dil Fac
Lead	35		0.50	ppb		04/04/17 06:40	04/04/17 13:57	1

Client Sample ID: Building E West Fountains D-2

Lab Sample ID: 550-79402-42

Date Collected: 03/15/17 08:20

Matrix: Drinking Water

Date Received: 03/16/17 16:15

Method: 200.8 - Metals (ICP/MS)

Analyte	Result	Qualifier	RL	Unit	D	Prepared	Analyzed	Dil Fac
Lead	23		0.50	ppb		03/22/17 07:41	03/25/17 10:09	1

TestAmerica Phoenix

Client Sample Results

Client: Arizona Dept of Environmental Quality
Project/Site: Pb in DW/Creighton School District

TestAmerica Job ID: 550-79402-1
SDG: Creighton School Confirmation Sampling

Client Sample ID: Building E West Fountains Source

Lab Sample ID: 550-79402-43

Date Collected: 03/15/17 08:21

Matrix: Drinking Water

Date Received: 03/16/17 16:15

Method: 200.8 - Metals (ICP/MS)

Analyte	Result	Qualifier	RL	Unit	D	Prepared	Analyzed	Dil Fac
Lead	29		0.50	ppb		03/22/17 07:41	03/25/17 10:15	1

Client Sample ID: Building F East Side Fountains 1

Lab Sample ID: 550-79402-44

Date Collected: 03/14/17 07:58

Matrix: Drinking Water

Date Received: 03/16/17 16:15

Method: 200.8 - Metals (ICP/MS)

Analyte	Result	Qualifier	RL	Unit	D	Prepared	Analyzed	Dil Fac
Lead	25		0.50	ppb		03/22/17 07:41	03/25/17 10:17	1

Client Sample ID: Building F East Side Fountains 2 ID 1

Lab Sample ID: 550-79402-45

Date Collected: 03/14/17 07:58

Matrix: Drinking Water

Date Received: 03/16/17 16:15

Method: 200.8 - Metals (ICP/MS)

Analyte	Result	Qualifier	RL	Unit	D	Prepared	Analyzed	Dil Fac
Lead	39		0.50	ppb		03/22/17 07:41	03/25/17 10:19	1

Client Sample ID: Building F East Side Fountains 2 ID Flush

Lab Sample ID: 550-79402-46

Date Collected: 03/14/17 08:00

Matrix: Drinking Water

Date Received: 03/16/17 16:15

Method: 200.8 - Metals (ICP/MS)

Analyte	Result	Qualifier	RL	Unit	D	Prepared	Analyzed	Dil Fac
Lead	15		0.50	ppb		03/22/17 07:41	03/25/17 10:21	1

Client Sample ID: Building F East Side Fountains 1

Lab Sample ID: 550-79402-47

Date Collected: 03/15/17 08:30

Matrix: Drinking Water

Date Received: 03/16/17 16:15

Method: 200.8 - Metals (ICP/MS)

Analyte	Result	Qualifier	RL	Unit	D	Prepared	Analyzed	Dil Fac
Lead	23		0.50	ppb		03/22/17 07:41	03/25/17 10:23	1

Client Sample ID: Building F East Side Fountains 2

Lab Sample ID: 550-79402-48

Date Collected: 03/15/17 08:32

Matrix: Drinking Water

Date Received: 03/16/17 16:15

Method: 200.8 - Metals (ICP/MS)

Analyte	Result	Qualifier	RL	Unit	D	Prepared	Analyzed	Dil Fac
Lead	16		0.50	ppb		03/22/17 07:41	03/25/17 10:25	1

Client Sample ID: Building F East Side Fountains 3

Lab Sample ID: 550-79402-49

Date Collected: 03/15/17 08:33

Matrix: Drinking Water

Date Received: 03/16/17 16:15

Method: 200.8 - Metals (ICP/MS)

Analyte	Result	Qualifier	RL	Unit	D	Prepared	Analyzed	Dil Fac
Lead	29		0.50	ppb		03/22/17 07:41	03/25/17 10:27	1

TestAmerica Phoenix

Client Sample Results

Client: Arizona Dept of Environmental Quality
Project/Site: Pb in DW/Creighton School District

TestAmerica Job ID: 550-79402-1
SDG: Creighton School Confirmation Sampling

Client Sample ID: Building F East Side Fountains 4

Lab Sample ID: 550-79402-50

Date Collected: 03/15/17 08:34

Matrix: Drinking Water

Date Received: 03/16/17 16:15

Method: 200.8 - Metals (ICP/MS)

Analyte	Result	Qualifier	RL	Unit	D	Prepared	Analyzed	Dil Fac
Lead	18		0.50	ppb		03/22/17 07:41	03/25/17 10:29	1

Client Sample ID: Building F East Side Fountains Source

Lab Sample ID: 550-79402-51

Date Collected: 03/15/17 08:35

Matrix: Drinking Water

Date Received: 03/16/17 16:15

Method: 200.8 - Metals (ICP/MS)

Analyte	Result	Qualifier	RL	Unit	D	Prepared	Analyzed	Dil Fac
Lead	130		0.50	ppb		03/22/17 07:41	03/25/17 10:30	1

Client Sample ID: Building K 800 Womens Restroom East

Lab Sample ID: 550-79402-52

Date Collected: 03/14/17 08:15

Matrix: Drinking Water

Date Received: 03/16/17 16:15

Method: 200.8 - Metals (ICP/MS)

Analyte	Result	Qualifier	RL	Unit	D	Prepared	Analyzed	Dil Fac
Lead	36		0.50	ppb		03/22/17 07:41	03/25/17 10:36	1

Client Sample ID: Building K 800 Womens Restroom West

Lab Sample ID: 550-79402-53

Date Collected: 03/14/17 08:16

Matrix: Drinking Water

Date Received: 03/16/17 16:15

Method: 200.8 - Metals (ICP/MS)

Analyte	Result	Qualifier	RL	Unit	D	Prepared	Analyzed	Dil Fac
Lead	37		0.50	ppb		03/22/17 07:41	03/25/17 10:38	1

Client Sample ID: Building K Fountains North 1

Lab Sample ID: 550-79402-54

Date Collected: 03/14/17 08:16

Matrix: Drinking Water

Date Received: 03/16/17 16:15

Method: 200.8 - Metals (ICP/MS)

Analyte	Result	Qualifier	RL	Unit	D	Prepared	Analyzed	Dil Fac
Lead	1.8		0.50	ppb		03/22/17 07:41	03/25/17 10:40	1

Client Sample ID: Building K Fountains North 2

Lab Sample ID: 550-79402-55

Date Collected: 03/14/17 08:17

Matrix: Drinking Water

Date Received: 03/16/17 16:15

Method: 200.8 - Metals (ICP/MS)

Analyte	Result	Qualifier	RL	Unit	D	Prepared	Analyzed	Dil Fac
Lead	2.0		0.50	ppb		03/22/17 07:41	03/25/17 10:42	1

Client Sample ID: Building K Room 804 faucet

Lab Sample ID: 550-79402-56

Date Collected: 03/14/17 08:20

Matrix: Drinking Water

Date Received: 03/16/17 16:15

Method: 200.8 - Metals (ICP/MS)

Analyte	Result	Qualifier	RL	Unit	D	Prepared	Analyzed	Dil Fac
Lead	15		0.50	ppb		03/22/17 07:41	03/25/17 10:44	1

TestAmerica Phoenix

Client Sample Results

Client: Arizona Dept of Environmental Quality
Project/Site: Pb in DW/Creighton School District

TestAmerica Job ID: 550-79402-1
SDG: Creighton School Confirmation Sampling

Client Sample ID: Building K Room 803 faucet

Lab Sample ID: 550-79402-57

Date Collected: 03/14/17 08:20

Matrix: Drinking Water

Date Received: 03/16/17 16:15

Method: 200.8 - Metals (ICP/MS)

Analyte	Result	Qualifier	RL	Unit	D	Prepared	Analyzed	Dil Fac
Lead	8.7		0.50	ppb		03/22/17 07:41	03/25/17 10:46	1

Client Sample ID: Building K 800 Mens Restroom West

Lab Sample ID: 550-79402-58

Date Collected: 03/14/17 08:24

Matrix: Drinking Water

Date Received: 03/16/17 16:15

Method: 200.8 - Metals (ICP/MS)

Analyte	Result	Qualifier	RL	Unit	D	Prepared	Analyzed	Dil Fac
Lead	5.6		0.50	ppb		03/22/17 07:41	03/25/17 10:47	1

Client Sample ID: Building K Room 802 Sink ID1

Lab Sample ID: 550-79402-59

Date Collected: 03/14/17 08:34

Matrix: Drinking Water

Date Received: 03/16/17 16:15

Method: 200.8 - Metals (ICP/MS)

Analyte	Result	Qualifier	RL	Unit	D	Prepared	Analyzed	Dil Fac
Lead	34		0.50	ppb		03/22/17 07:41	03/25/17 10:49	1

Client Sample ID: Building K Room 802 Sink Flush

Lab Sample ID: 550-79402-60

Date Collected: 03/14/17 08:35

Matrix: Drinking Water

Date Received: 03/16/17 16:15

Method: 200.8 - Metals (ICP/MS)

Analyte	Result	Qualifier	RL	Unit	D	Prepared	Analyzed	Dil Fac
Lead	6.5		0.50	ppb		03/22/17 07:41	03/25/17 10:51	1

Client Sample ID: Building K Room 802 Sink 1

Lab Sample ID: 550-79402-61

Date Collected: 03/15/17 08:52

Matrix: Drinking Water

Date Received: 03/16/17 16:15

Method: 200.8 - Metals (ICP/MS)

Analyte	Result	Qualifier	RL	Unit	D	Prepared	Analyzed	Dil Fac
Lead	20		0.50	ppb		03/22/17 07:41	03/25/17 10:53	1

Client Sample ID: Building K Room 802 Sink 2

Lab Sample ID: 550-79402-62

Date Collected: 03/15/17 08:50

Matrix: Drinking Water

Date Received: 03/16/17 16:15

Method: 200.8 - Metals (ICP/MS)

Analyte	Result	Qualifier	RL	Unit	D	Prepared	Analyzed	Dil Fac
Lead	18		0.50	ppb		03/25/17 15:09	03/30/17 18:39	1

Client Sample ID: Building K Room 802 Sink 3

Lab Sample ID: 550-79402-63

Date Collected: 03/15/17 08:51

Matrix: Drinking Water

Date Received: 03/16/17 16:15

Method: 200.8 - Metals (ICP/MS)

Analyte	Result	Qualifier	RL	Unit	D	Prepared	Analyzed	Dil Fac
Lead	20		0.50	ppb		03/25/17 15:09	03/30/17 19:04	1

TestAmerica Phoenix

Client Sample Results

Client: Arizona Dept of Environmental Quality
Project/Site: Pb in DW/Creighton School District

TestAmerica Job ID: 550-79402-1
SDG: Creighton School Confirmation Sampling

Client Sample ID: Building K Room 802 Sink 4

Lab Sample ID: 550-79402-64

Date Collected: 03/15/17 08:53

Matrix: Drinking Water

Date Received: 03/16/17 16:15

Method: 200.8 - Metals (ICP/MS)

Analyte	Result	Qualifier	RL	Unit	D	Prepared	Analyzed	Dil Fac
Lead	25		0.50	ppb		03/25/17 15:09	03/30/17 18:47	1

Client Sample ID: Building K Room 802 Source

Lab Sample ID: 550-79402-65

Date Collected: 03/15/17 08:54

Matrix: Drinking Water

Date Received: 03/16/17 16:15

Method: 200.8 - Metals (ICP/MS)

Analyte	Result	Qualifier	RL	Unit	D	Prepared	Analyzed	Dil Fac
Lead	64		0.50	ppb		03/25/17 15:09	03/30/17 18:52	1

QC Sample Results

Client: Arizona Dept of Environmental Quality
Project/Site: Pb in DW/Creighton School District

TestAmerica Job ID: 550-79402-1
SDG: Creighton School Confirmation Sampling

Method: 200.8 - Metals (ICP/MS)

Lab Sample ID: MB 550-112933/1-A
Matrix: Water
Analysis Batch: 113239

Client Sample ID: Method Blank
Prep Type: Total/NA
Prep Batch: 112933

Analyte	MB Result	MB Qualifier	RL	Unit	D	Prepared	Analyzed	Dil Fac
Lead	ND		0.50	ppb		03/22/17 07:28	03/25/17 09:02	1

Lab Sample ID: LCS 550-112933/4-A
Matrix: Water
Analysis Batch: 113239

Client Sample ID: Lab Control Sample
Prep Type: Total/NA
Prep Batch: 112933

Analyte	Spike Added	LCS Result	LCS Qualifier	Unit	D	%Rec	%Rec. Limits
Lead	100	94.6		ppb		95	85 - 115

Lab Sample ID: LCSD 550-112933/5-A
Matrix: Water
Analysis Batch: 113239

Client Sample ID: Lab Control Sample Dup
Prep Type: Total/NA
Prep Batch: 112933

Analyte	Spike Added	LCSD Result	LCSD Qualifier	Unit	D	%Rec	%Rec. Limits	RPD	Limit
Lead	100	96.3		ppb		96	85 - 115	2	20

Lab Sample ID: 550-79266-A-16-B MS
Matrix: Water
Analysis Batch: 113239

Client Sample ID: Matrix Spike
Prep Type: Total/NA
Prep Batch: 112933

Analyte	Sample Result	Sample Qualifier	Spike Added	MS Result	MS Qualifier	Unit	D	%Rec	%Rec. Limits
Lead	15		100	103		ppb		88	70 - 130

Lab Sample ID: 550-79266-A-16-C MSD
Matrix: Water
Analysis Batch: 113239

Client Sample ID: Matrix Spike Duplicate
Prep Type: Total/NA
Prep Batch: 112933

Analyte	Sample Result	Sample Qualifier	Spike Added	MSD Result	MSD Qualifier	Unit	D	%Rec	%Rec. Limits	RPD	Limit
Lead	15		100	101		ppb		86	70 - 130	2	20

Lab Sample ID: MB 550-112936/1-A
Matrix: Water
Analysis Batch: 113240

Client Sample ID: Method Blank
Prep Type: Total/NA
Prep Batch: 112936

Analyte	MB Result	MB Qualifier	RL	Unit	D	Prepared	Analyzed	Dil Fac
Lead	ND		0.50	ppb		03/22/17 07:41	03/25/17 10:00	1

Lab Sample ID: LCS 550-112936/4-A
Matrix: Water
Analysis Batch: 113240

Client Sample ID: Lab Control Sample
Prep Type: Total/NA
Prep Batch: 112936

Analyte	Spike Added	LCS Result	LCS Qualifier	Unit	D	%Rec	%Rec. Limits
Lead	100	98.7		ppb		99	85 - 115

Lab Sample ID: LCSD 550-112936/5-A
Matrix: Water
Analysis Batch: 113240

Client Sample ID: Lab Control Sample Dup
Prep Type: Total/NA
Prep Batch: 112936

Analyte	Spike Added	LCSD Result	LCSD Qualifier	Unit	D	%Rec	%Rec. Limits	RPD	Limit
Lead	100	97.7		ppb		98	85 - 115	1	20

TestAmerica Phoenix

QC Sample Results

Client: Arizona Dept of Environmental Quality
Project/Site: Pb in DW/Creighton School District

TestAmerica Job ID: 550-79402-1
SDG: Creighton School Confirmation Sampling

Lab Sample ID: 550-79402-42 MS
Matrix: Drinking Water
Analysis Batch: 113240

Client Sample ID: Building E West Fountains D-2
Prep Type: Total/NA
Prep Batch: 112936

Analyte	Sample Result	Sample Qualifier	Spike Added	MS Result	MS Qualifier	Unit	D	%Rec	%Rec. Limits
Lead	23		100	117		ppb		94	70 - 130

Lab Sample ID: 550-79402-42 MSD
Matrix: Drinking Water
Analysis Batch: 113240

Client Sample ID: Building E West Fountains D-2
Prep Type: Total/NA
Prep Batch: 112936

Analyte	Sample Result	Sample Qualifier	Spike Added	MSD Result	MSD Qualifier	Unit	D	%Rec	%Rec. Limits	RPD	RPD Limit
Lead	23		100	113		ppb		90	70 - 130	4	20

Lab Sample ID: MB 550-113253/1-A
Matrix: Water
Analysis Batch: 113734

Client Sample ID: Method Blank
Prep Type: Total/NA
Prep Batch: 113253

Analyte	MB Result	MB Qualifier	RL	Unit	D	Prepared	Analyzed	Dil Fac
Lead	ND		0.50	ppb		03/25/17 15:09	03/30/17 18:20	1

Lab Sample ID: LCS 550-113253/4-A
Matrix: Water
Analysis Batch: 113734

Client Sample ID: Lab Control Sample
Prep Type: Total/NA
Prep Batch: 113253

Analyte	Spike Added	LCS Result	LCS Qualifier	Unit	D	%Rec	%Rec. Limits
Lead	100	98.6		ppb		99	85 - 115

Lab Sample ID: LCSD 550-113253/5-A
Matrix: Water
Analysis Batch: 113734

Client Sample ID: Lab Control Sample Dup
Prep Type: Total/NA
Prep Batch: 113253

Analyte	Spike Added	LCSD Result	LCSD Qualifier	Unit	D	%Rec	%Rec. Limits	RPD	RPD Limit
Lead	100	97.9		ppb		98	85 - 115	1	20

Lab Sample ID: 550-79583-A-2-C MS
Matrix: Water
Analysis Batch: 113734

Client Sample ID: Matrix Spike
Prep Type: Total/NA
Prep Batch: 113253

Analyte	Sample Result	Sample Qualifier	Spike Added	MS Result	MS Qualifier	Unit	D	%Rec	%Rec. Limits
Lead	ND		100	90.5		ppb		91	70 - 130

Lab Sample ID: 550-79583-A-2-D MSD
Matrix: Water
Analysis Batch: 113734

Client Sample ID: Matrix Spike Duplicate
Prep Type: Total/NA
Prep Batch: 113253

Analyte	Sample Result	Sample Qualifier	Spike Added	MSD Result	MSD Qualifier	Unit	D	%Rec	%Rec. Limits	RPD	RPD Limit
Lead	ND		100	89.9		ppb		90	70 - 130	1	20

Lab Sample ID: MB 550-113917/1-A
Matrix: Water
Analysis Batch: 113998

Client Sample ID: Method Blank
Prep Type: Total/NA
Prep Batch: 113917

Analyte	MB Result	MB Qualifier	RL	Unit	D	Prepared	Analyzed	Dil Fac
Lead	ND		0.50	ppb		04/04/17 06:40	04/04/17 13:01	1

TestAmerica Phoenix

QC Sample Results

Client: Arizona Dept of Environmental Quality
Project/Site: Pb in DW/Creighton School District

TestAmerica Job ID: 550-79402-1
SDG: Creighton School Confirmation Sampling

Method: 200.8 - Metals (ICP/MS) (Continued)

Lab Sample ID: LCS 550-113917/3-A

Matrix: Water

Analysis Batch: 113998

Client Sample ID: Lab Control Sample

Prep Type: Total/NA

Prep Batch: 113917

Analyte	Spike Added	LCS Result	LCS Qualifier	Unit	D	%Rec	%Rec. Limits
Lead	100	92.2		ppb		92	85 - 115

Lab Sample ID: LCSD 550-113917/4-A

Matrix: Water

Analysis Batch: 113998

Client Sample ID: Lab Control Sample Dup

Prep Type: Total/NA

Prep Batch: 113917

Analyte	Spike Added	LCSD Result	LCSD Qualifier	Unit	D	%Rec	%Rec. Limits	RPD	RPD Limit
Lead	100	90.5		ppb		90	85 - 115	2	20

Lab Sample ID: 550-79402-33 MS

Matrix: Drinking Water

Analysis Batch: 113998

Client Sample ID: Building E North Fountains 2

Prep Type: Total/NA

Prep Batch: 113917

Analyte	Sample Result	Sample Qualifier	Spike Added	MS Result	MS Qualifier	Unit	D	%Rec	%Rec. Limits
Lead	ND		100	89.2		ppb		89	70 - 130

Lab Sample ID: 550-79402-33 MSD

Matrix: Drinking Water

Analysis Batch: 113998

Client Sample ID: Building E North Fountains 2

Prep Type: Total/NA

Prep Batch: 113917

Analyte	Sample Result	Sample Qualifier	Spike Added	MSD Result	MSD Qualifier	Unit	D	%Rec	%Rec. Limits	RPD	RPD Limit
Lead	ND		100	90.5		ppb		90	70 - 130	1	20

QC Association Summary

Client: Arizona Dept of Environmental Quality
Project/Site: Pb in DW/Creighton School District

TestAmerica Job ID: 550-79402-1
SDG: Creighton School Confirmation Sampling

Metals

Prep Batch: 112933

Lab Sample ID	Client Sample ID	Prep Type	Matrix	Method	Prep Batch
550-79402-1	Building CC Library Office Sink ID-1	Total/NA	Drinking Water	200.8	
550-79402-2	Building CC Library Office Sink flush	Total/NA	Drinking Water	200.8	
550-79402-3	Building CC Room 203 Sink	Total/NA	Drinking Water	200.8	
550-79402-4	Building CC Room 211 Faucet	Total/NA	Drinking Water	200.8	
550-79402-5	Building CC Room 211 Drinking Fountain	Total/NA	Drinking Water	200.8	
550-79402-6	Building CC Room 210 Fountain	Total/NA	Drinking Water	200.8	
550-79402-7	Building CC Room 210 Faucet	Total/NA	Drinking Water	200.8	
550-79402-8	Building CC Room 213 Faucet	Total/NA	Drinking Water	200.8	
550-79402-9	Building CC Room 213 Fountain	Total/NA	Drinking Water	200.8	
550-79402-10	Building CC Room 212 Faucet	Total/NA	Drinking Water	200.8	
550-79402-11	Building CC Room 212 Fountain	Total/NA	Drinking Water	200.8	
550-79402-12	Building CC South Side Fountains East	Total/NA	Drinking Water	200.8	
550-79402-13	Building CC 214 Fountain	Total/NA	Drinking Water	200.8	
550-79402-14	Building CC 214 Faucet Sink	Total/NA	Drinking Water	200.8	
550-79402-15	Building CC 214 Restroom Sink	Total/NA	Drinking Water	200.8	
550-79402-16	Building CC 215 Faucet	Total/NA	Drinking Water	200.8	
550-79402-17	Building CC 215 Fountain	Total/NA	Drinking Water	200.8	
550-79402-18	Building CC 216 Faucet	Total/NA	Drinking Water	200.8	
550-79402-19	Building CC 216 Fountain	Total/NA	Drinking Water	200.8	
MB 550-112933/1-A	Method Blank	Total/NA	Water	200.8	
LCS 550-112933/4-A	Lab Control Sample	Total/NA	Water	200.8	
LCSD 550-112933/5-A	Lab Control Sample Dup	Total/NA	Water	200.8	
550-79266-A-16-B MS	Matrix Spike	Total/NA	Water	200.8	
550-79266-A-16-C MSD	Matrix Spike Duplicate	Total/NA	Water	200.8	

Prep Batch: 112936

Lab Sample ID	Client Sample ID	Prep Type	Matrix	Method	Prep Batch
550-79402-42	Building E West Fountains D-2	Total/NA	Drinking Water	200.8	
550-79402-43	Building E West Fountains Source	Total/NA	Drinking Water	200.8	
550-79402-44	Building F East Side Fountains 1	Total/NA	Drinking Water	200.8	
550-79402-45	Building F East Side Fountains 2 ID 1	Total/NA	Drinking Water	200.8	
550-79402-46	Building F East Side Fountains 2 ID Flush	Total/NA	Drinking Water	200.8	
550-79402-47	Building F East Side Fountains 1	Total/NA	Drinking Water	200.8	
550-79402-48	Building F East Side Fountains 2	Total/NA	Drinking Water	200.8	
550-79402-49	Building F East Side Fountains 3	Total/NA	Drinking Water	200.8	
550-79402-50	Building F East Side Fountains 4	Total/NA	Drinking Water	200.8	
550-79402-51	Building F East Side Fountains Source	Total/NA	Drinking Water	200.8	
550-79402-52	Building K 800 Womens Restroom East	Total/NA	Drinking Water	200.8	
550-79402-53	Building K 800 Womens Restroom West	Total/NA	Drinking Water	200.8	
550-79402-54	Building K Fountains North 1	Total/NA	Drinking Water	200.8	
550-79402-55	Building K Fountains North 2	Total/NA	Drinking Water	200.8	
550-79402-56	Building K Room 804 faucet	Total/NA	Drinking Water	200.8	
550-79402-57	Building K Room 803 faucet	Total/NA	Drinking Water	200.8	
550-79402-58	Building K 800 Mens Restroom West	Total/NA	Drinking Water	200.8	
550-79402-59	Building K Room 802 Sink ID1	Total/NA	Drinking Water	200.8	
550-79402-60	Building K Room 802 Sink Flush	Total/NA	Drinking Water	200.8	
550-79402-61	Building K Room 802 Sink 1	Total/NA	Drinking Water	200.8	
MB 550-112936/1-A	Method Blank	Total/NA	Water	200.8	
LCS 550-112936/4-A	Lab Control Sample	Total/NA	Water	200.8	
LCSD 550-112936/5-A	Lab Control Sample Dup	Total/NA	Water	200.8	
550-79402-42 MS	Building E West Fountains D-2	Total/NA	Drinking Water	200.8	

TestAmerica Phoenix

QC Association Summary

Client: Arizona Dept of Environmental Quality
Project/Site: Pb in DW/Creighton School District

TestAmerica Job ID: 550-79402-1
SDG: Creighton School Confirmation Sampling

Metals (Continued)

Prep Batch: 112936 (Continued)

Lab Sample ID	Client Sample ID	Prep Type	Matrix	Method	Prep Batch
550-79402-42 MSD	Building E West Fountains D-2	Total/NA	Drinking Water	200.8	

Analysis Batch: 113239

Lab Sample ID	Client Sample ID	Prep Type	Matrix	Method	Prep Batch
550-79402-1	Building CC Library Office Sink ID-1	Total/NA	Drinking Water	200.8	112933
550-79402-2	Building CC Library Office Sink flush	Total/NA	Drinking Water	200.8	112933
550-79402-3	Building CC Room 203 Sink	Total/NA	Drinking Water	200.8	112933
550-79402-4	Building CC Room 211 Faucet	Total/NA	Drinking Water	200.8	112933
550-79402-5	Building CC Room 211 Drinking Fountain	Total/NA	Drinking Water	200.8	112933
550-79402-6	Building CC Room 210 Fountain	Total/NA	Drinking Water	200.8	112933
550-79402-7	Building CC Room 210 Faucet	Total/NA	Drinking Water	200.8	112933
550-79402-8	Building CC Room 213 Faucet	Total/NA	Drinking Water	200.8	112933
550-79402-9	Building CC Room 213 Fountain	Total/NA	Drinking Water	200.8	112933
550-79402-10	Building CC Room 212 Faucet	Total/NA	Drinking Water	200.8	112933
550-79402-11	Building CC Room 212 Fountain	Total/NA	Drinking Water	200.8	112933
550-79402-12	Building CC South Side Fountains East	Total/NA	Drinking Water	200.8	112933
550-79402-13	Building CC 214 Fountain	Total/NA	Drinking Water	200.8	112933
550-79402-14	Building CC 214 Faucet Sink	Total/NA	Drinking Water	200.8	112933
550-79402-15	Building CC 214 Restroom Sink	Total/NA	Drinking Water	200.8	112933
550-79402-16	Building CC 215 Faucet	Total/NA	Drinking Water	200.8	112933
550-79402-17	Building CC 215 Fountain	Total/NA	Drinking Water	200.8	112933
550-79402-18	Building CC 216 Faucet	Total/NA	Drinking Water	200.8	112933
550-79402-19	Building CC 216 Fountain	Total/NA	Drinking Water	200.8	112933
MB 550-112933/1-A	Method Blank	Total/NA	Water	200.8	112933
LCS 550-112933/4-A	Lab Control Sample	Total/NA	Water	200.8	112933
LCSD 550-112933/5-A	Lab Control Sample Dup	Total/NA	Water	200.8	112933
550-79266-A-16-B MS	Matrix Spike	Total/NA	Water	200.8	112933
550-79266-A-16-C MSD	Matrix Spike Duplicate	Total/NA	Water	200.8	112933

Analysis Batch: 113240

Lab Sample ID	Client Sample ID	Prep Type	Matrix	Method	Prep Batch
550-79402-42	Building E West Fountains D-2	Total/NA	Drinking Water	200.8	112936
550-79402-43	Building E West Fountains Source	Total/NA	Drinking Water	200.8	112936
550-79402-44	Building F East Side Fountains 1	Total/NA	Drinking Water	200.8	112936
550-79402-45	Building F East Side Fountains 2 ID 1	Total/NA	Drinking Water	200.8	112936
550-79402-46	Building F East Side Fountains 2 ID Flush	Total/NA	Drinking Water	200.8	112936
550-79402-47	Building F East Side Fountains 1	Total/NA	Drinking Water	200.8	112936
550-79402-48	Building F East Side Fountains 2	Total/NA	Drinking Water	200.8	112936
550-79402-49	Building F East Side Fountains 3	Total/NA	Drinking Water	200.8	112936
550-79402-50	Building F East Side Fountains 4	Total/NA	Drinking Water	200.8	112936
550-79402-51	Building F East Side Fountains Source	Total/NA	Drinking Water	200.8	112936
550-79402-52	Building K 800 Womens Restroom East	Total/NA	Drinking Water	200.8	112936
550-79402-53	Building K 800 Womens Restroom West	Total/NA	Drinking Water	200.8	112936
550-79402-54	Building K Fountains North 1	Total/NA	Drinking Water	200.8	112936
550-79402-55	Building K Fountains North 2	Total/NA	Drinking Water	200.8	112936
550-79402-56	Building K Room 804 faucet	Total/NA	Drinking Water	200.8	112936
550-79402-57	Building K Room 803 faucet	Total/NA	Drinking Water	200.8	112936
550-79402-58	Building K 800 Mens Restroom West	Total/NA	Drinking Water	200.8	112936
550-79402-59	Building K Room 802 Sink ID1	Total/NA	Drinking Water	200.8	112936
550-79402-60	Building K Room 802 Sink Flush	Total/NA	Drinking Water	200.8	112936
550-79402-61	Building K Room 802 Sink 1	Total/NA	Drinking Water	200.8	112936

TestAmerica Phoenix

QC Association Summary

Client: Arizona Dept of Environmental Quality
Project/Site: Pb in DW/Creighton School District

TestAmerica Job ID: 550-79402-1
SDG: Creighton School Confirmation Sampling

Metals (Continued)

Analysis Batch: 113240 (Continued)

Lab Sample ID	Client Sample ID	Prep Type	Matrix	Method	Prep Batch
MB 550-112936/1-A	Method Blank	Total/NA	Water	200.8	112936
LCS 550-112936/4-A	Lab Control Sample	Total/NA	Water	200.8	112936
LCSD 550-112936/5-A	Lab Control Sample Dup	Total/NA	Water	200.8	112936
550-79402-42 MS	Building E West Fountains D-2	Total/NA	Drinking Water	200.8	112936
550-79402-42 MSD	Building E West Fountains D-2	Total/NA	Drinking Water	200.8	112936

Prep Batch: 113253

Lab Sample ID	Client Sample ID	Prep Type	Matrix	Method	Prep Batch
550-79402-37	Building E West Fountains West # 2	Total/NA	Drinking Water	200.8	
550-79402-39	Building E West Fountains D-2	Total/NA	Drinking Water	200.8	
550-79402-62	Building K Room 802 Sink 2	Total/NA	Drinking Water	200.8	
550-79402-63	Building K Room 802 Sink 3	Total/NA	Drinking Water	200.8	
550-79402-64	Building K Room 802 Sink 4	Total/NA	Drinking Water	200.8	
550-79402-65	Building K Room 802 Source	Total/NA	Drinking Water	200.8	
MB 550-113253/1-A	Method Blank	Total/NA	Water	200.8	
LCS 550-113253/4-A	Lab Control Sample	Total/NA	Water	200.8	
LCSD 550-113253/5-A	Lab Control Sample Dup	Total/NA	Water	200.8	
550-79583-A-2-C MS	Matrix Spike	Total/NA	Water	200.8	
550-79583-A-2-D MSD	Matrix Spike Duplicate	Total/NA	Water	200.8	

Analysis Batch: 113734

Lab Sample ID	Client Sample ID	Prep Type	Matrix	Method	Prep Batch
550-79402-62	Building K Room 802 Sink 2	Total/NA	Drinking Water	200.8	113253
550-79402-63	Building K Room 802 Sink 3	Total/NA	Drinking Water	200.8	113253
550-79402-64	Building K Room 802 Sink 4	Total/NA	Drinking Water	200.8	113253
550-79402-65	Building K Room 802 Source	Total/NA	Drinking Water	200.8	113253
MB 550-113253/1-A	Method Blank	Total/NA	Water	200.8	113253
LCS 550-113253/4-A	Lab Control Sample	Total/NA	Water	200.8	113253
LCSD 550-113253/5-A	Lab Control Sample Dup	Total/NA	Water	200.8	113253
550-79583-A-2-C MS	Matrix Spike	Total/NA	Water	200.8	113253
550-79583-A-2-D MSD	Matrix Spike Duplicate	Total/NA	Water	200.8	113253

Prep Batch: 113917

Lab Sample ID	Client Sample ID	Prep Type	Matrix	Method	Prep Batch
550-79402-20	Building CC Library Office Sink 1	Total/NA	Drinking Water	200.8	
550-79402-21	Building CC Library Office Sink 2	Total/NA	Drinking Water	200.8	
550-79402-22	Building CC Library Office Sink 3	Total/NA	Drinking Water	200.8	
550-79402-23	Building CC Library Office Sink 4	Total/NA	Drinking Water	200.8	
550-79402-24	Building CC Library Office Sink Source	Total/NA	Drinking Water	200.8	
550-79402-25	Building J East Side Hose BIB 1 ID	Total/NA	Drinking Water	200.8	
550-79402-26	Building J East Side Hose BIB 2 Flush	Total/NA	Drinking Water	200.8	
550-79402-27	Building J East Side Hose BIB 1 D-2	Total/NA	Drinking Water	200.8	
550-79402-28	Building J East Side Hose BIB 2 D-2	Total/NA	Drinking Water	200.8	
550-79402-29	Building J East Side Hose BIB 3 D-2	Total/NA	Drinking Water	200.8	
550-79402-30	Building J East Side Hose BIB 4 D-2	Total/NA	Drinking Water	200.8	
550-79402-31	Building J East Side Hose BIB Source	Total/NA	Drinking Water	200.8	
550-79402-32	Building E North Fountains 1	Total/NA	Drinking Water	200.8	
550-79402-33	Building E North Fountains 2	Total/NA	Drinking Water	200.8	
550-79402-34	Building E North Fountains 3	Total/NA	Drinking Water	200.8	
550-79402-35	Building E North Fountains 4	Total/NA	Drinking Water	200.8	
550-79402-36	Building E West Fountains 1 ID 1	Total/NA	Drinking Water	200.8	

TestAmerica Phoenix

QC Association Summary

Client: Arizona Dept of Environmental Quality
Project/Site: Pb in DW/Creighton School District

TestAmerica Job ID: 550-79402-1
SDG: Creighton School Confirmation Sampling

Metals (Continued)

Prep Batch: 113917 (Continued)

Lab Sample ID	Client Sample ID	Prep Type	Matrix	Method	Prep Batch
550-79402-38	Building E West Fountains 1 ID flush	Total/NA	Drinking Water	200.8	
550-79402-40	Building E West Fountains D-2	Total/NA	Drinking Water	200.8	
550-79402-41	Building E West Fountains D-2	Total/NA	Drinking Water	200.8	
MB 550-113917/1-A	Method Blank	Total/NA	Water	200.8	
LCS 550-113917/3-A	Lab Control Sample	Total/NA	Water	200.8	
LCSD 550-113917/4-A	Lab Control Sample Dup	Total/NA	Water	200.8	
550-79402-33 MS	Building E North Fountains 2	Total/NA	Drinking Water	200.8	
550-79402-33 MSD	Building E North Fountains 2	Total/NA	Drinking Water	200.8	

Analysis Batch: 113998

Lab Sample ID	Client Sample ID	Prep Type	Matrix	Method	Prep Batch
550-79402-20	Building CC Library Office Sink 1	Total/NA	Drinking Water	200.8	113917
550-79402-21	Building CC Library Office Sink 2	Total/NA	Drinking Water	200.8	113917
550-79402-22	Building CC Library Office Sink 3	Total/NA	Drinking Water	200.8	113917
550-79402-23	Building CC Library Office Sink 4	Total/NA	Drinking Water	200.8	113917
550-79402-25	Building J East Side Hose BIB 1 ID	Total/NA	Drinking Water	200.8	113917
550-79402-26	Building J East Side Hose BIB 2 Flush	Total/NA	Drinking Water	200.8	113917
550-79402-27	Building J East Side Hose BIB 1 D-2	Total/NA	Drinking Water	200.8	113917
550-79402-28	Building J East Side Hose BIB 2 D-2	Total/NA	Drinking Water	200.8	113917
550-79402-29	Building J East Side Hose BIB 3 D-2	Total/NA	Drinking Water	200.8	113917
550-79402-30	Building J East Side Hose BIB 4 D-2	Total/NA	Drinking Water	200.8	113917
550-79402-31	Building J East Side Hose BIB Source	Total/NA	Drinking Water	200.8	113917
550-79402-32	Building E North Fountains 1	Total/NA	Drinking Water	200.8	113917
550-79402-33	Building E North Fountains 2	Total/NA	Drinking Water	200.8	113917
550-79402-34	Building E North Fountains 3	Total/NA	Drinking Water	200.8	113917
550-79402-35	Building E North Fountains 4	Total/NA	Drinking Water	200.8	113917
550-79402-36	Building E West Fountains 1 ID 1	Total/NA	Drinking Water	200.8	113917
550-79402-37	Building E West Fountains West # 2	Total/NA	Drinking Water	200.8	113253
550-79402-38	Building E West Fountains 1 ID flush	Total/NA	Drinking Water	200.8	113917
550-79402-40	Building E West Fountains D-2	Total/NA	Drinking Water	200.8	113917
550-79402-41	Building E West Fountains D-2	Total/NA	Drinking Water	200.8	113917
MB 550-113917/1-A	Method Blank	Total/NA	Water	200.8	113917
LCS 550-113917/3-A	Lab Control Sample	Total/NA	Water	200.8	113917
LCSD 550-113917/4-A	Lab Control Sample Dup	Total/NA	Water	200.8	113917
550-79402-33 MS	Building E North Fountains 2	Total/NA	Drinking Water	200.8	113917
550-79402-33 MSD	Building E North Fountains 2	Total/NA	Drinking Water	200.8	113917

Analysis Batch: 114083

Lab Sample ID	Client Sample ID	Prep Type	Matrix	Method	Prep Batch
550-79402-24	Building CC Library Office Sink Source	Total/NA	Drinking Water	200.8	113917
550-79402-39	Building E West Fountains D-2	Total/NA	Drinking Water	200.8	113253

Lab Chronicle

Client: Arizona Dept of Environmental Quality
Project/Site: Pb in DW/Creighton School District

TestAmerica Job ID: 550-79402-1
SDG: Creighton School Confirmation Sampling

Client Sample ID: Building CC Library Office Sink ID-1

Lab Sample ID: 550-79402-1

Date Collected: 03/14/17 08:46

Matrix: Drinking Water

Date Received: 03/16/17 16:15

Prep Type	Batch Type	Batch Method	Run	Dilution Factor	Batch Number	Prepared or Analyzed	Analyst	Lab
Total/NA	Prep	200.8			112933	03/22/17 07:28	SGO	TAL PHX
Total/NA	Analysis	200.8		1	113239	03/25/17 09:17	TEK	TAL PHX

Client Sample ID: Building CC Library Office Sink flush

Lab Sample ID: 550-79402-2

Date Collected: 03/14/17 08:48

Matrix: Drinking Water

Date Received: 03/16/17 16:15

Prep Type	Batch Type	Batch Method	Run	Dilution Factor	Batch Number	Prepared or Analyzed	Analyst	Lab
Total/NA	Prep	200.8			112933	03/22/17 07:28	SGO	TAL PHX
Total/NA	Analysis	200.8		1	113239	03/25/17 09:18	TEK	TAL PHX

Client Sample ID: Building CC Room 203 Sink

Lab Sample ID: 550-79402-3

Date Collected: 03/14/17 08:52

Matrix: Drinking Water

Date Received: 03/16/17 16:15

Prep Type	Batch Type	Batch Method	Run	Dilution Factor	Batch Number	Prepared or Analyzed	Analyst	Lab
Total/NA	Prep	200.8			112933	03/22/17 07:28	SGO	TAL PHX
Total/NA	Analysis	200.8		1	113239	03/25/17 09:20	TEK	TAL PHX

Client Sample ID: Building CC Room 211 Faucet

Lab Sample ID: 550-79402-4

Date Collected: 03/14/17 08:57

Matrix: Drinking Water

Date Received: 03/16/17 16:15

Prep Type	Batch Type	Batch Method	Run	Dilution Factor	Batch Number	Prepared or Analyzed	Analyst	Lab
Total/NA	Prep	200.8			112933	03/22/17 07:28	SGO	TAL PHX
Total/NA	Analysis	200.8		1	113239	03/25/17 09:22	TEK	TAL PHX

Client Sample ID: Building CC Room 211 Drinking Fountain

Lab Sample ID: 550-79402-5

Date Collected: 03/14/17 08:57

Matrix: Drinking Water

Date Received: 03/16/17 16:15

Prep Type	Batch Type	Batch Method	Run	Dilution Factor	Batch Number	Prepared or Analyzed	Analyst	Lab
Total/NA	Prep	200.8			112933	03/22/17 07:28	SGO	TAL PHX
Total/NA	Analysis	200.8		1	113239	03/25/17 09:24	TEK	TAL PHX

Client Sample ID: Building CC Room 210 Fountain

Lab Sample ID: 550-79402-6

Date Collected: 03/14/17 09:01

Matrix: Drinking Water

Date Received: 03/16/17 16:15

Prep Type	Batch Type	Batch Method	Run	Dilution Factor	Batch Number	Prepared or Analyzed	Analyst	Lab
Total/NA	Prep	200.8			112933	03/22/17 07:28	SGO	TAL PHX
Total/NA	Analysis	200.8		1	113239	03/25/17 09:26	TEK	TAL PHX

TestAmerica Phoenix

Lab Chronicle

Client: Arizona Dept of Environmental Quality
Project/Site: Pb in DW/Creighton School District

TestAmerica Job ID: 550-79402-1
SDG: Creighton School Confirmation Sampling

Client Sample ID: Building CC Room 210 Faucet

Lab Sample ID: 550-79402-7

Date Collected: 03/14/17 09:01

Matrix: Drinking Water

Date Received: 03/16/17 16:15

Prep Type	Batch Type	Batch Method	Run	Dilution Factor	Batch Number	Prepared or Analyzed	Analyst	Lab
Total/NA	Prep	200.8			112933	03/22/17 07:28	SGO	TAL PHX
Total/NA	Analysis	200.8		1	113239	03/25/17 09:28	TEK	TAL PHX

Client Sample ID: Building CC Room 213 Faucet

Lab Sample ID: 550-79402-8

Date Collected: 03/14/17 09:04

Matrix: Drinking Water

Date Received: 03/16/17 16:15

Prep Type	Batch Type	Batch Method	Run	Dilution Factor	Batch Number	Prepared or Analyzed	Analyst	Lab
Total/NA	Prep	200.8			112933	03/22/17 07:28	SGO	TAL PHX
Total/NA	Analysis	200.8		1	113239	03/25/17 09:30	TEK	TAL PHX

Client Sample ID: Building CC Room 213 Fountain

Lab Sample ID: 550-79402-9

Date Collected: 03/14/17 09:04

Matrix: Drinking Water

Date Received: 03/16/17 16:15

Prep Type	Batch Type	Batch Method	Run	Dilution Factor	Batch Number	Prepared or Analyzed	Analyst	Lab
Total/NA	Prep	200.8			112933	03/22/17 07:28	SGO	TAL PHX
Total/NA	Analysis	200.8		1	113239	03/25/17 09:32	TEK	TAL PHX

Client Sample ID: Building CC Room 212 Faucet

Lab Sample ID: 550-79402-10

Date Collected: 03/14/17 09:06

Matrix: Drinking Water

Date Received: 03/16/17 16:15

Prep Type	Batch Type	Batch Method	Run	Dilution Factor	Batch Number	Prepared or Analyzed	Analyst	Lab
Total/NA	Prep	200.8			112933	03/22/17 07:28	SGO	TAL PHX
Total/NA	Analysis	200.8		1	113239	03/25/17 09:37	TEK	TAL PHX

Client Sample ID: Building CC Room 212 Fountain

Lab Sample ID: 550-79402-11

Date Collected: 03/14/17 09:06

Matrix: Drinking Water

Date Received: 03/16/17 16:15

Prep Type	Batch Type	Batch Method	Run	Dilution Factor	Batch Number	Prepared or Analyzed	Analyst	Lab
Total/NA	Prep	200.8			112933	03/22/17 07:28	SGO	TAL PHX
Total/NA	Analysis	200.8		1	113239	03/25/17 09:39	TEK	TAL PHX

Client Sample ID: Building CC South Side Fountains East

Lab Sample ID: 550-79402-12

Date Collected: 03/14/17 09:11

Matrix: Drinking Water

Date Received: 03/16/17 16:15

Prep Type	Batch Type	Batch Method	Run	Dilution Factor	Batch Number	Prepared or Analyzed	Analyst	Lab
Total/NA	Prep	200.8			112933	03/22/17 07:28	SGO	TAL PHX
Total/NA	Analysis	200.8		1	113239	03/25/17 09:41	TEK	TAL PHX

TestAmerica Phoenix

Lab Chronicle

Client: Arizona Dept of Environmental Quality
Project/Site: Pb in DW/Creighton School District

TestAmerica Job ID: 550-79402-1
SDG: Creighton School Confirmation Sampling

Client Sample ID: Building CC 214 Fountain

Lab Sample ID: 550-79402-13

Date Collected: 03/14/17 09:29

Matrix: Drinking Water

Date Received: 03/16/17 16:15

Prep Type	Batch Type	Batch Method	Run	Dilution Factor	Batch Number	Prepared or Analyzed	Analyst	Lab
Total/NA	Prep	200.8			112933	03/22/17 07:28	SGO	TAL PHX
Total/NA	Analysis	200.8		1	113239	03/25/17 09:43	TEK	TAL PHX

Client Sample ID: Building CC 214 Faucet Sink

Lab Sample ID: 550-79402-14

Date Collected: 03/14/17 09:29

Matrix: Drinking Water

Date Received: 03/16/17 16:15

Prep Type	Batch Type	Batch Method	Run	Dilution Factor	Batch Number	Prepared or Analyzed	Analyst	Lab
Total/NA	Prep	200.8			112933	03/22/17 07:28	SGO	TAL PHX
Total/NA	Analysis	200.8		1	113239	03/25/17 09:45	TEK	TAL PHX

Client Sample ID: Building CC 214 Restroom Sink

Lab Sample ID: 550-79402-15

Date Collected: 03/14/17 09:32

Matrix: Drinking Water

Date Received: 03/16/17 16:15

Prep Type	Batch Type	Batch Method	Run	Dilution Factor	Batch Number	Prepared or Analyzed	Analyst	Lab
Total/NA	Prep	200.8			112933	03/22/17 07:28	SGO	TAL PHX
Total/NA	Analysis	200.8		1	113239	03/25/17 09:47	TEK	TAL PHX

Client Sample ID: Building CC 215 Faucet

Lab Sample ID: 550-79402-16

Date Collected: 03/14/17 09:34

Matrix: Drinking Water

Date Received: 03/16/17 16:15

Prep Type	Batch Type	Batch Method	Run	Dilution Factor	Batch Number	Prepared or Analyzed	Analyst	Lab
Total/NA	Prep	200.8			112933	03/22/17 07:28	SGO	TAL PHX
Total/NA	Analysis	200.8		1	113239	03/25/17 09:49	TEK	TAL PHX

Client Sample ID: Building CC 215 Fountain

Lab Sample ID: 550-79402-17

Date Collected: 03/14/17 09:34

Matrix: Drinking Water

Date Received: 03/16/17 16:15

Prep Type	Batch Type	Batch Method	Run	Dilution Factor	Batch Number	Prepared or Analyzed	Analyst	Lab
Total/NA	Prep	200.8			112933	03/22/17 07:28	SGO	TAL PHX
Total/NA	Analysis	200.8		1	113239	03/25/17 09:51	TEK	TAL PHX

Client Sample ID: Building CC 216 Faucet

Lab Sample ID: 550-79402-18

Date Collected: 03/14/17 09:37

Matrix: Drinking Water

Date Received: 03/16/17 16:15

Prep Type	Batch Type	Batch Method	Run	Dilution Factor	Batch Number	Prepared or Analyzed	Analyst	Lab
Total/NA	Prep	200.8			112933	03/22/17 07:28	SGO	TAL PHX
Total/NA	Analysis	200.8		1	113239	03/25/17 09:53	TEK	TAL PHX

TestAmerica Phoenix

Lab Chronicle

Client: Arizona Dept of Environmental Quality
Project/Site: Pb in DW/Creighton School District

TestAmerica Job ID: 550-79402-1
SDG: Creighton School Confirmation Sampling

Client Sample ID: Building CC 216 Fountain

Lab Sample ID: 550-79402-19

Date Collected: 03/14/17 09:37

Matrix: Drinking Water

Date Received: 03/16/17 16:15

Prep Type	Batch Type	Batch Method	Run	Dilution Factor	Batch Number	Prepared or Analyzed	Analyst	Lab
Total/NA	Prep	200.8			112933	03/22/17 07:28	SGO	TAL PHX
Total/NA	Analysis	200.8		1	113239	03/25/17 09:54	TEK	TAL PHX

Client Sample ID: Building CC Library Office Sink 1

Lab Sample ID: 550-79402-20

Date Collected: 03/15/17 08:59

Matrix: Drinking Water

Date Received: 03/16/17 16:15

Prep Type	Batch Type	Batch Method	Run	Dilution Factor	Batch Number	Prepared or Analyzed	Analyst	Lab
Total/NA	Prep	200.8			113917	04/04/17 06:40	SGO	TAL PHX
Total/NA	Analysis	200.8		1	113998	04/04/17 13:14	TEK	TAL PHX

Client Sample ID: Building CC Library Office Sink 2

Lab Sample ID: 550-79402-21

Date Collected: 03/15/17 09:00

Matrix: Drinking Water

Date Received: 03/16/17 16:15

Prep Type	Batch Type	Batch Method	Run	Dilution Factor	Batch Number	Prepared or Analyzed	Analyst	Lab
Total/NA	Prep	200.8			113917	04/04/17 06:40	SGO	TAL PHX
Total/NA	Analysis	200.8		1	113998	04/04/17 13:16	TEK	TAL PHX

Client Sample ID: Building CC Library Office Sink 3

Lab Sample ID: 550-79402-22

Date Collected: 03/15/17 09:01

Matrix: Drinking Water

Date Received: 03/16/17 16:15

Prep Type	Batch Type	Batch Method	Run	Dilution Factor	Batch Number	Prepared or Analyzed	Analyst	Lab
Total/NA	Prep	200.8			113917	04/04/17 06:40	SGO	TAL PHX
Total/NA	Analysis	200.8		1	113998	04/04/17 13:18	TEK	TAL PHX

Client Sample ID: Building CC Library Office Sink 4

Lab Sample ID: 550-79402-23

Date Collected: 03/15/17 09:02

Matrix: Drinking Water

Date Received: 03/16/17 16:15

Prep Type	Batch Type	Batch Method	Run	Dilution Factor	Batch Number	Prepared or Analyzed	Analyst	Lab
Total/NA	Prep	200.8			113917	04/04/17 06:40	SGO	TAL PHX
Total/NA	Analysis	200.8		1	113998	04/04/17 13:20	TEK	TAL PHX

Client Sample ID: Building CC Library Office Sink Source

Lab Sample ID: 550-79402-24

Date Collected: 03/15/17 09:03

Matrix: Drinking Water

Date Received: 03/16/17 16:15

Prep Type	Batch Type	Batch Method	Run	Dilution Factor	Batch Number	Prepared or Analyzed	Analyst	Lab
Total/NA	Prep	200.8			113917	04/04/17 06:40	SGO	TAL PHX
Total/NA	Analysis	200.8		100	114083	04/05/17 08:48	TEK	TAL PHX

TestAmerica Phoenix

Lab Chronicle

Client: Arizona Dept of Environmental Quality
Project/Site: Pb in DW/Creighton School District

TestAmerica Job ID: 550-79402-1
SDG: Creighton School Confirmation Sampling

Client Sample ID: Building J East Side Hose BIB 1 ID

Lab Sample ID: 550-79402-25

Date Collected: 03/14/17 08:07

Matrix: Drinking Water

Date Received: 03/16/17 16:15

Prep Type	Batch Type	Batch Method	Run	Dilution Factor	Batch Number	Prepared or Analyzed	Analyst	Lab
Total/NA	Prep	200.8			113917	04/04/17 06:40	SGO	TAL PHX
Total/NA	Analysis	200.8		1	113998	04/04/17 13:24	TEK	TAL PHX

Client Sample ID: Building J East Side Hose BIB 2 Flush

Lab Sample ID: 550-79402-26

Date Collected: 03/14/17 08:10

Matrix: Drinking Water

Date Received: 03/16/17 16:15

Prep Type	Batch Type	Batch Method	Run	Dilution Factor	Batch Number	Prepared or Analyzed	Analyst	Lab
Total/NA	Prep	200.8			113917	04/04/17 06:40	SGO	TAL PHX
Total/NA	Analysis	200.8		1	113998	04/04/17 13:30	TEK	TAL PHX

Client Sample ID: Building J East Side Hose BIB 1 D-2

Lab Sample ID: 550-79402-27

Date Collected: 03/15/17 08:41

Matrix: Drinking Water

Date Received: 03/16/17 16:15

Prep Type	Batch Type	Batch Method	Run	Dilution Factor	Batch Number	Prepared or Analyzed	Analyst	Lab
Total/NA	Prep	200.8			113917	04/04/17 06:40	SGO	TAL PHX
Total/NA	Analysis	200.8		1	113998	04/04/17 13:32	TEK	TAL PHX

Client Sample ID: Building J East Side Hose BIB 2 D-2

Lab Sample ID: 550-79402-28

Date Collected: 03/15/17 08:42

Matrix: Drinking Water

Date Received: 03/16/17 16:15

Prep Type	Batch Type	Batch Method	Run	Dilution Factor	Batch Number	Prepared or Analyzed	Analyst	Lab
Total/NA	Prep	200.8			113917	04/04/17 06:40	SGO	TAL PHX
Total/NA	Analysis	200.8		1	113998	04/04/17 13:34	TEK	TAL PHX

Client Sample ID: Building J East Side Hose BIB 3 D-2

Lab Sample ID: 550-79402-29

Date Collected: 03/15/17 08:43

Matrix: Drinking Water

Date Received: 03/16/17 16:15

Prep Type	Batch Type	Batch Method	Run	Dilution Factor	Batch Number	Prepared or Analyzed	Analyst	Lab
Total/NA	Prep	200.8			113917	04/04/17 06:40	SGO	TAL PHX
Total/NA	Analysis	200.8		1	113998	04/04/17 13:36	TEK	TAL PHX

Client Sample ID: Building J East Side Hose BIB 4 D-2

Lab Sample ID: 550-79402-30

Date Collected: 03/15/17 08:43

Matrix: Drinking Water

Date Received: 03/16/17 16:15

Prep Type	Batch Type	Batch Method	Run	Dilution Factor	Batch Number	Prepared or Analyzed	Analyst	Lab
Total/NA	Prep	200.8			113917	04/04/17 06:40	SGO	TAL PHX
Total/NA	Analysis	200.8		1	113998	04/04/17 13:38	TEK	TAL PHX

TestAmerica Phoenix

Lab Chronicle

Client: Arizona Dept of Environmental Quality
Project/Site: Pb in DW/Creighton School District

TestAmerica Job ID: 550-79402-1
SDG: Creighton School Confirmation Sampling

Client Sample ID: Building J East Side Hose BIB Source

Lab Sample ID: 550-79402-31

Date Collected: 03/15/17 08:44

Matrix: Drinking Water

Date Received: 03/16/17 16:15

Prep Type	Batch Type	Batch Method	Run	Dilution Factor	Batch Number	Prepared or Analyzed	Analyst	Lab
Total/NA	Prep	200.8			113917	04/04/17 06:40	SGO	TAL PHX
Total/NA	Analysis	200.8		1	113998	04/04/17 13:39	TEK	TAL PHX

Client Sample ID: Building E North Fountains 1

Lab Sample ID: 550-79402-32

Date Collected: 03/14/17 07:40

Matrix: Drinking Water

Date Received: 03/16/17 16:15

Prep Type	Batch Type	Batch Method	Run	Dilution Factor	Batch Number	Prepared or Analyzed	Analyst	Lab
Total/NA	Prep	200.8			113917	04/04/17 06:40	SGO	TAL PHX
Total/NA	Analysis	200.8		1	113998	04/04/17 13:41	TEK	TAL PHX

Client Sample ID: Building E North Fountains 2

Lab Sample ID: 550-79402-33

Date Collected: 03/14/17 07:40

Matrix: Drinking Water

Date Received: 03/16/17 16:15

Prep Type	Batch Type	Batch Method	Run	Dilution Factor	Batch Number	Prepared or Analyzed	Analyst	Lab
Total/NA	Prep	200.8			113917	04/04/17 06:40	SGO	TAL PHX
Total/NA	Analysis	200.8		1	113998	04/04/17 13:09	TEK	TAL PHX

Client Sample ID: Building E North Fountains 3

Lab Sample ID: 550-79402-34

Date Collected: 03/14/17 07:40

Matrix: Drinking Water

Date Received: 03/16/17 16:15

Prep Type	Batch Type	Batch Method	Run	Dilution Factor	Batch Number	Prepared or Analyzed	Analyst	Lab
Total/NA	Prep	200.8			113917	04/04/17 06:40	SGO	TAL PHX
Total/NA	Analysis	200.8		1	113998	04/04/17 13:47	TEK	TAL PHX

Client Sample ID: Building E North Fountains 4

Lab Sample ID: 550-79402-35

Date Collected: 03/14/17 07:40

Matrix: Drinking Water

Date Received: 03/16/17 16:15

Prep Type	Batch Type	Batch Method	Run	Dilution Factor	Batch Number	Prepared or Analyzed	Analyst	Lab
Total/NA	Prep	200.8			113917	04/04/17 06:40	SGO	TAL PHX
Total/NA	Analysis	200.8		1	113998	04/04/17 13:49	TEK	TAL PHX

Client Sample ID: Building E West Fountains 1 ID 1

Lab Sample ID: 550-79402-36

Date Collected: 03/14/17 07:46

Matrix: Drinking Water

Date Received: 03/16/17 16:15

Prep Type	Batch Type	Batch Method	Run	Dilution Factor	Batch Number	Prepared or Analyzed	Analyst	Lab
Total/NA	Prep	200.8			113917	04/04/17 06:40	SGO	TAL PHX
Total/NA	Analysis	200.8		1	113998	04/04/17 13:51	TEK	TAL PHX

TestAmerica Phoenix

Lab Chronicle

Client: Arizona Dept of Environmental Quality
Project/Site: Pb in DW/Creighton School District

TestAmerica Job ID: 550-79402-1
SDG: Creighton School Confirmation Sampling

Client Sample ID: Building E West Fountains West # 2

Lab Sample ID: 550-79402-37

Date Collected: 03/14/17 07:46

Matrix: Drinking Water

Date Received: 03/16/17 16:15

Prep Type	Batch Type	Batch Method	Run	Dilution Factor	Batch Number	Prepared or Analyzed	Analyst	Lab
Total/NA	Prep	200.8			113253	03/25/17 15:09	EXZ	TAL PHX
Total/NA	Analysis	200.8		10	113998	04/04/17 13:59	TEK	TAL PHX

Client Sample ID: Building E West Fountains 1 ID flush

Lab Sample ID: 550-79402-38

Date Collected: 03/14/17 07:48

Matrix: Drinking Water

Date Received: 03/16/17 16:15

Prep Type	Batch Type	Batch Method	Run	Dilution Factor	Batch Number	Prepared or Analyzed	Analyst	Lab
Total/NA	Prep	200.8			113917	04/04/17 06:40	SGO	TAL PHX
Total/NA	Analysis	200.8		1	113998	04/04/17 13:53	TEK	TAL PHX

Client Sample ID: Building E West Fountains D-2

Lab Sample ID: 550-79402-39

Date Collected: 03/15/17 08:16

Matrix: Drinking Water

Date Received: 03/16/17 16:15

Prep Type	Batch Type	Batch Method	Run	Dilution Factor	Batch Number	Prepared or Analyzed	Analyst	Lab
Total/NA	Prep	200.8			113253	03/25/17 15:09	EXZ	TAL PHX
Total/NA	Analysis	200.8		100	114083	04/05/17 08:46	TEK	TAL PHX

Client Sample ID: Building E West Fountains D-2

Lab Sample ID: 550-79402-40

Date Collected: 03/15/17 08:18

Matrix: Drinking Water

Date Received: 03/16/17 16:15

Prep Type	Batch Type	Batch Method	Run	Dilution Factor	Batch Number	Prepared or Analyzed	Analyst	Lab
Total/NA	Prep	200.8			113917	04/04/17 06:40	SGO	TAL PHX
Total/NA	Analysis	200.8		1	113998	04/04/17 13:55	TEK	TAL PHX

Client Sample ID: Building E West Fountains D-2

Lab Sample ID: 550-79402-41

Date Collected: 03/15/17 08:19

Matrix: Drinking Water

Date Received: 03/16/17 16:15

Prep Type	Batch Type	Batch Method	Run	Dilution Factor	Batch Number	Prepared or Analyzed	Analyst	Lab
Total/NA	Prep	200.8			113917	04/04/17 06:40	SGO	TAL PHX
Total/NA	Analysis	200.8		1	113998	04/04/17 13:57	TEK	TAL PHX

Client Sample ID: Building E West Fountains D-2

Lab Sample ID: 550-79402-42

Date Collected: 03/15/17 08:20

Matrix: Drinking Water

Date Received: 03/16/17 16:15

Prep Type	Batch Type	Batch Method	Run	Dilution Factor	Batch Number	Prepared or Analyzed	Analyst	Lab
Total/NA	Prep	200.8			112936	03/22/17 07:41	SGO	TAL PHX
Total/NA	Analysis	200.8		1	113240	03/25/17 10:09	TEK	TAL PHX

TestAmerica Phoenix

Lab Chronicle

Client: Arizona Dept of Environmental Quality
Project/Site: Pb in DW/Creighton School District

TestAmerica Job ID: 550-79402-1
SDG: Creighton School Confirmation Sampling

Client Sample ID: Building E West Fountains Source

Lab Sample ID: 550-79402-43

Date Collected: 03/15/17 08:21

Matrix: Drinking Water

Date Received: 03/16/17 16:15

Prep Type	Batch Type	Batch Method	Run	Dilution Factor	Batch Number	Prepared or Analyzed	Analyst	Lab
Total/NA	Prep	200.8			112936	03/22/17 07:41	SGO	TAL PHX
Total/NA	Analysis	200.8		1	113240	03/25/17 10:15	TEK	TAL PHX

Client Sample ID: Building F East Side Fountains 1

Lab Sample ID: 550-79402-44

Date Collected: 03/14/17 07:58

Matrix: Drinking Water

Date Received: 03/16/17 16:15

Prep Type	Batch Type	Batch Method	Run	Dilution Factor	Batch Number	Prepared or Analyzed	Analyst	Lab
Total/NA	Prep	200.8			112936	03/22/17 07:41	SGO	TAL PHX
Total/NA	Analysis	200.8		1	113240	03/25/17 10:17	TEK	TAL PHX

Client Sample ID: Building F East Side Fountains 2 ID 1

Lab Sample ID: 550-79402-45

Date Collected: 03/14/17 07:58

Matrix: Drinking Water

Date Received: 03/16/17 16:15

Prep Type	Batch Type	Batch Method	Run	Dilution Factor	Batch Number	Prepared or Analyzed	Analyst	Lab
Total/NA	Prep	200.8			112936	03/22/17 07:41	SGO	TAL PHX
Total/NA	Analysis	200.8		1	113240	03/25/17 10:19	TEK	TAL PHX

Client Sample ID: Building F East Side Fountains 2 ID Flush

Lab Sample ID: 550-79402-46

Date Collected: 03/14/17 08:00

Matrix: Drinking Water

Date Received: 03/16/17 16:15

Prep Type	Batch Type	Batch Method	Run	Dilution Factor	Batch Number	Prepared or Analyzed	Analyst	Lab
Total/NA	Prep	200.8			112936	03/22/17 07:41	SGO	TAL PHX
Total/NA	Analysis	200.8		1	113240	03/25/17 10:21	TEK	TAL PHX

Client Sample ID: Building F East Side Fountains 1

Lab Sample ID: 550-79402-47

Date Collected: 03/15/17 08:30

Matrix: Drinking Water

Date Received: 03/16/17 16:15

Prep Type	Batch Type	Batch Method	Run	Dilution Factor	Batch Number	Prepared or Analyzed	Analyst	Lab
Total/NA	Prep	200.8			112936	03/22/17 07:41	SGO	TAL PHX
Total/NA	Analysis	200.8		1	113240	03/25/17 10:23	TEK	TAL PHX

Client Sample ID: Building F East Side Fountains 2

Lab Sample ID: 550-79402-48

Date Collected: 03/15/17 08:32

Matrix: Drinking Water

Date Received: 03/16/17 16:15

Prep Type	Batch Type	Batch Method	Run	Dilution Factor	Batch Number	Prepared or Analyzed	Analyst	Lab
Total/NA	Prep	200.8			112936	03/22/17 07:41	SGO	TAL PHX
Total/NA	Analysis	200.8		1	113240	03/25/17 10:25	TEK	TAL PHX

TestAmerica Phoenix

Lab Chronicle

Client: Arizona Dept of Environmental Quality
Project/Site: Pb in DW/Creighton School District

TestAmerica Job ID: 550-79402-1
SDG: Creighton School Confirmation Sampling

Client Sample ID: Building F East Side Fountains 3

Lab Sample ID: 550-79402-49

Date Collected: 03/15/17 08:33

Matrix: Drinking Water

Date Received: 03/16/17 16:15

Prep Type	Batch Type	Batch Method	Run	Dilution Factor	Batch Number	Prepared or Analyzed	Analyst	Lab
Total/NA	Prep	200.8			112936	03/22/17 07:41	SGO	TAL PHX
Total/NA	Analysis	200.8		1	113240	03/25/17 10:27	TEK	TAL PHX

Client Sample ID: Building F East Side Fountains 4

Lab Sample ID: 550-79402-50

Date Collected: 03/15/17 08:34

Matrix: Drinking Water

Date Received: 03/16/17 16:15

Prep Type	Batch Type	Batch Method	Run	Dilution Factor	Batch Number	Prepared or Analyzed	Analyst	Lab
Total/NA	Prep	200.8			112936	03/22/17 07:41	SGO	TAL PHX
Total/NA	Analysis	200.8		1	113240	03/25/17 10:29	TEK	TAL PHX

Client Sample ID: Building F East Side Fountains Source

Lab Sample ID: 550-79402-51

Date Collected: 03/15/17 08:35

Matrix: Drinking Water

Date Received: 03/16/17 16:15

Prep Type	Batch Type	Batch Method	Run	Dilution Factor	Batch Number	Prepared or Analyzed	Analyst	Lab
Total/NA	Prep	200.8			112936	03/22/17 07:41	SGO	TAL PHX
Total/NA	Analysis	200.8		1	113240	03/25/17 10:30	TEK	TAL PHX

Client Sample ID: Building K 800 Womens Restroom East

Lab Sample ID: 550-79402-52

Date Collected: 03/14/17 08:15

Matrix: Drinking Water

Date Received: 03/16/17 16:15

Prep Type	Batch Type	Batch Method	Run	Dilution Factor	Batch Number	Prepared or Analyzed	Analyst	Lab
Total/NA	Prep	200.8			112936	03/22/17 07:41	SGO	TAL PHX
Total/NA	Analysis	200.8		1	113240	03/25/17 10:36	TEK	TAL PHX

Client Sample ID: Building K 800 Womens Restroom West

Lab Sample ID: 550-79402-53

Date Collected: 03/14/17 08:16

Matrix: Drinking Water

Date Received: 03/16/17 16:15

Prep Type	Batch Type	Batch Method	Run	Dilution Factor	Batch Number	Prepared or Analyzed	Analyst	Lab
Total/NA	Prep	200.8			112936	03/22/17 07:41	SGO	TAL PHX
Total/NA	Analysis	200.8		1	113240	03/25/17 10:38	TEK	TAL PHX

Client Sample ID: Building K Fountains North 1

Lab Sample ID: 550-79402-54

Date Collected: 03/14/17 08:16

Matrix: Drinking Water

Date Received: 03/16/17 16:15

Prep Type	Batch Type	Batch Method	Run	Dilution Factor	Batch Number	Prepared or Analyzed	Analyst	Lab
Total/NA	Prep	200.8			112936	03/22/17 07:41	SGO	TAL PHX
Total/NA	Analysis	200.8		1	113240	03/25/17 10:40	TEK	TAL PHX

TestAmerica Phoenix

Lab Chronicle

Client: Arizona Dept of Environmental Quality
Project/Site: Pb in DW/Creighton School District

TestAmerica Job ID: 550-79402-1
SDG: Creighton School Confirmation Sampling

Client Sample ID: Building K Fountains North 2

Lab Sample ID: 550-79402-55

Date Collected: 03/14/17 08:17

Matrix: Drinking Water

Date Received: 03/16/17 16:15

Prep Type	Batch Type	Batch Method	Run	Dilution Factor	Batch Number	Prepared or Analyzed	Analyst	Lab
Total/NA	Prep	200.8			112936	03/22/17 07:41	SGO	TAL PHX
Total/NA	Analysis	200.8		1	113240	03/25/17 10:42	TEK	TAL PHX

Client Sample ID: Building K Room 804 faucet

Lab Sample ID: 550-79402-56

Date Collected: 03/14/17 08:20

Matrix: Drinking Water

Date Received: 03/16/17 16:15

Prep Type	Batch Type	Batch Method	Run	Dilution Factor	Batch Number	Prepared or Analyzed	Analyst	Lab
Total/NA	Prep	200.8			112936	03/22/17 07:41	SGO	TAL PHX
Total/NA	Analysis	200.8		1	113240	03/25/17 10:44	TEK	TAL PHX

Client Sample ID: Building K Room 803 faucet

Lab Sample ID: 550-79402-57

Date Collected: 03/14/17 08:20

Matrix: Drinking Water

Date Received: 03/16/17 16:15

Prep Type	Batch Type	Batch Method	Run	Dilution Factor	Batch Number	Prepared or Analyzed	Analyst	Lab
Total/NA	Prep	200.8			112936	03/22/17 07:41	SGO	TAL PHX
Total/NA	Analysis	200.8		1	113240	03/25/17 10:46	TEK	TAL PHX

Client Sample ID: Building K 800 Mens Restroom West

Lab Sample ID: 550-79402-58

Date Collected: 03/14/17 08:24

Matrix: Drinking Water

Date Received: 03/16/17 16:15

Prep Type	Batch Type	Batch Method	Run	Dilution Factor	Batch Number	Prepared or Analyzed	Analyst	Lab
Total/NA	Prep	200.8			112936	03/22/17 07:41	SGO	TAL PHX
Total/NA	Analysis	200.8		1	113240	03/25/17 10:47	TEK	TAL PHX

Client Sample ID: Building K Room 802 Sink ID1

Lab Sample ID: 550-79402-59

Date Collected: 03/14/17 08:34

Matrix: Drinking Water

Date Received: 03/16/17 16:15

Prep Type	Batch Type	Batch Method	Run	Dilution Factor	Batch Number	Prepared or Analyzed	Analyst	Lab
Total/NA	Prep	200.8			112936	03/22/17 07:41	SGO	TAL PHX
Total/NA	Analysis	200.8		1	113240	03/25/17 10:49	TEK	TAL PHX

Client Sample ID: Building K Room 802 Sink Flush

Lab Sample ID: 550-79402-60

Date Collected: 03/14/17 08:35

Matrix: Drinking Water

Date Received: 03/16/17 16:15

Prep Type	Batch Type	Batch Method	Run	Dilution Factor	Batch Number	Prepared or Analyzed	Analyst	Lab
Total/NA	Prep	200.8			112936	03/22/17 07:41	SGO	TAL PHX
Total/NA	Analysis	200.8		1	113240	03/25/17 10:51	TEK	TAL PHX

TestAmerica Phoenix

Lab Chronicle

Client: Arizona Dept of Environmental Quality
Project/Site: Pb in DW/Creighton School District

TestAmerica Job ID: 550-79402-1
SDG: Creighton School Confirmation Sampling

Client Sample ID: Building K Room 802 Sink 1

Lab Sample ID: 550-79402-61

Date Collected: 03/15/17 08:52

Matrix: Drinking Water

Date Received: 03/16/17 16:15

Prep Type	Batch Type	Batch Method	Run	Dilution Factor	Batch Number	Prepared or Analyzed	Analyst	Lab
Total/NA	Prep	200.8			112936	03/22/17 07:41	SGO	TAL PHX
Total/NA	Analysis	200.8		1	113240	03/25/17 10:53	TEK	TAL PHX

Client Sample ID: Building K Room 802 Sink 2

Lab Sample ID: 550-79402-62

Date Collected: 03/15/17 08:50

Matrix: Drinking Water

Date Received: 03/16/17 16:15

Prep Type	Batch Type	Batch Method	Run	Dilution Factor	Batch Number	Prepared or Analyzed	Analyst	Lab
Total/NA	Prep	200.8			113253	03/25/17 15:09	EXZ	TAL PHX
Total/NA	Analysis	200.8		1	113734	03/30/17 18:39	TEK	TAL PHX

Client Sample ID: Building K Room 802 Sink 3

Lab Sample ID: 550-79402-63

Date Collected: 03/15/17 08:51

Matrix: Drinking Water

Date Received: 03/16/17 16:15

Prep Type	Batch Type	Batch Method	Run	Dilution Factor	Batch Number	Prepared or Analyzed	Analyst	Lab
Total/NA	Prep	200.8			113253	03/25/17 15:09	EXZ	TAL PHX
Total/NA	Analysis	200.8		1	113734	03/30/17 19:04	TEK	TAL PHX

Client Sample ID: Building K Room 802 Sink 4

Lab Sample ID: 550-79402-64

Date Collected: 03/15/17 08:53

Matrix: Drinking Water

Date Received: 03/16/17 16:15

Prep Type	Batch Type	Batch Method	Run	Dilution Factor	Batch Number	Prepared or Analyzed	Analyst	Lab
Total/NA	Prep	200.8			113253	03/25/17 15:09	EXZ	TAL PHX
Total/NA	Analysis	200.8		1	113734	03/30/17 18:47	TEK	TAL PHX

Client Sample ID: Building K Room 802 Source

Lab Sample ID: 550-79402-65

Date Collected: 03/15/17 08:54

Matrix: Drinking Water

Date Received: 03/16/17 16:15

Prep Type	Batch Type	Batch Method	Run	Dilution Factor	Batch Number	Prepared or Analyzed	Analyst	Lab
Total/NA	Prep	200.8			113253	03/25/17 15:09	EXZ	TAL PHX
Total/NA	Analysis	200.8		1	113734	03/30/17 18:52	TEK	TAL PHX

Laboratory References:

TAL PHX = TestAmerica Phoenix, 4625 East Cotton Ctr Blvd, Suite 189, Phoenix, AZ 85040, TEL (602)437-3340

Accreditation/Certification Summary

Client: Arizona Dept of Environmental Quality
Project/Site: Pb in DW/Creighton School District

TestAmerica Job ID: 550-79402-1
SDG: Creighton School Confirmation Sampling

Laboratory: TestAmerica Phoenix

Unless otherwise noted, all analytes for this laboratory were covered under each accreditation/certification below.

Authority	Program	EPA Region	Identification Number	Expiration Date
Arizona	State Program	9	AZ0728	06-09-17
Analysis Method	Prep Method	Matrix	Analyte	

Method Summary

Client: Arizona Dept of Environmental Quality
Project/Site: Pb in DW/Creighton School District

TestAmerica Job ID: 550-79402-1
SDG: Creighton School Confirmation Sampling

Method	Method Description	Protocol	Laboratory
200.8	Metals (ICP/MS)	EPA	TAL PHX

Protocol References:

EPA = US Environmental Protection Agency

Laboratory References:

TAL PHX = TestAmerica Phoenix, 4625 East Cotton Ctr Blvd, Suite 189, Phoenix, AZ 85040, TEL (602)437-3340

19402

Lead In Schools Confirmation Sampling Log

School District: Creighton school district

School Name: Creighton schools

Building Name/Number/Year Built: CC

Sample Collector Name and Phone Number: Jim McVey 602-816-2849

	Fountain/faucet name location	Sample ID number	Sample ID	Collection Time	Collection Date	
1	LIBRARY office sink	LIBRARY office	ID-1	8:46	3-14-2017	-01
2	LIBRARY office sink	LIBRARY office	flush	8:48	3-14-2017	-02
3	Room 203 Sink	203	203	8:52	3-14-2017	-03
4	Room 211 faucet	faucet 211		8:57	3-14-2017	-04
5	Room 211 kitchen fountain	fountain 211		8:57	3-14-2017	-05
6	Room 210 fountain	210 fountain		9:01	3-14-2017	-06
7	Room 210 faucet	210 faucet		9:01	3-14-2017	-07
8	Room 213 faucet	213 faucet		9:04	3-14-2017	-08
9	Room 213 fountain	213 fountain		9:04	3-14-2017	-09
10	Room 212 faucet	212 faucet		9:06	3-14-2017	-10
11	Room 217 fountain	217 fountain		9:06	3-14-2017	-11
12	South Side fountain	East	2	9:11	3-14-2017	-12
13	South Side fountain	West	1	Broken	3-14-2017	
14	214 fountain	214 fountain		9:29	3-14-2017	-13
15	214 faucet sink	214 faucet		9:29	3-14-2017	-14
16	214 Restroom Sink	214 Restroom sink		9:32	3-14-2017	-15
17	215 faucet	215 faucet		9:34	3-14-2017	-16
18	215 fountain	215 fountain		9:34	3-14-2017	-17
19	216 faucet	216 faucet		9:37	3-14-2017	-18
20	216 fountain	216 fountain		9:37	3-14-2017	-19
21	LIBRARY office sink	1	D-2	8:59	3-15-2017	-20
22	LIBRARY office sink	2	D-2	9:00	3-15-2017	-21
23	LIBRARY office sink	3	D-2	9:01	3-15-2017	-22
24	LIBRARY office sink	4	D-2	9:02	3-15-2017	-23
25	LIBRARY office sink	Source		9:03	3-15-2017	-24
26						
27						
28						
29						
30						
31						
32						
33						
34						
35						
36						
37						
38						
39						
40						

550-79402 Chain of Custody

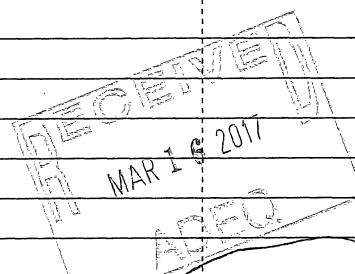

3-16-17

1615

24.2°C

CDU

These samples were collected for

uses only and are not to be used for compliance determinations

Lead In Schools Confirmation Sampling Log

17402

School District: Creighton School District

School Name: Creighton elementary

Building Name/Number/Year Built: I

Sample Collector Name and Phone Number: Jim McVey 652-216-2849

	Fountain/faucet name location	Sample ID number	Sample ID	Collection Time	Collection Date	
1	East side hose bib	1	ID	8:07	3-14-2017	-25
2	East side hose bib	2	Flush	8:10	3-14-2017	-26
3	East side hose bib	1	D-2	8:41	3-15-2017	-27
4	East side hose bib	2	D-2	8:42	3-15-2017	-28
5	East side hose bib	3	D-2	8:43	3-15-2017	-29
6	East side hose bib	4	D-2	8:43	3-15-2017	-30
7	East side hose bib	Source	Source	8:44	3-15-2017	-31
8						
9						
10						
11						
12						
13						
14						
15						
16						
17						
18						
19						
20						
21						
22						
23						
24						
25						
26						
27						
28						
29						
30						
31						
32						
33						
34						
35						
36						
37						
38						
39						
40						

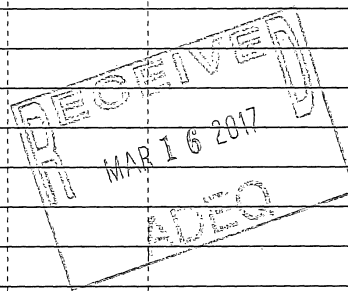

These samples were collected for screening purposes only and are not to be used for compliance determinations

Lead In Schools Confirmation Sampling Log

79402

School District: Creighton School District

School Name: Creighton Elementary

Building Name/Number/Year Built: E

Sample Collector Name and Phone Number: Jim McVey 602-316-2849

	Fountain/faucet name location	Sample ID number	Sample ID	Collection Time	Collection Date	
1	NORTH Fountains	1		7:40	3-14-2017	-32
2	NORTH Fountains	2		7:40	3-14-2017	-33
3	NORTH Fountains	3		7:40	3-14-2017	-34
4	NORTH Fountains	4		7:40	3-14-2017	-35
5	WEST Fountains	1	ID 1	7:46	3-14-2017	-36
6	WEST Fountains	WEST # 2		7:46	3-14-2017	-37
7	WEST Fountains	1	ID 105	7:48	3-14-2017	-38
8	WEST Fountains					
9	WEST Fountains Day 2	west fountain 2	D-2	8:16	3-15-2017	-39
10	WEST Fountains Day 2	west fountain 2	P-2	8:18	3-15-2017	-40
11	WEST Fountains Day 2	west fountain 2	D-2	8:19	3-15-2017	-41
12	WEST Fountains Day 2	west fountain 2	P-2	8:20	3-15-2017	-42
13	WEST Fountains Day 2	west fountain 2	Source	8:21	3-15-2017	-43
14						
15						
16						
17						
18						
19						
20						
21						
22						
23						
24						
25						
26						
27						
28						
29						
30						
31						
32						
33						
34						
35						
36						
37						
38						
39						
40						

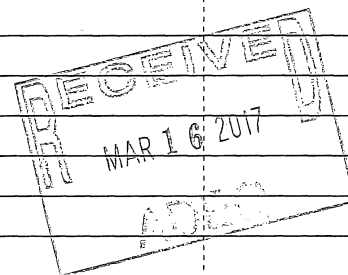

These samples were collected for screening purposes only and are not to be used for compliance determinations

Lead In Schools Confirmation Sampling Log

29402

School District: Creighton School District					
School Name: Creighton Elementary					
Building Name/Number/Year Built: F					
Sample Collector Name and Phone Number: Jim McKey 607-216-2849					
	Fountain/faucet name location	Sample ID number	Sample ID	Collection Time	Collection Date
1	East Side Fountain	1 #1 East		7:58	3-14-2017
2	East Side Fountain	2	ID 1	7:58	3-14-2017
3					
4	East side fountain	2	ID flush	8:00	3-14-2017
5	East Side Fountain	Fountain 1	D-2	8:30	3-15-2017
6	East Side Fountain	Fountain 2	D-2	8:32	3-15-2017
7	East Side Fountain	Fountain 3	D-2	8:33	3-15-2017
8	East side fountain	Fountain 4	D-2	8:34	3-15-2017
9	East Side Fountain	Fountain 7	Source	8:35	3-15-2017
10					
11					
12					
13					
14					
15					
16					
17					
18					
19					
20					
21					
22					
23					
24					
25					
26					
27					
28					
29					
30					
31					
32					
33					
34					
35					
36					
37					
38					
39					
40					

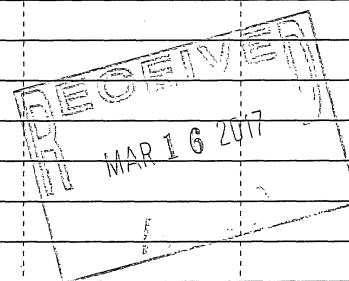

These samples were collected for screening purposes only and are not to be used for compliance determinations

Lead In Schools Confirmation Sampling Log

791402

School District: Creighton School DistrictSchool Name: Creighton ElementaryBuilding Name/Number/Year Built: KSample Collector Name and Phone Number: Jim McKey 602-316-2849

	Fountain/faucet name location	Sample ID number	Sample ID	Collection Time	Collection Date	
1	800 women's Restroom	East		8:15	3-14-2017	-52
2	800 women's Restroom	West		8:16	3-14-2017	-53
3	Fountains North Side	NORTH 1	1	8:16	3-14-2017	-54
4	Fountains North Side	NORTH 2	2	8:17	3-14-2017	-55
5	Room 804 faucet	804 1	1	8:20	3-14-2017	-56
6	Room 803 faucet	803 1	1	8:20	3-14-2017	-57
7	Boys' Restroom Sink	East	1	BROKEN	3-14-2017	-58
8	Boys' Restroom Sink	West	2	8:24	3-14-2017	-59
9	Room 802 Sink	Sink	ID 1	8:34	3-14-2017	-60
10	Room 802 Sink	Sink	Flush	8:35	3-14-2017	-61
11	Room 802 Sink	Sink 1	D-2	8:52	3-15-2017	-62
12	Room 802 Sink	Sink 2	D-2	8:50	3-15-2017	-63
13	Room 802 Sink	Sink 3	D-2	8:51	3-15-2017	-64
14	Room 802 Sink	Sink 4	D-2	8:53	3-15-2017	-65
15	Room 802 Sink	Sink	Source	8:54	3-15-2017	-66
16						
17						
18						
19						
20						
21						
22						
23						
24						
25						
26						
27						
28						
29						
30						
31						
32						
33						
34						
35						
36						
37						
38						
39						
40						

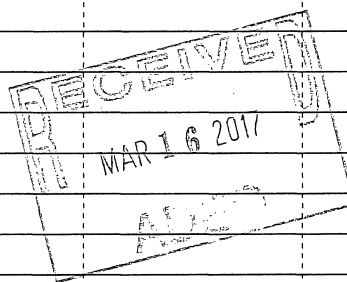

These samples were collected for screening purposes only and are not to be used for compliance determinations

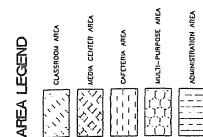

**BUILDING 'C' -
FLOOR PLAN**

ADMINISTRATIVE	= 202 S.F.
CLASSROOM	= 6,399 S.F.
GROSS BLDG	S.F. = 13,425 S.F.

SW
NE
SE
NW

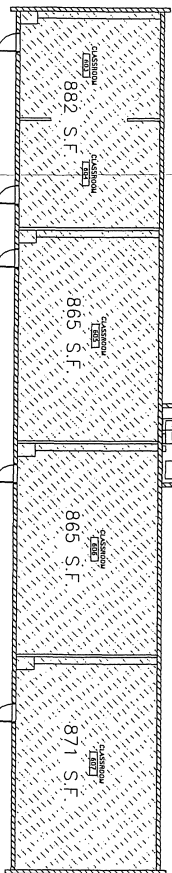
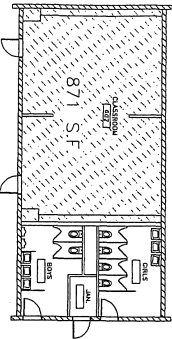
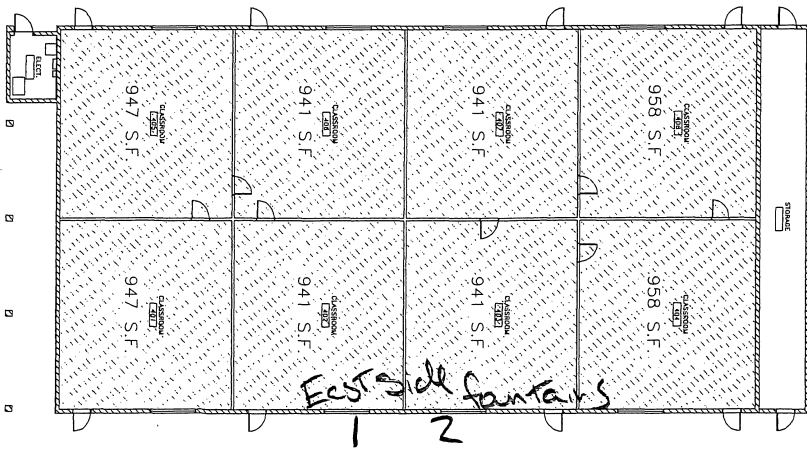
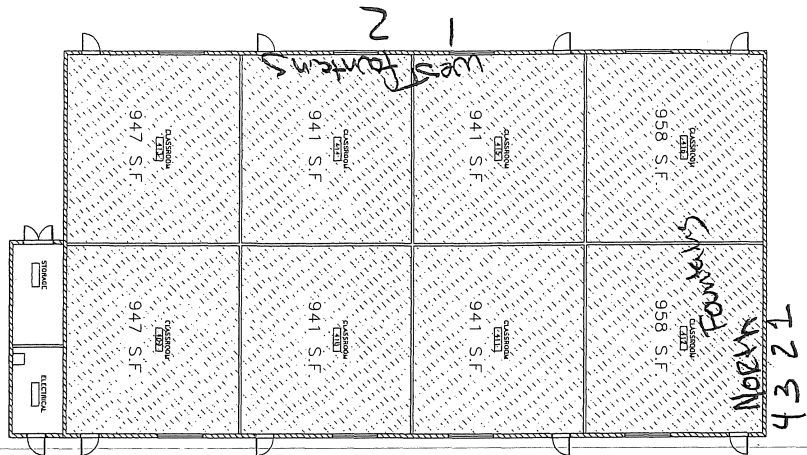

AREA LEGEND

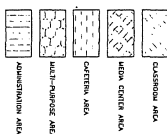

NOTES

A222

Sheet No.

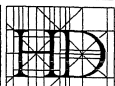

Hofmann-Dietz Architects, Ltd.
Planners & Construction Managers
459 N. Gilbert Road, Suite C-200, Gilbert, AZ 85234 / (480) 833-8800 FAX: (480) 833-8800
BUILDINGS 'E', 'F', 'G' AND 'H' -
FLOOR PLANS

SFB
SET

DATE: 11/20/17
BY: JAC
CHECKED: [Signature]
REVIEWED: [Signature]

ADDITIONS AND RENOVATIONS TO
CREIGHTON ELEMENTARY SCHOOL
2802 EAST MCDOWELL ROAD
PHOENIX, ARIZONA 85016
CREIGHTON ELEMENTARY SCHOOL DISTRICT NO. 14



- 1
- 2
- 3
- 4
- 5
- 6
- 7
- 8
- 9
- 10
- 11
- 12
- 13
- 14

REIGHTON SCHOOL MAP

Transportation

Handwritten note: "Handwritten note: ..."

K-2 Playground (NP) 3-5 Playground (NP)

Boys	Girls
505	505
506	506
507	507
508	508
509	509
510	510
511	511
512	512
513	513
514	514
515	515
516	516
517	517

Boys	Girls
505	505
506	506
507	507
508	508
509	509
510	510
511	511
512	512
513	513
514	514
515	515
516	516
517	517

301	302	303	304	305
306	307	308	309	310
311	312	313	314	315
316	317	318	319	320
321	322	323	324	325
326	327	328	329	330
331	332	333	334	335
336	337	338	339	340
341	342	343	344	345
346	347	348	349	350
351	352	353	354	355
356	357	358	359	360
361	362	363	364	365
366	367	368	369	370
371	372	373	374	375
376	377	378	379	380
381	382	383	384	385
386	387	388	389	390
391	392	393	394	395
396	397	398	399	400
401	402	403	404	405
406	407	408	409	410
411	412	413	414	415
416	417	418	419	420
421	422	423	424	425
426	427	428	429	430
431	432	433	434	435
436	437	438	439	440
441	442	443	444	445
446	447	448	449	450
451	452	453	454	455
456	457	458	459	460
461	462	463	464	465
466	467	468	469	470
471	472	473	474	475
476	477	478	479	480
481	482	483	484	485
486	487	488	489	490
491	492	493	494	495
496	497	498	499	500

201	202	203	204	205
206	207	208	209	210
211	212	213	214	215
216	217	218	219	220
221	222	223	224	225
226	227	228	229	230
231	232	233	234	235
236	237	238	239	240
241	242	243	244	245
246	247	248	249	250
251	252	253	254	255
256	257	258	259	260
261	262	263	264	265
266	267	268	269	270
271	272	273	274	275
276	277	278	279	280
281	282	283	284	285
286	287	288	289	290
291	292	293	294	295
296	297	298	299	300

101	102	103	104	105
106	107	108	109	110
111	112	113	114	115
116	117	118	119	120
121	122	123	124	125
126	127	128	129	130
131	132	133	134	135
136	137	138	139	140
141	142	143	144	145
146	147	148	149	150
151	152	153	154	155
156	157	158	159	160
161	162	163	164	165
166	167	168	169	170
171	172	173	174	175
176	177	178	179	180
181	182	183	184	185
186	187	188	189	190
191	192	193	194	195
196	197	198	199	200

109	110	111
112	113	114
115	116	117
118	119	120
121	122	123
124	125	126
127	128	129
130	131	132
133	134	135
136	137	138
139	140	141
142	143	144
145	146	147
148	149	150
151	152	153
154	155	156
157	158	159
160	161	162
163	164	165
166	167	168
169	170	171
172	173	174
175	176	177
178	179	180
181	182	183
184	185	186
187	188	189
190	191	192
193	194	195
196	197	198
199	200	201

Handwritten note: "Handwritten note: ..."

Handwritten note: "Handwritten note: ..."

Handwritten note: "Handwritten note: ..."

Handwritten note: "Handwritten note: ..."

Information List Contacts

First	Last
✓ Alicia	Reuter
✗ Anakaren	Lemus
✓ Calvinia	Ashley
✓ Candice	Engram
✓ Carolyn	Davis
✓ Christina	Vega
✓ Christine	Andert
✓ Cina	Sheffield
Danese	Cameron
James	Bustead
Jeremiah	Weiner
Jessica	Lange
✓ Lamo	LeMoine
Margaret	Frantz
Maria	Ruvalcaba
Marianne	Frausto
Martina	Lomas
Mary	Zanga
Monica	Hubbard
Nancy	Wrona
✗ Ramona	Rodriguez
✓ Raymundo	Ortega
✓ Robyne	Clark
✓ Samantha	Lee
✓ Sandy	Chismark
✓ Sylvia	Nelson
✓ Tara	Ousley
✓ Tawnya	Cook
✓ Vicki	Larrabee

partial submitted

waiting for her

done to her list

emailed picture to her sent

ask Jim contr & procurement

done

done

done

done

done

done

nothing

call

Login Sample Receipt Checklist

Client: Arizona Dept of Environmental Quality

Job Number: 550-79402-1

SDG Number: Creighton School Confirmation Sampling

Login Number: 79402

List Number: 1

Creator: Doerr, Bret C

List Source: TestAmerica Phoenix

Question	Answer	Comment
Radioactivity wasn't checked or is \leq background as measured by a survey meter.	True	
The cooler's custody seal, if present, is intact.	True	
Sample custody seals, if present, are intact.	True	
The cooler or samples do not appear to have been compromised or tampered with.	True	
Samples were received on ice.	False	Thermal preservation not required.
Cooler Temperature is acceptable.	True	
Cooler Temperature is recorded.	True	
COC is present.	True	
COC is filled out in ink and legible.	True	
COC is filled out with all pertinent information.	True	
Is the Field Sampler's name present on COC?	True	
There are no discrepancies between the containers received and the COC.	True	
Samples are received within Holding Time (excluding tests with immediate HTs)	True	
Sample containers have legible labels.	True	
Containers are not broken or leaking.	True	
Sample collection date/times are provided.	True	
Appropriate sample containers are used.	True	
Sample bottles are completely filled.	True	
Sample Preservation Verified.	True	
There is sufficient vol. for all requested analyses, incl. any requested MS/MSDs	True	
Containers requiring zero headspace have no headspace or bubble is $<6\text{mm}$ (1/4").	True	
Multiphasic samples are not present.	True	
Samples do not require splitting or compositing.	True	
Residual Chlorine Checked.	N/A	Check done at department level as required.