

David A. Burchard
Arizona Department of Environmental Quality, PHX
1110 W. Washington Street
Phoenix, AZ 85007

Project: School Lead Testing Screening
Project Number: Sunnyslope

Reported:
05/24/17 16:54

Analyte

A1021-01 (7051448-01) Drinking Water (Grab) Sampled: 05/09/17 05:15 Received: 05/11/17 10:51

Analyte	Result	PQL	Units	Dilution	Batch	Prepared	Analyzed	Method	Notes
Legend Technical Services of Arizona, Inc.									

Total Metals

Lead	<5.0	5.0	ug/L	1	B7E1636	05/19/17 11:23	05/20/17 01:12	EPA 200.8	
------	------	-----	------	---	---------	----------------	----------------	-----------	--

B1022-02 (7051448-02) Drinking Water (Grab) Sampled: 05/09/17 05:20 Received: 05/11/17 10:51

Analyte	Result	PQL	Units	Dilution	Batch	Prepared	Analyzed	Method	Notes
Legend Technical Services of Arizona, Inc.									

Total Metals

Lead	<5.0	5.0	ug/L	1	B7E1636	05/19/17 11:23	05/20/17 01:16	EPA 200.8	
------	------	-----	------	---	---------	----------------	----------------	-----------	--

D1024-04 (7051448-03) Drinking Water (Grab) Sampled: 05/09/17 00:00 Received: 05/11/17 10:51

Analyte	Result	PQL	Units	Dilution	Batch	Prepared	Analyzed	Method	Notes
Legend Technical Services of Arizona, Inc.									

Total Metals

Lead	<5.0	5.0	ug/L	1	B7E1636	05/19/17 11:23	05/20/17 01:19	EPA 200.8	
------	------	-----	------	---	---------	----------------	----------------	-----------	--

C1023-03 (7051448-04) Drinking Water (Grab) Sampled: 05/09/17 05:23 Received: 05/11/17 10:51

Analyte	Result	PQL	Units	Dilution	Batch	Prepared	Analyzed	Method	Notes
Legend Technical Services of Arizona, Inc.									

Total Metals

Lead	<5.0	5.0	ug/L	1	B7E1637	05/19/17 11:28	05/20/17 01:50	EPA 200.8	
------	------	-----	------	---	---------	----------------	----------------	-----------	--

Sample Condition Upon Receipt:

Temperature: 28.20 °C
All samples were received in acceptable condition unless noted otherwise in the case narrative.

Case Narrative:

Holding Times: All holding times were met unless otherwise qualified.
QA/QC Criteria: All analyses met method requirements unless otherwise qualified.
Accreditations: AZ(PHX)0004, AZ(TUC)0004, AIHA#102982, CDC ELITE Member.
Accreditation is applicable only to the test methods specified on each scope of accreditation held by LEGEND.
Comments: There were no problems encountered during the processing of the samples, unless otherwise noted.
All samples were analyzed on a "wet" basis unless designated as "dry weight".

Lead samples are preserved with Nitric acid upon receipt at the laboratory. However, some samples were analyzed prior to the 16 hour preservation waiting period due to urgency of analysis, per the client's request. Results are not for compliance purpose.

Legend Technical Services of Arizona, Inc.

The results in this report apply to the samples analyzed in accordance with the chain of custody document. This analytical report must be reproduced in its entirety.

Anna Teter

Client Services Representative

Phone Number: (602) 324-6100

Page 1 of 7

Notes and Definitions

ADEQ Public School Drinking Water Lead Screening Program
Sampling Plan & Collection Log

Collection Log
for experienced sample collectors

Complete copy of this form for each sample collected. Your drinking water sample cannot be tested unless a copy of this form is shipped to the lab with each sample. In addition, the sample cannot be tested unless the Sample Identification Number matches the number on the sample container label.

☒ Check this box to confirm that **water had not been used at this tap or other taps in the area for 6 hours** and **no** flushing was done prior to sampling

Name of School District	WASHINGTON ELEMENTARY DISTRICT
School Name	SUNNYSLOPE
Building (name/number)	A1021
Type of Fixture (tap, drinking fountain etc.)	DRINKING FOUNTAIN
Location of Fixture (example, room number)	HALLWAY OUTSIDE HEALTH OFFICE
Sample Identification Number (Write this number on the sample container and on this sheet)	A1021-01
Date of Collection	5-9-2017
Time of Collection	0515
Printed Name of Sample Collector	ANDRE ROBLEC
Signature Sample Collector	

Notes Sample collector:

For Lab use only	
Analyze this drinking water sample for lead	
Date and Time Lab received	
Signature	
Notes: Received @ Lab 5/11/17 1051 28.2°C	

For relinquishing samples upon delivery to labs only

Relinquished date and signature _____

These samples were collected for lead screening purposes only and cannot be used for compliance.

ADEQ Public School Drinking Water Lead Screening Program
Sampling Plan & Collection Log

Collection Log
for experienced sample collectors

Complete copy of this form for each sample collected. Your drinking water sample cannot be tested unless a copy of this form is shipped to the lab with each sample. In addition, the sample cannot be tested unless the Sample Identification Number matches the number on the sample container label.

☒ Check this box to confirm that **water had not been used at this tap or other taps in the area for 6 hours** and **no** flushing was done prior to sampling

Name of School District	WASHINGTON ELEMENTARY DISTRICT
School Name	SUNNYSLOPE
Building (name/number)	B1022
Type of Fixture (tap, drinking fountain etc.)	DRINKING FOUNTAIN
Location of Fixture (example, room number)	HALLWAY BY ROOM 230
Sample Identification Number (Write this number on the sample container and on this sheet)	B1022-02
Date of Collection	5-9-2017
Time of Collection	0520
Printed Name of Sample Collector	ANDRE ROBLES
Signature Sample Collector	

Notes Sample collector:

For Lab use only	
Analyze this drinking water sample for lead	
Date and Time Lab received	
Signature	
Notes:	

For relinquishing samples upon delivery to labs only

Relinquished date and signature _____

These samples were collected for lead screening purposes only and cannot be used for compliance.

<http://www.azdeq.gov/LeadScreeningProg>

Page 2 of 2

ADEQ Public School Drinking Water Lead Screening Program
Sampling Plan & Collection Log

7051448-04

Collection Log

for experienced sample collectors

Complete copy of this form for each sample collected. Your drinking water sample cannot be tested unless a copy of this form is shipped to the lab with each sample. In addition, the sample cannot be tested unless the Sample Identification Number matches the number on the sample container label.

- ☐ Check this box to confirm that **water had not been used at this tap or other taps in the area for 6 hours** and **no** flushing was done prior to sampling

Name of School District	WASHINGTON ELEMENTARY DISTRICT
School Name	SUNNYSLOPE
Building (name/number)	C1023
Type of Fixture (tap, drinking fountain etc.)	DRINKING FOUNTAIN
Location of Fixture (example, room number)	ROOM 301
Sample Identification Number (Write this number on the sample container and on this sheet)	C1023-03
Date of Collection	5-9-2017
Time of Collection	0523
Printed Name of Sample Collector	ANDRE ROBLES
Signature Sample Collector	

Notes Sample collector:

For Lab use only	
Analyze this drinking water sample for lead	
Date and Time Lab received	
Signature	
Notes:	

For relinquishing samples upon delivery to labs only

Relinquished date and signature _____

These samples were collected for lead screening purposes only and cannot be used for compliance.

<http://www.azdeq.gov/LeadScreeningProg>

Page 2 of 2

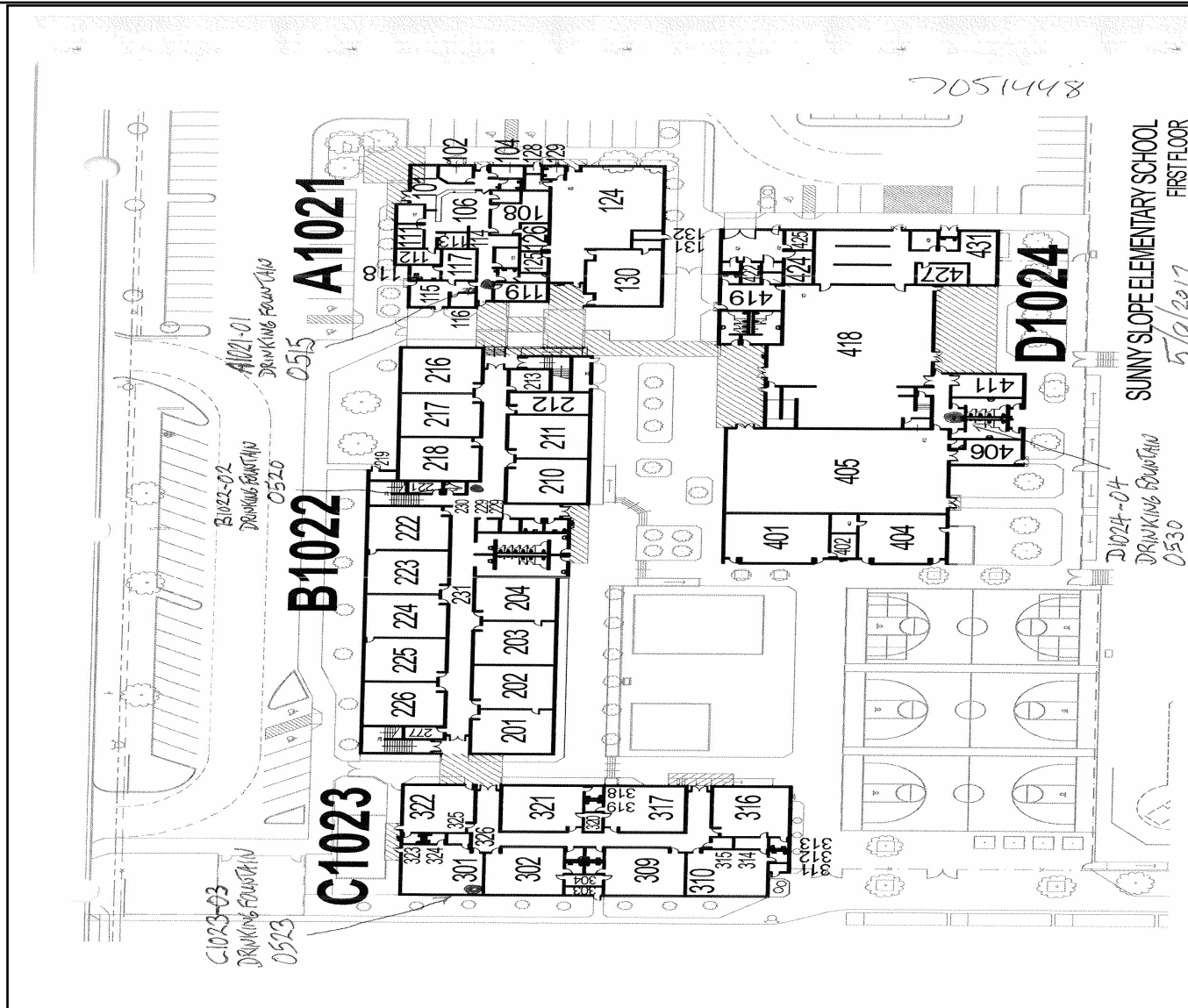

7051448-03

ADEQ Public School Drinking Water Lead Screening Program
Sampling Plan & Collection Log

Collection Log

for experienced sample collectors

Complete copy of this form for each sample collected. Your drinking water sample cannot be tested unless a copy of this form is shipped to the lab with each sample. In addition, the sample cannot be tested unless the Sample Identification Number matches the number on the sample container label.

☒ Check this box to confirm that **water had not been used at this tap or other taps in the area for 6 hours** and **no** flushing was done prior to sampling

Name of School District	WASHINGTON ELEMENTARY DISTRICT
School Name	SUNNYSLOPE
Building (name/number)	D1024
Type of Fixture (tap, drinking fountain etc.)	DRINKING FOUNTAIN
Location of Fixture (example, room number)	HALLWAY BY GYM/CAFE RESTROOMS
Sample Identification Number (Write this number on the sample container and on this sheet)	D1024-04
Date of Collection	5-9-2017
Time of Collection	
Printed Name of Sample Collector	ANDRE ROBLES
Signature Sample Collector	

Notes Sample collector:

For Lab use only

Analyze this drinking water sample for lead	
Date and Time Lab received	
Signature	
Notes:	

For relinquishing samples upon delivery to labs only

Relinquished date and signature _____

These samples were collected for lead screening purposes only and cannot be used for compliance.

<http://www.azdeq.gov/LeadScreeningProg>

Page 2 of 2