

Scottsdale *Unified*
SCHOOL DISTRICT

Redfield Elementary School
New Hispanic Work Up
TRPA Systems July 20, 2009

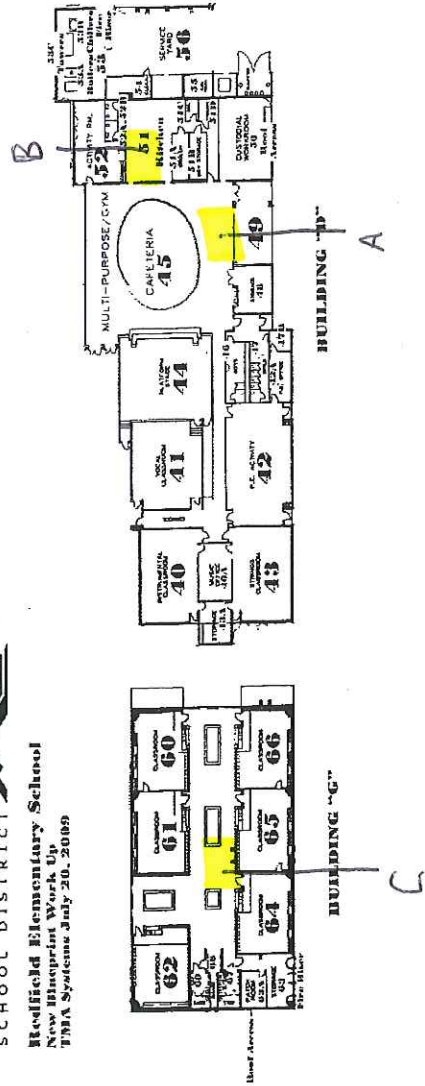



Water Quality Laboratory

8787 E. Hualapai Dr.
PO Box 25089
Scottsdale, AZ 85255

- CERTIFICATE OF ANALYSIS -

Krystal Heyer

City of Scottsdale

8787 E. Hualapai Drive

Scottsdale, AZ 85255

Sample ID: AH17-0627

Location ID: Lead in Schools

Lab # AB73667

Date Sampled: 03/20/2017

Time Sampled: 06:20

Date Received: 03/20/2017

Report Date: 04/13/2017

Location Description:

Redfield Elem- Bldg D Gym DF- A

| Test | Method | Result | Data Qualifier | DF | Units | PQL | Analysis Date |
|----------|-----------|--------|-------------------|------|-------|-----|------------------|
| Lead, Pb | EPA 200.8 | 1.4 | | 1.00 | ug/L | 1.0 | 04/07/2017 |

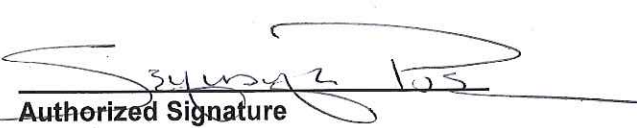
Authorized Signature
License #AZ0424



Water Quality Laboratory

8787 E. Hualapai Dr.
PO Box 25089
Scottsdale, AZ 85255

- CERTIFICATE OF ANALYSIS -

Krystal Heyer

City of Scottsdale

8787 E. Hualapai Drive

Scottsdale, AZ 85255

Sample ID: AH17-0628

Location ID: Lead in Schools

Lab # AB73668

Date Sampled: 03/20/2017

Time Sampled: 06:22

Date Received: 03/20/2017

Report Date: 04/13/2017

Location Description:

Redfield Elem- Bldg D Cafeteria Sink- B

| Test | Method | Result | Data Qualifier | DF | Units | PQL | Analysis Date |
|----------|-----------|--------|----------------|------|-------|-----|---------------|
| Lead, Pb | EPA 200.8 | 4.9 | | 1.00 | ug/L | 1.0 | 04/07/2017 |

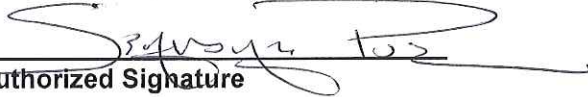
Authorized Signature
License #AZ0424



Water Quality Laboratory

8787 E. Hualapai Dr.
PO Box 25089
Scottsdale, AZ 85255

- CERTIFICATE OF ANALYSIS -

Krystal Heyer

City of Scottsdale

8787 E. Hualapai Drive

Scottsdale, AZ 85255

Sample ID: AH17-0629

Location ID: Lead in Schools

Lab # AB73669

Date Sampled: 03/20/2017

Time Sampled: 06:24

Date Received: 03/20/2017

Report Date: 04/13/2017

Location Description:

Redfield Elem- Bldg G DF- C

| Test | Method | Result | Data Qualifier | DF | Units | PQL | Analysis Date |
|----------|-----------|--------|-------------------|------|-------|-----|------------------|
| Lead, Pb | EPA 200.8 | < 1.0 | | 1.00 | ug/L | 1.0 | 04/07/2017 |

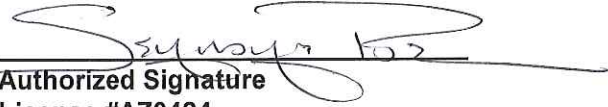
Authorized Signature
License #AZ0424



Water Quality Laboratory

8787 E. Hualapai Dr.
PO Box 25089
Scottsdale, AZ 85255

- CERTIFICATE OF ANALYSIS -

Lab # AB73670

Krystal Heyer

City of Scottsdale

8787 E. Hualapai Drive

Scottsdale, AZ 85255

Date Sampled: 03/20/2017

Time Sampled: 06:26

Date Received: 03/20/2017

Report Date: 04/13/2017

Sample ID: AH17-0630

Location Description:

Location ID: Lead in Schools

Redfield Elem- Bldg F RM38 DF- D

| Test | Method | Result | Data Qualifier | DF | Units | PQL | Analysis Date |
|----------|-----------|--------|-------------------|------|-------|-----|------------------|
| Lead, Pb | EPA 200.8 | < 1.0 | | 1.00 | ug/L | 1.0 | 04/07/2017 |

Authorized Signature
License #AZ0424



Water Quality Laboratory

8787 E. Hualapai Dr.
PO Box 25089
Scottsdale, AZ 85255

- CERTIFICATE OF ANALYSIS -

Lab # AB73671

Krystal Heyer

City of Scottsdale

8787 E. Hualapai Drive

Scottsdale, AZ 85255

Sample ID: AH17-0631

Location ID: Lead in Schools

Date Sampled: 03/20/2017

Time Sampled: 06:28

Date Received: 03/20/2017

Report Date: 04/13/2017

Location Description:

Redfield Elem- Bldg F Nurse DF- E

| Test | Method | Result | Data Qualifier | DF | Units | PQL | Analysis Date |
|----------|-----------|--------|-------------------|------|-------|-----|------------------|
| Lead, Pb | EPA 200.8 | < 1.0 | | 1.00 | ug/L | 1.0 | 04/07/2017 |

Authorized Signature
License #AZ0424



Water Quality Laboratory

8787 E. Hualapai Dr.
PO Box 25089
Scottsdale, AZ 85255

- CERTIFICATE OF ANALYSIS -

Krystal Heyer

City of Scottsdale

8787 E. Hualapai Drive

Scottsdale, AZ 85255

Sample ID: AH17-0632

Location ID: Lead in Schools

Lab # AB73672

Date Sampled: 03/20/2017

Time Sampled: 06:30

Date Received: 03/20/2017

Report Date: 04/13/2017

Location Description:

Redfield Elem- Bldg B RM36 DF- F

| Test | Method | Result | Data Qualifier | DF | Units | PQL | Analysis Date |
|----------|-----------|--------|-------------------|------|-------|-----|------------------|
| Lead, Pb | EPA 200.8 | 2.2 | | 1.00 | ug/L | 1.0 | 04/07/2017 |

Authorized Signature
License #AZ0424



Water Quality Laboratory

8787 E. Hualapai Dr.
PO Box 25089
Scottsdale, AZ 85255

- CERTIFICATE OF ANALYSIS -

Krystal Heyer

City of Scottsdale

8787 E. Hualapai Drive

Scottsdale, AZ 85255

Sample ID: AH17-0633

Location ID: Lead in Schools

Lab # AB73673

Date Sampled: 03/20/2017

Time Sampled: 06:32

Date Received: 03/20/2017

Report Date: 04/13/2017

Location Description:

Redfield Elem- Bldg A RR DF- G

| Test | Method | Result | Data Qualifier | DF | Units | PQL | Analysis Date |
|----------|-----------|--------|-------------------|------|-------|-----|------------------|
| Lead, Pb | EPA 200.8 | 1.0 | | 1.00 | ug/L | 1.0 | 04/07/2017 |

Authorized Signature
License #AZ0424



Water Quality Laboratory

8787 E. Hualapai Dr.
PO Box 25089
Scottsdale, AZ 85255

- CERTIFICATE OF ANALYSIS -

Krystal Heyer

City of Scottsdale

8787 E. Hualapai Drive

Scottsdale, AZ 85255

Sample ID: AH17-0634

Location ID: Lead in Schools

Lab # AB73674

Date Sampled: 03/20/2017

Time Sampled: 06:34

Date Received: 03/20/2017

Report Date: 04/13/2017

Location Description:

Redfield Elem- Bldg A RM4 DF- H

| Test | Method | Result | Data Qualifier | DF | Units | PQL | Analysis Date |
|----------|-----------|--------|-------------------|------|-------|-----|------------------|
| Lead, Pb | EPA 200.8 | 2.2 | | 1.00 | ug/L | 1.0 | 04/07/2017 |

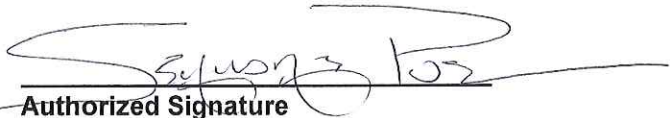
Authorized Signature
License #AZ0424