

## ANALYTICAL REPORT

TestAmerica Laboratories, Inc.

TestAmerica Phoenix

4625 East Cotton Ctr Blvd

Suite 189

Phoenix, AZ 85040

Tel: (602)437-3340

TestAmerica Job ID: 550-77246-1

TestAmerica Sample Delivery Group: McCartney

Client Project/Site: Pb in DW/Casa Grande Elem S.D.

For:

Arizona Dept of Environmental Quality

1110 W. Washington St., MC5415B-1

Phoenix, Arizona 85007

Attn: David A Burchard



Authorized for release by:

2/16/2017 1:39:50 PM

Susan Armijo, Project Manager II

(602)659-7664

[susan.armijo@testamericainc.com](mailto:susan.armijo@testamericainc.com)

### LINKS

Review your project  
results through

TotalAccess

Have a Question?



Visit us at:

[www.testamericainc.com](http://www.testamericainc.com)

*This report has been electronically signed and authorized by the signatory. Electronic signature is intended to be the legally binding equivalent of a traditionally handwritten signature.*

*Results relate only to the items tested and the sample(s) as received by the laboratory.*

# Table of Contents

Cover Page . . . . .	1
Table of Contents . . . . .	2
Definitions/Glossary . . . . .	3
Sample Summary . . . . .	4
Detection Summary . . . . .	5
Client Sample Results . . . . .	6
QC Sample Results . . . . .	7
QC Association Summary . . . . .	8
Lab Chronicle . . . . .	9
Certification Summary . . . . .	10
Method Summary . . . . .	11
Chain of Custody . . . . .	12
Receipt Checklists . . . . .	14



## Definitions/Glossary

Client: Arizona Dept of Environmental Quality  
Project/Site: Pb in DW/Casa Grande Elem S.D.

TestAmerica Job ID: 550-77246-1  
SDG: McCartney

### Glossary

Abbreviation	These commonly used abbreviations may or may not be present in this report.
α	Listed under the "D" column to designate that the result is reported on a dry weight basis
%R	Percent Recovery
CFL	Contains Free Liquid
CNF	Contains no Free Liquid
DER	Duplicate error ratio (normalized absolute difference)
Dil Fac	Dilution Factor
DL, RA, RE, IN	Indicates a Dilution, Re-analysis, Re-extraction, or additional Initial metals/anion analysis of the sample
DLC	Decision level concentration
MDA	Minimum detectable activity
EDL	Estimated Detection Limit
MDC	Minimum detectable concentration
MDL	Method Detection Limit
ML	Minimum Level (Dioxin)
NC	Not Calculated
ND	Not detected at the reporting limit (or MDL or EDL if shown)
PQL	Practical Quantitation Limit
QC	Quality Control
RER	Relative error ratio
RL	Reporting Limit or Requested Limit (Radiochemistry)
RPD	Relative Percent Difference, a measure of the relative difference between two points
TEF	Toxicity Equivalent Factor (Dioxin)
TEQ	Toxicity Equivalent Quotient (Dioxin)

## Sample Summary

Client: Arizona Dept of Environmental Quality  
Project/Site: Pb in DW/Casa Grande Elem S.D.

TestAmerica Job ID: 550-77246-1  
SDG: McCartney

Lab Sample ID	Client Sample ID	Matrix	Collected	Received
550-77246-1	1001	Drinking Water	02/06/17 06:23	02/09/17 10:30

1

2

3

4

5

6

7

8

9

10

11

12

13

## Detection Summary

Client: Arizona Dept of Environmental Quality  
Project/Site: Pb in DW/Casa Grande Elem S.D.

TestAmerica Job ID: 550-77246-1  
SDG: McCartney

**Client Sample ID: 1001**

**Lab Sample ID: 550-77246-1**

☐ No Detections.

1

2

3

4

5

6

7

8

9

10

11

12

13

This Detection Summary does not include radiochemical test results.

TestAmerica Phoenix

## Client Sample Results

Client: Arizona Dept of Environmental Quality  
Project/Site: Pb in DW/Casa Grande Elem S.D.

TestAmerica Job ID: 550-77246-1  
SDG: McCartney

**Client Sample ID: 1001**

**Date Collected: 02/06/17 06:23**

**Date Received: 02/09/17 10:30**

**Lab Sample ID: 550-77246-1**

**Matrix: Drinking Water**

**Method: 200.8 - Metals (ICP/MS)**

Analyte	Result	Qualifier	RL	Unit	D	Prepared	Analyzed	Dil Fac
Lead	ND		0.50	ppb		02/15/17 06:08	02/15/17 09:49	1

# QC Sample Results

Client: Arizona Dept of Environmental Quality  
Project/Site: Pb in DW/Casa Grande Elem S.D.

TestAmerica Job ID: 550-77246-1  
SDG: McCartney

## Method: 200.8 - Metals (ICP/MS)

Lab Sample ID: MB 550-110135/1-A  
Matrix: Water  
Analysis Batch: 110167

Client Sample ID: Method Blank  
Prep Type: Total/NA  
Prep Batch: 110135

Analyte	MB Result	MB Qualifier	RL	Unit	D	Prepared	Analyzed	Dil Fac
Lead	ND		0.50	ppb		02/15/17 06:08	02/15/17 09:40	1

Lab Sample ID: LCS 550-110135/4-A  
Matrix: Water  
Analysis Batch: 110167

Client Sample ID: Lab Control Sample  
Prep Type: Total/NA  
Prep Batch: 110135

Analyte	Spike Added	LCS Result	LCS Qualifier	Unit	D	%Rec	%Rec. Limits
Lead	100	90.2		ppb		90	85 - 115

Lab Sample ID: LCSD 550-110135/5-A  
Matrix: Water  
Analysis Batch: 110167

Client Sample ID: Lab Control Sample Dup  
Prep Type: Total/NA  
Prep Batch: 110135

Analyte	Spike Added	LCSD Result	LCSD Qualifier	Unit	D	%Rec	%Rec. Limits	RPD	RPD Limit
Lead	100	90.8		ppb		91	85 - 115	1	20

Lab Sample ID: 550-77246-1 MS  
Matrix: Drinking Water  
Analysis Batch: 110167

Client Sample ID: 1001  
Prep Type: Total/NA  
Prep Batch: 110135

Analyte	Sample Result	Sample Qualifier	Spike Added	MS Result	MS Qualifier	Unit	D	%Rec	%Rec. Limits
Lead	ND		100	86.2		ppb		86	70 - 130

Lab Sample ID: 550-77246-1 MSD  
Matrix: Drinking Water  
Analysis Batch: 110167

Client Sample ID: 1001  
Prep Type: Total/NA  
Prep Batch: 110135

Analyte	Sample Result	Sample Qualifier	Spike Added	MSD Result	MSD Qualifier	Unit	D	%Rec	%Rec. Limits	RPD	RPD Limit
Lead	ND		100	87.0		ppb		87	70 - 130	1	20

## QC Association Summary

Client: Arizona Dept of Environmental Quality  
Project/Site: Pb in DW/Casa Grande Elem S.D.

TestAmerica Job ID: 550-77246-1  
SDG: McCartney

### Metals

#### Prep Batch: 110135

Lab Sample ID	Client Sample ID	Prep Type	Matrix	Method	Prep Batch
550-77246-1	1001	Total/NA	Drinking Water	200.8	
MB 550-110135/1-A	Method Blank	Total/NA	Water	200.8	
LCS 550-110135/4-A	Lab Control Sample	Total/NA	Water	200.8	
LCSD 550-110135/5-A	Lab Control Sample Dup	Total/NA	Water	200.8	
550-77246-1 MS	1001	Total/NA	Drinking Water	200.8	
550-77246-1 MSD	1001	Total/NA	Drinking Water	200.8	

#### Analysis Batch: 110167

Lab Sample ID	Client Sample ID	Prep Type	Matrix	Method	Prep Batch
550-77246-1	1001	Total/NA	Drinking Water	200.8	110135
MB 550-110135/1-A	Method Blank	Total/NA	Water	200.8	110135
LCS 550-110135/4-A	Lab Control Sample	Total/NA	Water	200.8	110135
LCSD 550-110135/5-A	Lab Control Sample Dup	Total/NA	Water	200.8	110135
550-77246-1 MS	1001	Total/NA	Drinking Water	200.8	110135
550-77246-1 MSD	1001	Total/NA	Drinking Water	200.8	110135



## Lab Chronicle

Client: Arizona Dept of Environmental Quality  
Project/Site: Pb in DW/Casa Grande Elem S.D.

TestAmerica Job ID: 550-77246-1  
SDG: McCartney

**Client Sample ID: 1001**

**Date Collected: 02/06/17 06:23**

**Date Received: 02/09/17 10:30**

**Lab Sample ID: 550-77246-1**

**Matrix: Drinking Water**

Prep Type	Batch Type	Batch Method	Run	Dilution Factor	Batch Number	Prepared or Analyzed	Analyst	Lab
Total/NA	Prep	200.8			110135	02/15/17 06:08	SGO	TAL PHX
Total/NA	Analysis	200.8		1	110167	02/15/17 09:49	TEK	TAL PHX

### Laboratory References:

TAL PHX = TestAmerica Phoenix, 4625 East Cotton Ctr Blvd, Suite 189, Phoenix, AZ 85040, TEL (602)437-3340

## Certification Summary

Client: Arizona Dept of Environmental Quality  
Project/Site: Pb in DW/Casa Grande Elem S.D.

TestAmerica Job ID: 550-77246-1  
SDG: McCartney

### Laboratory: TestAmerica Phoenix

Unless otherwise noted, all analytes for this laboratory were covered under each certification below.

Authority	Program	EPA Region	Certification ID	Expiration Date
Arizona	State Program	9	AZ0728	06-09-17

Analysis Method	Prep Method	Matrix	Analyte
-----------------	-------------	--------	---------

## Method Summary

Client: Arizona Dept of Environmental Quality  
Project/Site: Pb in DW/Casa Grande Elem S.D.

TestAmerica Job ID: 550-77246-1  
SDG: McCartney

Method	Method Description	Protocol	Laboratory
200.8	Metals (ICP/MS)	EPA	TAL PHX

### Protocol References:

EPA = US Environmental Protection Agency

### Laboratory References:

TAL PHX = TestAmerica Phoenix, 4625 East Cotton Ctr Blvd, Suite 189, Phoenix, AZ 85040, TEL (602)437-3340

77246

**Collection Log**  
*for experienced sample collectors*

Complete copy of this form for each sample collected. Your drinking water sample cannot be tested unless a copy of this form is shipped to the lab with each sample. In addition, the sample cannot be tested unless the Sample Identification Number matches the number on the sample container label.

- ☒ Check this box to confirm that water had not been used at this tap or other taps in the area for 6 hours and no flushing was done prior to sampling

Name of School District	Casa Grande Elementary S.D.
School Name	McCartney
Building (name/number)	Main Hallway
Type of Fixture (tap, drinking fountain etc.)	Drinking fountain
Location of Fixture (example, room number)	
Sample Identification Number (ensure this number is also on the sample container)	1004
Date of Collection	2-6-17
Time of Collection	6:23
Printed Name of Sample Collector	Samuel Penner
Signature Sample Collector	Sam R

550-77246 Chain of Custody



Notes Sample collector:

For Lab use only	
Analyze this drinking water sample for lead	
Date and Time Lab received	
Signature	
Notes:	

For relinquishing samples upon delivery to labs only

Relinquished date and signature

2/9/17

*These samples were collected for lead screening purposes only and cannot be used for compliance.*

2/9/17 10:30  
fulfilled Ground

# McCormick Ranch Inventory

ASBESTOS HOT SPOTS  
NONE

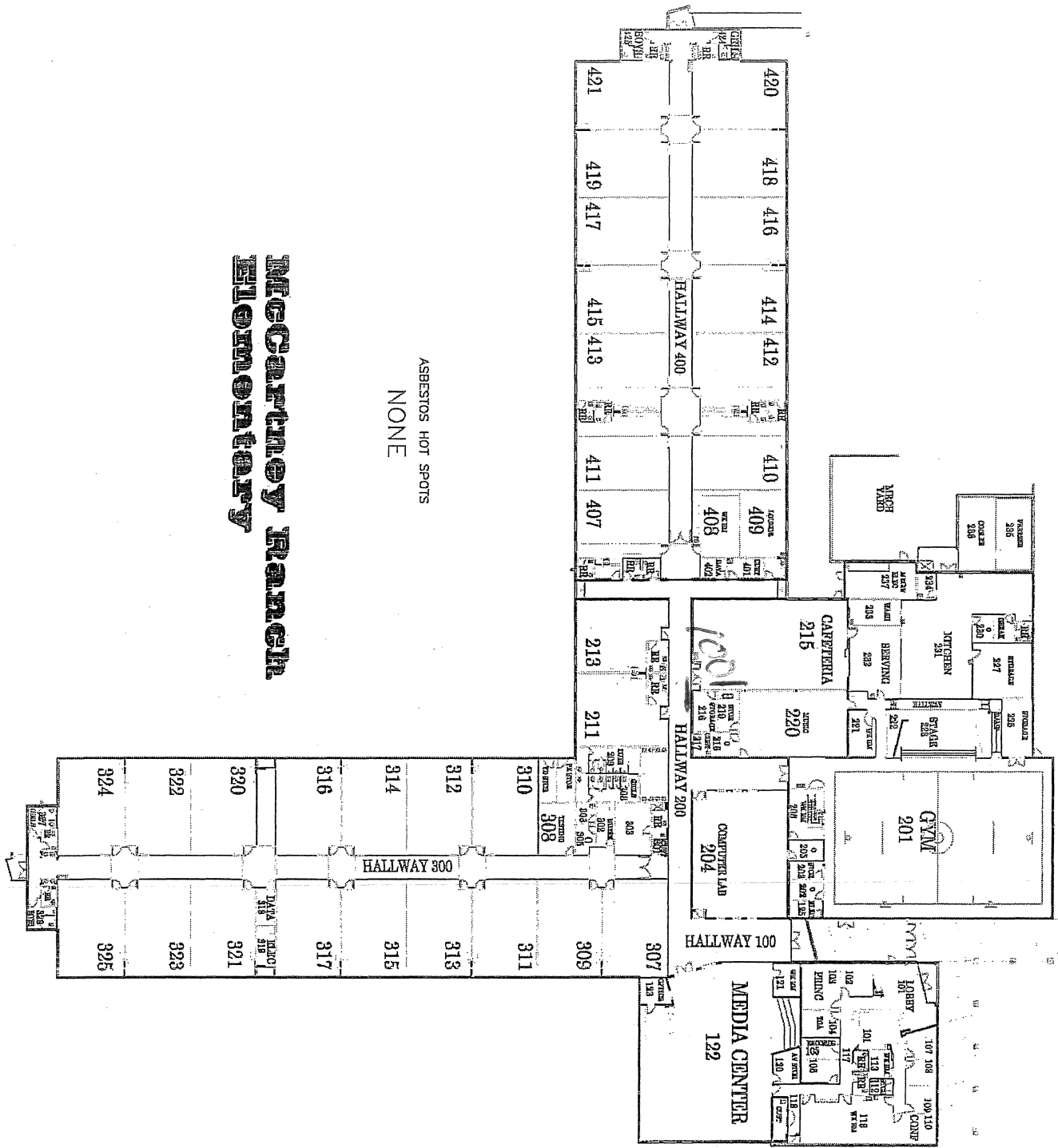

## Login Sample Receipt Checklist

Client: Arizona Dept of Environmental Quality

Job Number: 550-77246-1

SDG Number: McCartney

**Login Number: 77246**

**List Number: 1**

**Creator: Vilaboy, Monica**

**List Source: TestAmerica Phoenix**

Question	Answer	Comment
Radioactivity wasn't checked or is $\leq$ background as measured by a survey meter.	True	
The cooler's custody seal, if present, is intact.	True	
Sample custody seals, if present, are intact.	True	
The cooler or samples do not appear to have been compromised or tampered with.	True	
Samples were received on ice.	False	Thermal preservation not required.
Cooler Temperature is acceptable.	True	
Cooler Temperature is recorded.	True	
COC is present.	True	
COC is filled out in ink and legible.	True	
COC is filled out with all pertinent information.	True	
Is the Field Sampler's name present on COC?	True	
There are no discrepancies between the containers received and the COC.	True	
Samples are received within Holding Time (excluding tests with immediate HTs)	True	
Sample containers have legible labels.	True	
Containers are not broken or leaking.	True	
Sample collection date/times are provided.	True	
Appropriate sample containers are used.	True	
Sample bottles are completely filled.	True	
Sample Preservation Verified.	True	
There is sufficient vol. for all requested analyses, incl. any requested MS/MSDs	True	
Containers requiring zero headspace have no headspace or bubble is $<6\text{mm}$ (1/4").	True	
Multiphasic samples are not present.	True	
Samples do not require splitting or compositing.	True	
Residual Chlorine Checked.	N/A	Check done at department level as required.