

TestAmerica

THE LEADER IN ENVIRONMENTAL TESTING

ANALYTICAL REPORT

TestAmerica Laboratories, Inc.

TestAmerica Phoenix

4625 East Cotton Ctr Blvd

Suite 189

Phoenix, AZ 85040

Tel: (602)437-3340

TestAmerica Job ID: 550-77247-1

TestAmerica Sample Delivery Group: Ironwood

Client Project/Site: Pb in DW/Casa Grande S.D. 4

For:

Arizona Dept of Environmental Quality

1110 W. Washington St., MC5415B-1

Phoenix, Arizona 85007

Attn: David A Burchard



Authorized for release by:

2/16/2017 1:49:23 PM

Susan Armijo, Project Manager II

(602)659-7664

susan.armijo@testamericainc.com

LINKS

Review your project
results through

TotalAccess

Have a Question?



Visit us at:

www.testamericainc.com

This report has been electronically signed and authorized by the signatory. Electronic signature is intended to be the legally binding equivalent of a traditionally handwritten signature.

Results relate only to the items tested and the sample(s) as received by the laboratory.

Table of Contents

Cover Page	1
Table of Contents	2
Definitions/Glossary	3
Case Narrative	4
Sample Summary	5
Detection Summary	6
Client Sample Results	7
QC Sample Results	8
QC Association Summary	9
Lab Chronicle	10
Certification Summary	11
Method Summary	12
Chain of Custody	13
Receipt Checklists	16



Definitions/Glossary

Client: Arizona Dept of Environmental Quality
Project/Site: Pb in DW/Casa Grande S.D. 4

TestAmerica Job ID: 550-77247-1
SDG: Ironwood

Glossary

Abbreviation	These commonly used abbreviations may or may not be present in this report.
α	Listed under the "D" column to designate that the result is reported on a dry weight basis
%R	Percent Recovery
CFL	Contains Free Liquid
CNF	Contains no Free Liquid
DER	Duplicate error ratio (normalized absolute difference)
Dil Fac	Dilution Factor
DL, RA, RE, IN	Indicates a Dilution, Re-analysis, Re-extraction, or additional Initial metals/anion analysis of the sample
DLC	Decision level concentration
MDA	Minimum detectable activity
EDL	Estimated Detection Limit
MDC	Minimum detectable concentration
MDL	Method Detection Limit
ML	Minimum Level (Dioxin)
NC	Not Calculated
ND	Not detected at the reporting limit (or MDL or EDL if shown)
PQL	Practical Quantitation Limit
QC	Quality Control
RER	Relative error ratio
RL	Reporting Limit or Requested Limit (Radiochemistry)
RPD	Relative Percent Difference, a measure of the relative difference between two points
TEF	Toxicity Equivalent Factor (Dioxin)
TEQ	Toxicity Equivalent Quotient (Dioxin)

Case Narrative

Client: Arizona Dept of Environmental Quality
Project/Site: Pb in DW/Casa Grande S.D. 4

TestAmerica Job ID: 550-77247-1
SDG: Ironwood

Job ID: 550-77247-1

Laboratory: TestAmerica Phoenix

Narrative

Job Narrative 550-77247-1

Comments

No additional comments.

Receipt

The samples were received on 2/9/2017 10:30 AM; the samples arrived in good condition, properly preserved and, where required, on ice. The temperature of the cooler at receipt was 21.0° C.

Receipt Exceptions

The sampling time on the chain of custody does not match the time given on the container for sample 2. We have proceeded with the time written on the COC.

Metals

No analytical or quality issues were noted, other than those described in the Definitions/Glossary page.

Sample Summary

Client: Arizona Dept of Environmental Quality
Project/Site: Pb in DW/Casa Grande S.D. 4

TestAmerica Job ID: 550-77247-1
SDG: Ironwood

Lab Sample ID	Client Sample ID	Matrix	Collected	Received
550-77247-1	1001	Drinking Water	02/06/17 06:03	02/09/17 10:30
550-77247-2	1001	Drinking Water	02/07/17 06:10	02/09/17 10:30

1

2

3

4

5

6

7

8

9

10

11

12

13

14

Detection Summary

Client: Arizona Dept of Environmental Quality
Project/Site: Pb in DW/Casa Grande S.D. 4

TestAmerica Job ID: 550-77247-1
SDG: Ironwood

Client Sample ID: 1001

Lab Sample ID: 550-77247-1

Analyte	Result	Qualifier	RL	Unit	Dil Fac	D	Method	Prep Type
Lead	0.91		0.50	ppb	1		200.8	Total/NA

Client Sample ID: 1001

Lab Sample ID: 550-77247-2

No Detections.

This Detection Summary does not include radiochemical test results.

TestAmerica Phoenix

Client Sample Results

Client: Arizona Dept of Environmental Quality
Project/Site: Pb in DW/Casa Grande S.D. 4

TestAmerica Job ID: 550-77247-1
SDG: Ironwood

Client Sample ID: 1001

Date Collected: 02/06/17 06:03

Date Received: 02/09/17 10:30

Lab Sample ID: 550-77247-1

Matrix: Drinking Water

Method: 200.8 - Metals (ICP/MS)

Analyte	Result	Qualifier	RL	Unit	D	Prepared	Analyzed	Dil Fac
Lead	0.91		0.50	ppb		02/15/17 06:08	02/15/17 09:55	1

Client Sample ID: 1001

Date Collected: 02/07/17 06:10

Date Received: 02/09/17 10:30

Lab Sample ID: 550-77247-2

Matrix: Drinking Water

Method: 200.8 - Metals (ICP/MS)

Analyte	Result	Qualifier	RL	Unit	D	Prepared	Analyzed	Dil Fac
Lead	ND		0.50	ppb		02/15/17 06:08	02/15/17 09:57	1

QC Sample Results

Client: Arizona Dept of Environmental Quality
Project/Site: Pb in DW/Casa Grande S.D. 4

TestAmerica Job ID: 550-77247-1
SDG: Ironwood

Method: 200.8 - Metals (ICP/MS)

Lab Sample ID: MB 550-110135/1-A
Matrix: Water
Analysis Batch: 110167

Client Sample ID: Method Blank
Prep Type: Total/NA
Prep Batch: 110135

Analyte	MB Result	MB Qualifier	RL	Unit	D	Prepared	Analyzed	Dil Fac
Lead	ND		0.50	ppb		02/15/17 06:08	02/15/17 09:40	1

Lab Sample ID: LCS 550-110135/4-A
Matrix: Water
Analysis Batch: 110167

Client Sample ID: Lab Control Sample
Prep Type: Total/NA
Prep Batch: 110135

Analyte	Spike Added	LCS Result	LCS Qualifier	Unit	D	%Rec	%Rec. Limits
Lead	100	90.2		ppb		90	85 - 115

Lab Sample ID: LCSD 550-110135/5-A
Matrix: Water
Analysis Batch: 110167

Client Sample ID: Lab Control Sample Dup
Prep Type: Total/NA
Prep Batch: 110135

Analyte	Spike Added	LCSD Result	LCSD Qualifier	Unit	D	%Rec	%Rec. Limits	RPD	RPD Limit
Lead	100	90.8		ppb		91	85 - 115	1	20

Lab Sample ID: 550-77246-A-1-B MS
Matrix: Water
Analysis Batch: 110167

Client Sample ID: Matrix Spike
Prep Type: Total/NA
Prep Batch: 110135

Analyte	Sample Result	Sample Qualifier	Spike Added	MS Result	MS Qualifier	Unit	D	%Rec	%Rec. Limits
Lead	ND		100	86.2		ppb		86	70 - 130

Lab Sample ID: 550-77246-A-1-C MSD
Matrix: Water
Analysis Batch: 110167

Client Sample ID: Matrix Spike Duplicate
Prep Type: Total/NA
Prep Batch: 110135

Analyte	Sample Result	Sample Qualifier	Spike Added	MSD Result	MSD Qualifier	Unit	D	%Rec	%Rec. Limits	RPD	RPD Limit
Lead	ND		100	87.0		ppb		87	70 - 130	1	20

QC Association Summary

Client: Arizona Dept of Environmental Quality
Project/Site: Pb in DW/Casa Grande S.D. 4

TestAmerica Job ID: 550-77247-1
SDG: Ironwood

Metals

Prep Batch: 110135

Lab Sample ID	Client Sample ID	Prep Type	Matrix	Method	Prep Batch
550-77247-1	1001	Total/NA	Drinking Water	200.8	
550-77247-2	1001	Total/NA	Drinking Water	200.8	
MB 550-110135/1-A	Method Blank	Total/NA	Water	200.8	
LCS 550-110135/4-A	Lab Control Sample	Total/NA	Water	200.8	
LCSD 550-110135/5-A	Lab Control Sample Dup	Total/NA	Water	200.8	
550-77246-A-1-B MS	Matrix Spike	Total/NA	Water	200.8	
550-77246-A-1-C MSD	Matrix Spike Duplicate	Total/NA	Water	200.8	

Analysis Batch: 110167

Lab Sample ID	Client Sample ID	Prep Type	Matrix	Method	Prep Batch
550-77247-1	1001	Total/NA	Drinking Water	200.8	110135
550-77247-2	1001	Total/NA	Drinking Water	200.8	110135
MB 550-110135/1-A	Method Blank	Total/NA	Water	200.8	110135
LCS 550-110135/4-A	Lab Control Sample	Total/NA	Water	200.8	110135
LCSD 550-110135/5-A	Lab Control Sample Dup	Total/NA	Water	200.8	110135
550-77246-A-1-B MS	Matrix Spike	Total/NA	Water	200.8	110135
550-77246-A-1-C MSD	Matrix Spike Duplicate	Total/NA	Water	200.8	110135

Lab Chronicle

Client: Arizona Dept of Environmental Quality
Project/Site: Pb in DW/Casa Grande S.D. 4

TestAmerica Job ID: 550-77247-1
SDG: Ironwood

Client Sample ID: 1001

Date Collected: 02/06/17 06:03

Date Received: 02/09/17 10:30

Lab Sample ID: 550-77247-1

Matrix: Drinking Water

Prep Type	Batch Type	Batch Method	Run	Dilution Factor	Batch Number	Prepared or Analyzed	Analyst	Lab
Total/NA	Prep	200.8			110135	02/15/17 06:08	SGO	TAL PHX
Total/NA	Analysis	200.8		1	110167	02/15/17 09:55	TEK	TAL PHX

Client Sample ID: 1001

Date Collected: 02/07/17 06:10

Date Received: 02/09/17 10:30

Lab Sample ID: 550-77247-2

Matrix: Drinking Water

Prep Type	Batch Type	Batch Method	Run	Dilution Factor	Batch Number	Prepared or Analyzed	Analyst	Lab
Total/NA	Prep	200.8			110135	02/15/17 06:08	SGO	TAL PHX
Total/NA	Analysis	200.8		1	110167	02/15/17 09:57	TEK	TAL PHX

Laboratory References:

TAL PHX = TestAmerica Phoenix, 4625 East Cotton Ctr Blvd, Suite 189, Phoenix, AZ 85040, TEL (602)437-3340

Certification Summary

Client: Arizona Dept of Environmental Quality
Project/Site: Pb in DW/Casa Grande S.D. 4

TestAmerica Job ID: 550-77247-1
SDG: Ironwood

Laboratory: TestAmerica Phoenix

Unless otherwise noted, all analytes for this laboratory were covered under each certification below.

Authority	Program	EPA Region	Certification ID	Expiration Date
Arizona	State Program	9	AZ0728	06-09-17

Analysis Method	Prep Method	Matrix	Analyte
-----------------	-------------	--------	---------

Method Summary

Client: Arizona Dept of Environmental Quality
Project/Site: Pb in DW/Casa Grande S.D. 4

TestAmerica Job ID: 550-77247-1
SDG: Ironwood

Method	Method Description	Protocol	Laboratory
200.8	Metals (ICP/MS)	EPA	TAL PHX

Protocol References:

EPA = US Environmental Protection Agency

Laboratory References:

TAL PHX = TestAmerica Phoenix, 4625 East Cotton Ctr Blvd, Suite 189, Phoenix, AZ 85040, TEL (602)437-3340

77247

Collection Log
for experienced sample collectors

Complete copy of this form for each sample collected. Your drinking water sample cannot be tested unless a copy of this form is shipped to the lab with each sample. In addition, the sample cannot be tested unless the Sample Identification Number matches the number on the sample container label.

- ☒ Check this box to confirm that water had not been used at this tap or other taps in the area for 6 hours and no flushing was done prior to sampling

Name of School District	CASA Grande Ele Dist 4
School Name	Ironwood
Building (name/number)	Office hallway Cafeteria
Type of Fixture (tap, drinking fountain etc.)	drinking fountain
Location of Fixture (example, room number)	hallway office
Sample Identification Number (ensure this number is also on the sample container)	1001
Date of Collection	2-6-17
Time of Collection	6:03
Printed Name of Sample Collector	Ruby R. Trevino
Signature Sample Collector	Ruby R. Trevino

Notes Sample collector:

550-77247 Chain of Custody



For Lab use only	
Analyze this drinking water sample for lead	
Date and Time Lab received	
Signature	
Notes:	

For relinquishing samples upon delivery to labs only

Relinquished date and signature _____

These samples were collected for lead screening purposes only and cannot be used for compliance.

Al

2/9/17 10:30

F. B. Grand

21.00
+ 0.00

77247

Collection Log
for experienced sample collectors

Complete copy of this form for each sample collected. Your drinking water sample cannot be tested unless a copy of this form is shipped to the lab with each sample. In addition, the sample cannot be tested unless the Sample Identification Number matches the number on the sample container label.

- ☒ Check this box to confirm that water had not been used at this tap or other taps in the area for 6 hours and no flushing was done prior to sampling

Name of School District	Casa Grande Elementary Dist 4
School Name	Fronwood
Building (name/number)	West hallway
Type of Fixture (tap, drinking fountain etc.)	Drinking Fountain
Location of Fixture (example, room number)	West end hallway by main office
Sample Identification Number (ensure this number is also on the sample container)	1007
Date of Collection	2-9-17
Time of Collection	6:10 a.m.
Printed Name of Sample Collector	Ruby R. Trevino
Signature Sample Collector	Ruby R. Trevino

Notes Sample collector:

Time
6:00
on
Label

For Lab use only

Analyze this drinking water sample for lead	
Date and Time Lab received	
Signature	
Notes:	

For relinquishing samples upon delivery to labs only

Relinquished date and signature _____

These samples were collected for lead screening purposes only and cannot be used for compliance.

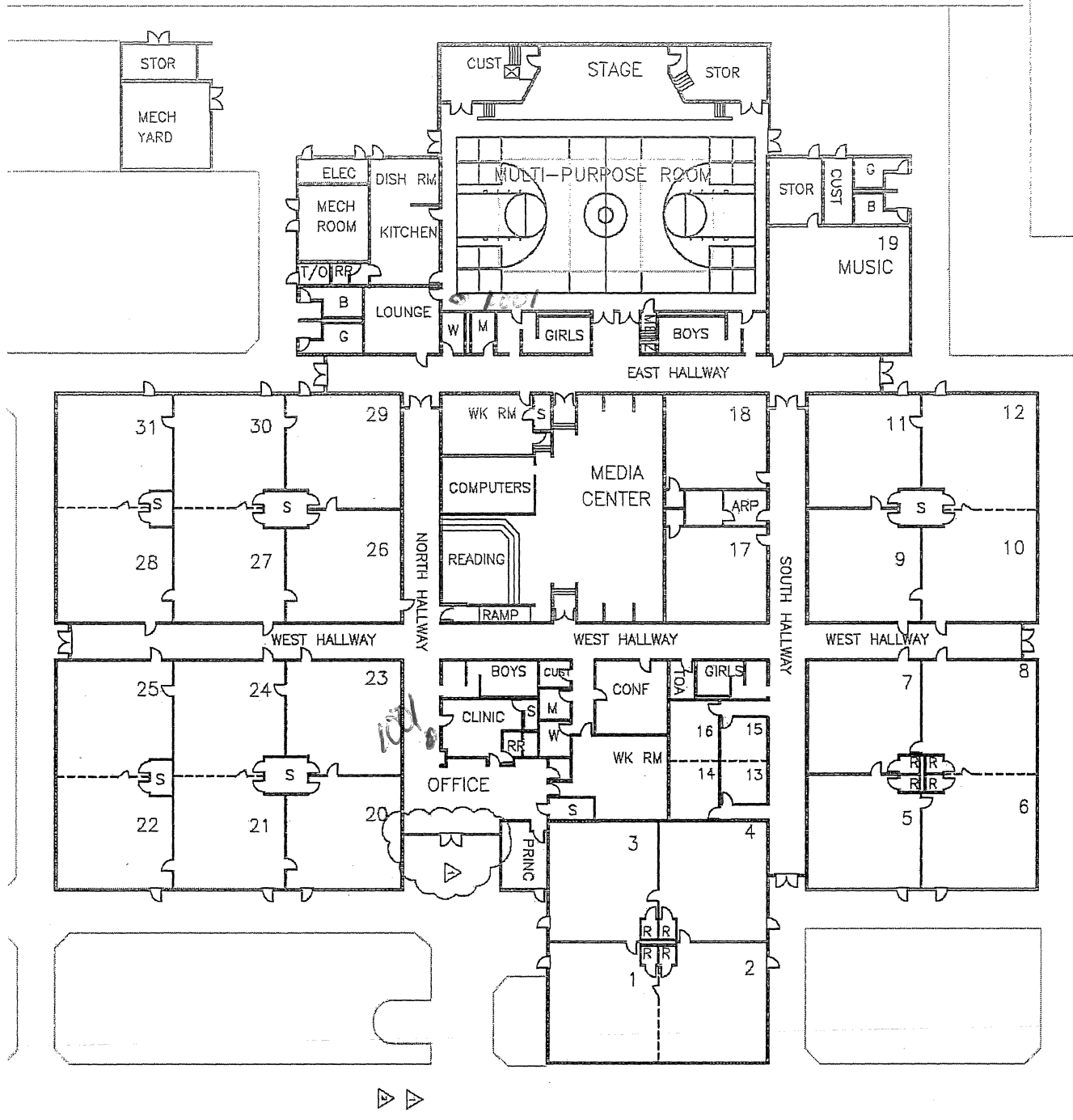

ASBESTOS HOT SPOTS
WINDOW PUTTY @ WEST ENTRANCE
FIRE DOORS @ ALL EXTERIOR DOORS

BROWNWOOD ELEMENTARY

Login Sample Receipt Checklist

Client: Arizona Dept of Environmental Quality

Job Number: 550-77247-1

SDG Number: Ironwood

Login Number: 77247

List Number: 1

Creator: Vilaboy, Monica

List Source: TestAmerica Phoenix

Question	Answer	Comment
Radioactivity wasn't checked or is \leq background as measured by a survey meter.	True	
The cooler's custody seal, if present, is intact.	True	
Sample custody seals, if present, are intact.	True	
The cooler or samples do not appear to have been compromised or tampered with.	True	
Samples were received on ice.	False	Thermal preservation not required.
Cooler Temperature is acceptable.	True	
Cooler Temperature is recorded.	True	
COC is present.	True	
COC is filled out in ink and legible.	True	
COC is filled out with all pertinent information.	True	
Is the Field Sampler's name present on COC?	True	
There are no discrepancies between the containers received and the COC.	False	Refer to Job Narrative for details.
Samples are received within Holding Time (excluding tests with immediate HTs)	True	
Sample containers have legible labels.	True	
Containers are not broken or leaking.	True	
Sample collection date/times are provided.	True	
Appropriate sample containers are used.	True	
Sample bottles are completely filled.	True	
Sample Preservation Verified.	True	
There is sufficient vol. for all requested analyses, incl. any requested MS/MSDs	True	
Containers requiring zero headspace have no headspace or bubble is $<6\text{mm}$ (1/4").	True	
Multiphasic samples are not present.	True	
Samples do not require splitting or compositing.	True	
Residual Chlorine Checked.	N/A	Check done at department level as required.