

David A. Burchard
Arizona Department of Environmental Quality, PHX
1110 W. Washington Street
Phoenix, AZ 85007

Project: School Lead Testing Screening
Project Number: Copper Creek Elementary School

Reported:
05/25/17 16:47

Analyte

1001 (7051674-01) Drinking Water (Grab) Sampled: 05/12/17 06:27 Received: 05/16/17 13:33

Analyte	Result	PQL	Units	Dilution	Batch	Prepared	Analyzed	Method	Notes
Legend Technical Services of Arizona, Inc.									

Total Metals

Lead	6.9	5.0	ug/L	1	B7E1688	05/22/17 10:10	05/23/17 01:12	EPA 200.8	
------	-----	-----	------	---	---------	----------------	----------------	-----------	--

1001-2 (7051674-02) Drinking Water (Grab) Sampled: 05/12/17 06:29 Received: 05/16/17 13:33

Analyte	Result	PQL	Units	Dilution	Batch	Prepared	Analyzed	Method	Notes
Legend Technical Services of Arizona, Inc.									

Total Metals

Lead	<5.0	5.0	ug/L	1	B7E1688	05/22/17 10:10	05/23/17 01:16	EPA 200.8	
------	------	-----	------	---	---------	----------------	----------------	-----------	--

1007-1 (7051674-03) Drinking Water (Grab) Sampled: 05/12/17 06:40 Received: 05/16/17 13:33

Analyte	Result	PQL	Units	Dilution	Batch	Prepared	Analyzed	Method	Notes
Legend Technical Services of Arizona, Inc.									

Total Metals

Lead	<5.0	5.0	ug/L	1	B7E1688	05/22/17 10:10	05/23/17 01:28	EPA 200.8	
------	------	-----	------	---	---------	----------------	----------------	-----------	--

1007-2 (7051674-04) Drinking Water (Grab) Sampled: 05/12/17 06:45 Received: 05/16/17 13:33

Analyte	Result	PQL	Units	Dilution	Batch	Prepared	Analyzed	Method	Notes
Legend Technical Services of Arizona, Inc.									

Total Metals

Lead	<5.0	5.0	ug/L	1	B7E1688	05/22/17 10:10	05/23/17 01:31	EPA 200.8	
------	------	-----	------	---	---------	----------------	----------------	-----------	--

1008 (7051674-05) Drinking Water (Grab) Sampled: 05/12/17 06:51 Received: 05/16/17 13:33

Analyte	Result	PQL	Units	Dilution	Batch	Prepared	Analyzed	Method	Notes
Legend Technical Services of Arizona, Inc.									

Total Metals

Lead	<5.0	5.0	ug/L	1	B7E1688	05/22/17 10:10	05/23/17 01:35	EPA 200.8	
------	------	-----	------	---	---------	----------------	----------------	-----------	--

1009-1 (7051674-06) Drinking Water (Grab) Sampled: 05/12/17 06:35 Received: 05/16/17 13:33

Analyte	Result	PQL	Units	Dilution	Batch	Prepared	Analyzed	Method	Notes
Legend Technical Services of Arizona, Inc.									

Total Metals

Lead	<5.0	5.0	ug/L	1	B7E1688	05/22/17 10:10	05/23/17 01:39	EPA 200.8	
------	------	-----	------	---	---------	----------------	----------------	-----------	--

1009-2 (7051674-07) Drinking Water (Grab) Sampled: 05/12/17 06:57 Received: 05/16/17 13:33

Analyte	Result	PQL	Units	Dilution	Batch	Prepared	Analyzed	Method	Notes
---------	--------	-----	-------	----------	-------	----------	----------	--------	-------

Legend Technical Services of Arizona, Inc.

Anna Teter

Client Services Representative

The results in this report apply to the samples analyzed in accordance with the chain of custody document. This analytical report must be reproduced in its entirety.

Phone Number: (602) 324-6100

Page 1 of 13

1009-2 (7051674-07) Drinking Water (Grab) Sampled: 05/12/17 06:57 Received: 05/16/17 13:33

Analyte	Result	PQL	Units	Dilution	Batch	Prepared	Analyzed	Method	Notes
Legend Technical Services of Arizona, Inc.									

Total Metals

Lead	<5.0	5.0	ug/L	1	B7E1688	05/22/17 10:10	05/23/17 01:43	EPA 200.8
------	------	-----	------	---	---------	----------------	----------------	-----------

1011-1 (7051674-08) Drinking Water (Grab) Sampled: 05/12/17 06:56 Received: 05/16/17 13:33

Analyte	Result	PQL	Units	Dilution	Batch	Prepared	Analyzed	Method	Notes
Legend Technical Services of Arizona, Inc.									

Total Metals

Lead	<5.0	5.0	ug/L	1	B7E1688	05/22/17 10:10	05/23/17 01:47	EPA 200.8
------	------	-----	------	---	---------	----------------	----------------	-----------

1011-2 (7051674-09) Drinking Water (Grab) Sampled: 05/12/17 06:58 Received: 05/16/17 13:33

Analyte	Result	PQL	Units	Dilution	Batch	Prepared	Analyzed	Method	Notes
Legend Technical Services of Arizona, Inc.									

Total Metals

Lead	<5.0	5.0	ug/L	1	B7E1688	05/22/17 10:10	05/23/17 01:50	EPA 200.8
------	------	-----	------	---	---------	----------------	----------------	-----------

Sample Condition Upon Receipt:

Temperature: 23.20 °C

All samples were received in acceptable condition unless noted otherwise in the case narrative.

Case Narrative:

Holding Times: All holding times were met unless otherwise qualified.

QA/QC Criteria: All analyses met method requirements unless otherwise qualified.

Accreditations: AZ(PHX)0004, AZ(TUC)0004, AIHA#102982, CDC ELITE Member.

Accreditation is applicable only to the test methods specified on each scope of accreditation held by LEGEND.

Comments: There were no problems encountered during the processing of the samples, unless otherwise noted.
All samples were analyzed on a "wet" basis unless designated as "dry weight".

Lead samples are preserved with Nitric acid upon receipt at the laboratory. However, some samples were analyzed prior to the 16 hour preservation waiting period due to urgency of analysis, per the client's request. Results are not for compliance purpose.

Notes and Definitions

ADEQ Public School Drinking Water Lead Screening Program
Sampling Plan & Collection Log

7051674 -01

Collection Log
for experienced sample collectors

Complete copy of this form for each sample collected. Your drinking water sample cannot be tested unless a copy of this form is shipped to the lab with each sample. In addition, the sample cannot be tested unless the Sample Identification Number matches the number on the sample container label.

☒ Check this box to confirm that **water had not been used at this tap or other taps in the area for 6 hours** and **no** flushing was done prior to sampling

Name of School District	Amphitheater Unified District
School Name	Copper Creek Elementary School
Building (name/number)	Admin.
Type of Fixture (tap, drinking fountain etc.)	SINK
Location of Fixture (example, room number)	NURSE OFFICE
Sample Identification Number (Write this number on the sample container and on this sheet)	1001-1
Date of Collection	5-12-17
Time of Collection	6:27 AM.
Printed Name of Sample Collector	KEN RAMIREZ
Signature Sample Collector	<i>Ken Ramirez</i>

Notes Sample collector:

For Lab use only	
Analyze this drinking water sample for lead	
Date and Time Lab received	5/16/17 1300
Signature	<i>[Signature]</i>
Notes: @Lab 5/16/17 1333	
23.2 °C	

For relinquishing samples upon delivery to labs only

Relinquished date and signature _____

These samples were collected for lead screening purposes only and cannot be used for compliance.

ADEQ Public School Drinking Water Lead Screening Program
Sampling Plan & Collection Log

7051674 -02

Collection Log
for experienced sample collectors

Complete copy of this form for each sample collected. Your drinking water sample cannot be tested unless a copy of this form is shipped to the lab with each sample. In addition, the sample cannot be tested unless the Sample Identification Number matches the number on the sample container label.

☒ Check this box to confirm that **water had not been used at this tap or other taps in the area for 6 hours** and **no** flushing was done prior to sampling

Name of School District	Amphitheater Unified District
School Name	Copper Creek Elementary School
Building (name/number)	ADMIN.
Type of Fixture (tap, drinking fountain etc.)	SINK
Location of Fixture (example, room number)	LOUNGE
Sample Identification Number (Write this number on the sample container and on this sheet)	1001-2
Date of Collection	5-12-17
Time of Collection	6:29 A.M.
Printed Name of Sample Collector	KEN RAMIREZ
Signature Sample Collector	Ken Ramirez

Notes Sample collector:

For Lab use only	
Analyze this drinking water sample for lead	
Date and Time Lab received	
Signature	
Notes:	

For relinquishing samples upon delivery to labs only

Relinquished date and signature _____

These samples were collected for lead screening purposes only and cannot be used for compliance.

ADEQ Public School Drinking Water Lead Screening Program
Sampling Plan & Collection Log

7051674 -03

Collection Log
for experienced sample collectors

Complete copy of this form for each sample collected. Your drinking water sample cannot be tested unless a copy of this form is shipped to the lab with each sample. In addition, the sample cannot be tested unless the Sample Identification Number matches the number on the sample container label.

☒ Check this box to confirm that **water had not been used at this tap or other taps in the area for 6 hours** and **no** flushing was done prior to sampling

Name of School District	Amphitheater Unified District
School Name	Copper Creek Elementary School
Building (name/number)	CLASSRMS, LIBRARY, ORIGINAL 1 st Floor
Type of Fixture (tap, drinking fountain etc.)	SINK
Location of Fixture (example, room number)	LIBRARY WORK RM.
Sample Identification Number (Write this number on the sample container and on this sheet)	1007-1
Date of Collection	5-12-17
Time of Collection	6:40 A.M.
Printed Name of Sample Collector	KEN RAMIREZ
Signature Sample Collector	Ken Ramirez

Notes Sample collector:

For Lab use only	
Analyze this drinking water sample for lead	
Date and Time Lab received	
Signature	
Notes:	

For relinquishing samples upon delivery to labs only

Relinquished date and signature

These samples were collected for lead screening purposes only and cannot be used for compliance.

ADEQ Public School Drinking Water Lead Screening Program
Sampling Plan & Collection Log

7051674 -04

Collection Log
for experienced sample collectors

Complete copy of this form for each sample collected. Your drinking water sample cannot be tested unless a copy of this form is shipped to the lab with each sample. In addition, the sample cannot be tested unless the Sample Identification Number matches the number on the sample container label.

☒ Check this box to confirm that **water had not been used at this tap or other taps in the area for 6 hours** and **no** flushing was done prior to sampling

Name of School District	Amphitheater Unified District
School Name	Copper Creek Elementary School
Building (name/number)	CLASSEM'S LIBRARY, ORIGINAL 1 ST FLOOR
Type of Fixture (tap, drinking fountain etc.)	DRINKING
Location of Fixture (example, room number)	HALLWAY
Sample Identification Number (Write this number on the sample container and on this sheet)	1007-2
Date of Collection	5-12-17
Time of Collection	6:45 A.M.
Printed Name of Sample Collector	KEN RAMIREZ
Signature Sample Collector	<i>Ken Ramirez</i>

Notes Sample collector:

For Lab use only	
Analyze this drinking water sample for lead	
Date and Time Lab received	
Signature	
Notes:	

For relinquishing samples upon delivery to labs only

Relinquished date and signature _____

These samples were collected for lead screening purposes only and cannot be used for compliance.

ADEQ Public School Drinking Water Lead Screening Program
Sampling Plan & Collection Log

Collection Log
for experienced sample collectors

Complete copy of this form for each sample collected. Your drinking water sample cannot be tested unless a copy of this form is shipped to the lab with each sample. In addition, the sample cannot be tested unless the Sample Identification Number matches the number on the sample container label.

☒ Check this box to confirm that **water had not been used at this tap or other taps in the area for 6 hours** and **no** flushing was done prior to sampling

Name of School District	Amphitheater Unified District
School Name	Copper Creek Elementary School
Building (name/number)	CLASSRMS, LIBRARY, ADD #1 - 1 ST FLOOR
Type of Fixture (tap, drinking fountain etc.)	DRINKING + SINK
Location of Fixture (example, room number)	Rm 19
Sample Identification Number (Write this number on the sample container and on this sheet)	1008
Date of Collection	5-12-17
Time of Collection	6:51 A.M.
Printed Name of Sample Collector	KEN RAMIREZ
Signature Sample Collector	<i>Ken Ramirez</i>

Notes Sample collector:

For Lab use only	
Analyze this drinking water sample for lead	
Date and Time Lab received	
Signature	
Notes:	

For relinquishing samples upon delivery to labs only

Relinquished date and signature _____

These samples were collected for lead screening purposes only and cannot be used for compliance.

ADEQ Public School Drinking Water Lead Screening Program
Sampling Plan & Collection Log

Collection Log
for experienced sample collectors

Complete copy of this form for each sample collected. Your drinking water sample cannot be tested unless a copy of this form is shipped to the lab with each sample. In addition, the sample cannot be tested unless the Sample Identification Number matches the number on the sample container label.

☒ Check this box to confirm that **water had not been used at this tap or other taps in the area for 6 hours** and **no** flushing was done prior to sampling

Name of School District	Amphitheater Unified District
School Name	Copper Creek Elementary School
Building (name/number)	M.P.R.
Type of Fixture (tap, drinking fountain etc.)	DRINKING
Location of Fixture (example, room number)	Lobby
Sample Identification Number (Write this number on the sample container and on this sheet)	1009-1
Date of Collection	5-12-17
Time of Collection	6:35 A.M.
Printed Name of Sample Collector	KEN RAMIREZ
Signature Sample Collector	<i>Ken Ramirez</i>

Notes Sample collector:

For Lab use only	
Analyze this drinking water sample for lead	
Date and Time Lab received	
Signature	
Notes:	

For relinquishing samples upon delivery to labs only

Relinquished date and signature _____

These samples were collected for lead screening purposes only and cannot be used for compliance.

ADEQ Public School Drinking Water Lead Screening Program
Sampling Plan & Collection Log

4051674-07

Collection Log
for experienced sample collectors

Complete copy of this form for each sample collected. Your drinking water sample cannot be tested unless a copy of this form is shipped to the lab with each sample. In addition, the sample cannot be tested unless the Sample Identification Number matches the number on the sample container label.

- ☒ Check this box to confirm that **water had not been used at this tap or other taps in the area for 6 hours** and **no** flushing was done prior to sampling

Name of School District	Amphitheater Unified District
School Name	Copper Creek Elementary School
Building (name/number)	MPR.
Type of Fixture (tap, drinking fountain etc.)	DRINKING
Location of Fixture (example, room number)	MPR N.W.
Sample Identification Number (Write this number on the sample container and on this sheet)	1009-2
Date of Collection	5-12-17
Time of Collection	6:57 A.M.
Printed Name of Sample Collector	KEN RAMIREZ
Signature Sample Collector	Ken Ramirez

Notes Sample collector:

For Lab use only	
Analyze this drinking water sample for lead	
Date and Time Lab received	
Signature	
Notes:	

For relinquishing samples upon delivery to labs only

Relinquished date and signature _____

These samples were collected for lead screening purposes only and cannot be used for compliance.

ADEQ Public School Drinking Water Lead Screening Program
Sampling Plan & Collection Log

4051674 -08

Collection Log
for experienced sample collectors

Complete copy of this form for each sample collected. Your drinking water sample cannot be tested unless a copy of this form is shipped to the lab with each sample. In addition, the sample cannot be tested unless the Sample Identification Number matches the number on the sample container label.

- ☒ Check this box to confirm that **water had not been used at this tap or other taps in the area for 6 hours** and **no** flushing was done prior to sampling

Name of School District	Amphitheater Unified District
School Name	Copper Creek Elementary School
Building (name/number)	CLASSRMS, LIBRARY ORIGINAL 2ND FLOOR
Type of Fixture (tap, drinking fountain etc.)	DRINKING
Location of Fixture (example, room number)	HALLWAY
Sample Identification Number (Write this number on the sample container and on this sheet)	1011-1
Date of Collection	5-12-17
Time of Collection	6:56 A.M.
Printed Name of Sample Collector	KEN KAMIREZ
Signature Sample Collector	Ken Kamirez

Notes Sample collector:

For Lab use only	
Analyze this drinking water sample for lead	
Date and Time Lab received	
Signature	
Notes:	

For relinquishing samples upon delivery to labs only

Relinquished date and signature _____

These samples were collected for lead screening purposes only and cannot be used for compliance.

ADEQ Public School Drinking Water Lead Screening Program
Sampling Plan & Collection Log

7051674 -09

Collection Log
for experienced sample collectors

Complete copy of this form for each sample collected. Your drinking water sample cannot be tested unless a copy of this form is shipped to the lab with each sample. In addition, the sample cannot be tested unless the Sample Identification Number matches the number on the sample container label.

☒ Check this box to confirm that **water had not been used at this tap or other taps in the area for 6 hours** and **no** flushing was done prior to sampling

Name of School District	Amphitheater Unified District
School Name	Copper Creek Elementary School
Building (name/number)	CLASSRMS, LIBRARY ORIGINAL 2 ND FLOOR
Type of Fixture (tap, drinking fountain etc.)	DRINKING
Location of Fixture (example, room number)	HALLWAY - EAST
Sample Identification Number (Write this number on the sample container and on this sheet)	1011-2
Date of Collection	5-12-17
Time of Collection	6:58 A.M.
Printed Name of Sample Collector	KEN RAMIREZ
Signature Sample Collector	Ken Ramirez

Notes Sample collector:

For Lab use only	
Analyze this drinking water sample for lead	
Date and Time Lab received	
Signature	
Notes:	

For relinquishing samples upon delivery to labs only

Relinquished date and signature _____

These samples were collected for lead screening purposes only and cannot be used for compliance.

7051674

	District	School	Building No	Building Desc	Building Use	Year Built	Number of Bottles Per Building
1	Amphitheater Unified District	Copper Creek Elementary School	1001 •	Administration	Administration	1987 1978	2
2	Amphitheater Unified District	Copper Creek Elementary School	1007 •	Classroom, Library - Original - First Floor	Classrooms, Library	1987	2
3	Amphitheater Unified District	Copper Creek Elementary School	1008 •	Classroom, Library - Addition #1 - First Floor	Classrooms	1994	1
4	Amphitheater Unified District	Copper Creek Elementary School	1009 •	MPR	MPR	1987	2
5	Amphitheater Unified District	Copper Creek Elementary School	1010	Storage Room	Storage	1987	2
6	Amphitheater Unified District	Copper Creek Elementary School	1011 •	Classroom, Library - Original - Second Floor	Classrooms	1987	2
7	Amphitheater Unified District	Copper Creek Elementary School	1012	Classroom, Library - Addition #1 - Second Floor	Classrooms	1994	1
8	Address:					Number of Bottles Per	12

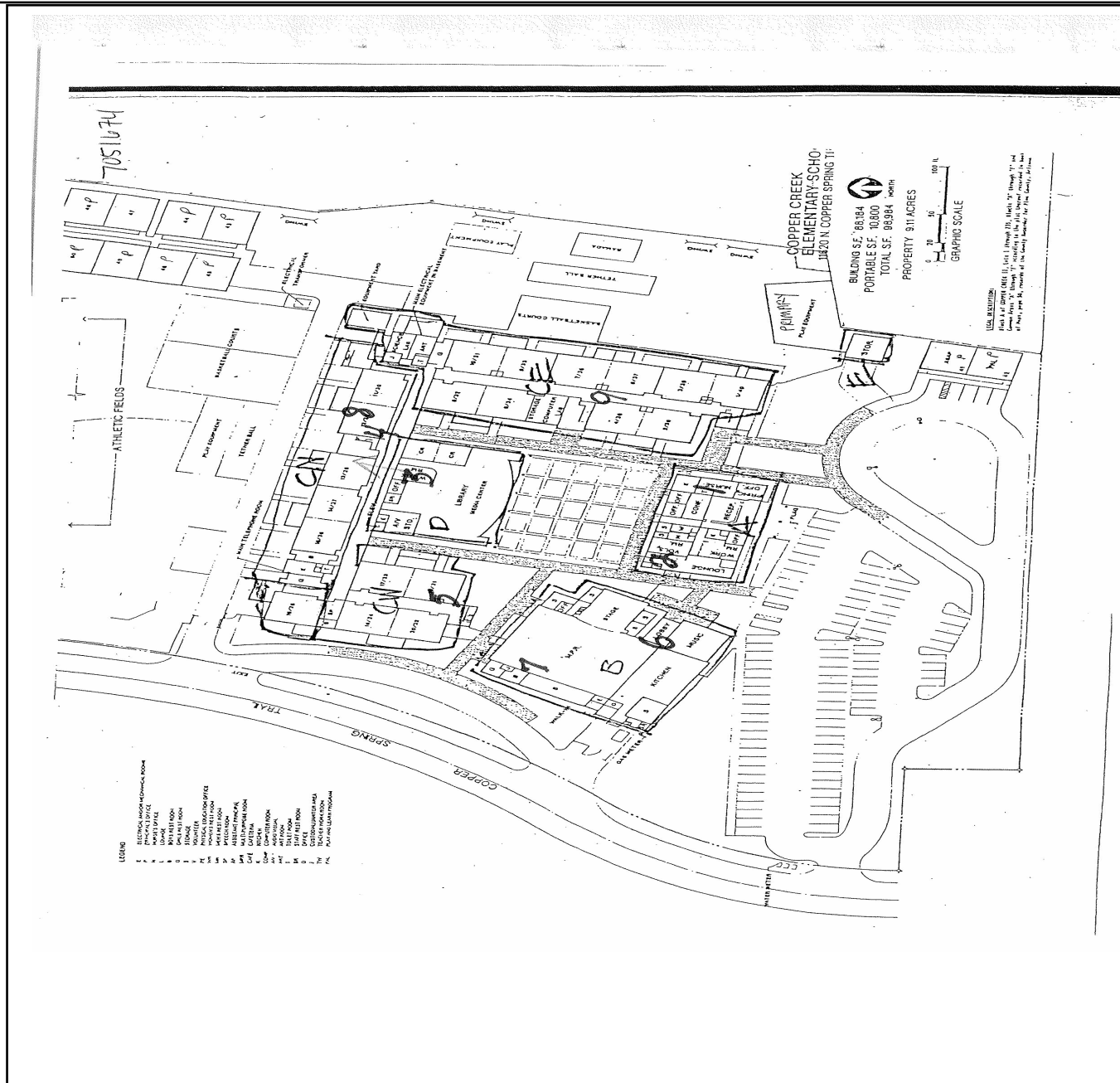

The results in this report apply to the samples analyzed in accordance with the chain of custody document. This analytical report must be reproduced in its entirety.