

David A. Burchard
Arizona Department of Environmental Quality,
1110 W. Washington Street
Phoenix, AZ85007

Project: School Lead Testing Screening
Project Number: Winifred Harelson Elementary School

Reported:
05/24/17 16:20

Analyte

1001-1 (7051285-01) Drinking Water (Grab) Sampled: 05/09/17 05:50 Received: 05/11/17 13:15

Analyte	Result	PQL	Units	Dilution	Batch	Prepared	Analyzed	Method	Notes
Legend Technical Services of Arizona, Inc.									

Total Metals

Lead	<5.0	5.0	ug/L	1	B7E1630	05/19/17 10:15	05/19/17 18:43	EPA 200.8
------	------	-----	------	---	---------	----------------	----------------	-----------

1001-2 (7051285-02) Drinking Water (Grab) Sampled: 05/09/17 05:52 Received: 05/11/17 13:15

Analyte	Result	PQL	Units	Dilution	Batch	Prepared	Analyzed	Method	Notes
Legend Technical Services of Arizona, Inc.									

Total Metals

Lead	<5.0	5.0	ug/L	1	B7E1630	05/19/17 10:15	05/19/17 18:47	EPA 200.8
------	------	-----	------	---	---------	----------------	----------------	-----------

1002-1 (7051285-03) Drinking Water (Grab) Sampled: 05/09/17 05:55 Received: 05/11/17 13:15

Analyte	Result	PQL	Units	Dilution	Batch	Prepared	Analyzed	Method	Notes
Legend Technical Services of Arizona, Inc.									

Total Metals

Lead	<5.0	5.0	ug/L	1	B7E1630	05/19/17 10:15	05/19/17 18:51	EPA 200.8
------	------	-----	------	---	---------	----------------	----------------	-----------

1002-2 (7051285-04) Drinking Water (Grab) Sampled: 05/09/17 05:58 Received: 05/11/17 13:15

Analyte	Result	PQL	Units	Dilution	Batch	Prepared	Analyzed	Method	Notes
Legend Technical Services of Arizona, Inc.									

Total Metals

Lead	<5.0	5.0	ug/L	1	B7E1630	05/19/17 10:15	05/19/17 18:55	EPA 200.8
------	------	-----	------	---	---------	----------------	----------------	-----------

1003-1 (7051285-05) Drinking Water (Grab) Sampled: 05/09/17 06:02 Received: 05/11/17 13:15

Analyte	Result	PQL	Units	Dilution	Batch	Prepared	Analyzed	Method	Notes
Legend Technical Services of Arizona, Inc.									

Total Metals

Lead	<5.0	5.0	ug/L	1	B7E1630	05/19/17 10:15	05/19/17 18:58	EPA 200.8
------	------	-----	------	---	---------	----------------	----------------	-----------

1003-2 (7051285-06) Drinking Water (Grab) Sampled: 05/09/17 06:05 Received: 05/11/17 13:15

Analyte	Result	PQL	Units	Dilution	Batch	Prepared	Analyzed	Method	Notes
Legend Technical Services of Arizona, Inc.									

Total Metals

Lead	<5.0	5.0	ug/L	1	B7E1630	05/19/17 10:15	05/19/17 19:02	EPA 200.8
------	------	-----	------	---	---------	----------------	----------------	-----------

1004-1 (7051285-07) Drinking Water (Grab) Sampled: 05/09/17 06:07 Received: 05/11/17 13:15

Analyte	Result	PQL	Units	Dilution	Batch	Prepared	Analyzed	Method	Notes
---------	--------	-----	-------	----------	-------	----------	----------	--------	-------

Legend Technical Services of Arizona, Inc.

Anna Teter

Client Services Representative

The results in this report apply to the samples analyzed in accordance with the chain of custody document. This analytical report must be reproduced in its entirety.

Phone Number: (602) 324-6100

David A. Burchard
Arizona Department of Environmental Quality,
1110 W. Washington Street
Phoenix, AZ85007

Project: School Lead Testing Screening
Project Number: Winifred Harelson Elementary School

Reported:
05/24/17 16:20

1004-1 (7051285-07) Drinking Water (Grab) Sampled: 05/09/17 06:07 Received: 05/11/17 13:15

Analyte	Result	PQL	Units	Dilution	Batch	Prepared	Analyzed	Method	Notes
Legend Technical Services of Arizona, Inc.									

Total Metals

Lead	<5.0	5.0	ug/L	1	B7E1630	05/19/17 10:15	05/19/17 19:06	EPA 200.8
------	------	-----	------	---	---------	----------------	----------------	-----------

1004-2 (7051285-08) Drinking Water (Grab) Sampled: 05/09/17 06:10 Received: 05/11/17 13:15

Analyte	Result	PQL	Units	Dilution	Batch	Prepared	Analyzed	Method	Notes
Legend Technical Services of Arizona, Inc.									

Total Metals

Lead	<5.0	5.0	ug/L	1	B7E1630	05/19/17 10:15	05/19/17 19:10	EPA 200.8
------	------	-----	------	---	---------	----------------	----------------	-----------

1011-1 (7051285-09) Drinking Water (Grab) Sampled: 05/09/17 06:17 Received: 05/11/17 13:15

Analyte	Result	PQL	Units	Dilution	Batch	Prepared	Analyzed	Method	Notes
Legend Technical Services of Arizona, Inc.									

Total Metals

Lead	<5.0	5.0	ug/L	1	B7E1632	05/19/17 11:11	05/19/17 19:40	EPA 200.8
------	------	-----	------	---	---------	----------------	----------------	-----------

1011-2 (7051285-10) Drinking Water (Grab) Sampled: 05/09/17 06:19 Received: 05/11/17 13:15

Analyte	Result	PQL	Units	Dilution	Batch	Prepared	Analyzed	Method	Notes
Legend Technical Services of Arizona, Inc.									

Total Metals

Lead	<5.0	5.0	ug/L	1	B7E1632	05/19/17 11:11	05/19/17 19:44	EPA 200.8
------	------	-----	------	---	---------	----------------	----------------	-----------

1012 (7051285-11) Drinking Water (Grab) Sampled: 05/09/17 06:30 Received: 05/11/17 13:15

Analyte	Result	PQL	Units	Dilution	Batch	Prepared	Analyzed	Method	Notes
Legend Technical Services of Arizona, Inc.									

Total Metals

Lead	<5.0	5.0	ug/L	1	B7E1632	05/19/17 11:11	05/19/17 19:48	EPA 200.8
------	------	-----	------	---	---------	----------------	----------------	-----------

1013 (7051285-12) Drinking Water (Grab) Sampled: 05/09/17 06:13 Received: 05/11/17 13:15

Analyte	Result	PQL	Units	Dilution	Batch	Prepared	Analyzed	Method	Notes
Legend Technical Services of Arizona, Inc.									

Total Metals

Lead	<5.0	5.0	ug/L	1	B7E1632	05/19/17 11:11	05/19/17 19:52	EPA 200.8
------	------	-----	------	---	---------	----------------	----------------	-----------

1014 (7051285-13) Drinking Water (Grab) Sampled: 05/09/17 06:21 Received: 05/11/17 13:15

Analyte	Result	PQL	Units	Dilution	Batch	Prepared	Analyzed	Method	Notes
Legend Technical Services of Arizona, Inc.									

Total Metals

Lead	<5.0	5.0	ug/L	1	B7E1632	05/19/17 11:11	05/19/17 19:56	EPA 200.8
------	------	-----	------	---	---------	----------------	----------------	-----------

The results in this report apply to the samples analyzed in accordance with the chain of custody document. This analytical report must be reproduced in its entirety.

Sample Condition Upon Receipt:

Temperature: 24.00 °C

All samples were received in acceptable condition unless noted otherwise in the case narrative.

Case Narrative:

Holding Times: All holding times were met unless otherwise qualified.

QA/QC Criteria: All analyses met method requirements unless otherwise qualified.

Accreditations: **AZ(PHX)0004, AZ(TUC)0004, AIHA#102982, CDC ELITE Member.**

Accreditation is applicable only to the test methods specified on each scope of accreditation held by LEGEND.

Comments: There were no problems encountered during the processing of the samples, unless otherwise noted.
All samples were analyzed on a "wet" basis unless designated as "dry weight".

Lead samples are preserved with Nitric acid upon receipt at the laboratory. However, some samples were analyzed prior to the 16 hour preservation waiting period due to urgency of analysis, per the client's request. Results are not for compliance purpose.

Notes and Definitions

ADEQ Public School Drinking Water Lead Screening Program
Sampling Plan & Collection Log

7051285-01

Collection Log
for experienced sample collectors

Complete copy of this form for each sample collected. Your drinking water sample cannot be tested unless a copy of this form is shipped to the lab with each sample. In addition, the sample cannot be tested unless the Sample Identification Number matches the number on the sample container label.

☒ Check this box to confirm that **water had not been used at this tap or other taps in the area for 6 hours** and **no** flushing was done prior to sampling

Name of School District	Amphitheater Unified District
School Name	Winifred Harelson Elementary School
Building (name/number)	ADMIN.
Type of Fixture (tap, drinking fountain etc.)	DRINKING
Location of Fixture (example, room number)	Admin. Hallway
Sample Identification Number (Write this number on the sample container and on this sheet)	1001-1
Date of Collection	5-9-17
Time of Collection	6:50 AM
Printed Name of Sample Collector	KEN RAMIREZ
Signature Sample Collector	Ken Ramirez

Notes Sample collector:

For Lab use only	
Analyze this drinking water sample for lead	
Date and Time Lab received	5/11/17 12:55
Signature	
Notes:	clab 13/5 24°C

For relinquishing samples upon delivery to labs only

Relinquished date and signature

These samples were collected for lead screening purposes only and cannot be used for compliance.

ADEQ Public School Drinking Water Lead Screening Program
Sampling Plan & Collection Log

7051285-02

Collection Log
for experienced sample collectors

Complete copy of this form for each sample collected. Your drinking water sample cannot be tested unless a copy of this form is shipped to the lab with each sample. In addition, the sample cannot be tested unless the Sample Identification Number matches the number on the sample container label.

- ☒ Check this box to confirm that **water had not been used at this tap or other taps in the area for 6 hours** and **no** flushing was done prior to sampling

Name of School District	Amphitheater Unified District
School Name	Winifred Harelson Elementary School
Building (name/number)	Admin.
Type of Fixture (tap, drinking fountain etc.)	SINK
Location of Fixture (example, room number)	TEACHERS LOUNGE
Sample Identification Number (Write this number on the sample container and on this sheet)	1001-2
Date of Collection	5-9-17
Time of Collection	5:52 A.M
Printed Name of Sample Collector	KEN RAMIREZ
Signature Sample Collector	Ken Ramirez

Notes Sample collector:

For Lab use only	
Analyze this drinking water sample for lead	
Date and Time Lab received	
Signature	
Notes:	

For relinquishing samples upon delivery to labs only

Relinquished date and signature _____

These samples were collected for lead screening purposes only and cannot be used for compliance.

ADEQ Public School Drinking Water Lead Screening Program
Sampling Plan & Collection Log

7051285-03

Collection Log
for experienced sample collectors

Complete copy of this form for each sample collected. Your drinking water sample cannot be tested unless a copy of this form is shipped to the lab with each sample. In addition, the sample cannot be tested unless the Sample Identification Number matches the number on the sample container label.

☒ Check this box to confirm that **water had not been used at this tap or other taps in the area for 6 hours** and **no** flushing was done prior to sampling

Name of School District	Amphitheater Unified District
School Name	Winifred Harelson Elementary School
Building (name/number)	1-6
Type of Fixture (tap, drinking fountain etc.)	DRINKING + SINK
Location of Fixture (example, room number)	Rm. 1
Sample Identification Number (Write this number on the sample container and on this sheet)	1002-1
Date of Collection	5-9-17
Time of Collection	5:55 A.M.
Printed Name of Sample Collector	KEN RAMIREZ
Signature Sample Collector	<i>Ken Ramirez</i>

Notes Sample collector:

For Lab use only	
Analyze this drinking water sample for lead	
Date and Time Lab received	
Signature	
Notes:	

For relinquishing samples upon delivery to labs only

Relinquished date and signature _____

These samples were collected for lead screening purposes only and cannot be used for compliance.

ADEQ Public School Drinking Water Lead Screening Program
Sampling Plan & Collection Log

7051285-04

Collection Log
for experienced sample collectors

Complete copy of this form for each sample collected. Your drinking water sample cannot be tested unless a copy of this form is shipped to the lab with each sample. In addition, the sample cannot be tested unless the Sample Identification Number matches the number on the sample container label.

☒ Check this box to confirm that **water had not been used at this tap or other taps in the area for 6 hours** and **no** flushing was done prior to sampling

Name of School District	Amphitheater Unified District
School Name	Winifred Harelson Elementary School
Building (name/number)	1-6
Type of Fixture (tap, drinking fountain etc.)	DRINKING + SINK
Location of Fixture (example, room number)	Rm 6
Sample Identification Number (Write this number on the sample container and on this sheet)	1002-2
Date of Collection	5-9-17
Time of Collection	5:58 A.M
Printed Name of Sample Collector	KEN RAMIREZ
Signature Sample Collector	Ken Ramirez

Notes Sample collector:

For Lab use only	
Analyze this drinking water sample for lead	
Date and Time Lab received	
Signature	
Notes:	

For relinquishing samples upon delivery to labs only

Relinquished date and signature _____

These samples were collected for lead screening purposes only and cannot be used for compliance.

ADEQ Public School Drinking Water Lead Screening Program
Sampling Plan & Collection Log

7051285-05

Collection Log
for experienced sample collectors

Complete copy of this form for each sample collected. Your drinking water sample cannot be tested unless a copy of this form is shipped to the lab with each sample. In addition, the sample cannot be tested unless the Sample Identification Number matches the number on the sample container label.

☒ Check this box to confirm that **water had not been used at this tap or other taps in the area for 6 hours** and **no** flushing was done prior to sampling

Name of School District	Amphitheater Unified District
School Name	Winifred Harelson Elementary School
Building (name/number)	7-12
Type of Fixture (tap, drinking fountain etc.)	DRINKING & SINK
Location of Fixture (example, room number)	Rm 7
Sample Identification Number (Write this number on the sample container and on this sheet)	1003-1
Date of Collection	5-9-17
Time of Collection	6:02 A.M
Printed Name of Sample Collector	KEN RAMIREZ
Signature Sample Collector	<i>Ken Ramirez</i>

Notes Sample collector:

For Lab use only	
Analyze this drinking water sample for lead	
Date and Time Lab received	
Signature	
Notes:	

For relinquishing samples upon delivery to labs only

Relinquished date and signature _____

These samples were collected for lead screening purposes only and cannot be used for compliance.

ADEQ Public School Drinking Water Lead Screening Program
Sampling Plan & Collection Log

7051285-06

Collection Log
for experienced sample collectors

Complete copy of this form for each sample collected. Your drinking water sample cannot be tested unless a copy of this form is shipped to the lab with each sample. In addition, the sample cannot be tested unless the Sample Identification Number matches the number on the sample container label.

☒ Check this box to confirm that **water had not been used at this tap or other taps in the area for 6 hours** and **no** flushing was done prior to sampling

Name of School District	Amphitheater Unified District
School Name	Winifred Harelson Elementary School
Building (name/number)	7-12
Type of Fixture (tap, drinking fountain etc.)	DRINKING + SINK
Location of Fixture (example, room number)	Rm 12
Sample Identification Number (Write this number on the sample container and on this sheet)	1003-2
Date of Collection	5-9-17
Time of Collection	6:05 AM.
Printed Name of Sample Collector	Ken Ramirez
Signature Sample Collector	Ken Ramirez

Notes Sample collector:

For Lab use only	
Analyze this drinking water sample for lead	
Date and Time Lab received	
Signature	
Notes:	

For relinquishing samples upon delivery to labs only

Relinquished date and signature _____

These samples were collected for lead screening purposes only and cannot be used for compliance.

ADEQ Public School Drinking Water Lead Screening Program
Sampling Plan & Collection Log

7051285-07

Collection Log
for experienced sample collectors

Complete copy of this form for each sample collected. Your drinking water sample cannot be tested unless a copy of this form is shipped to the lab with each sample. In addition, the sample cannot be tested unless the Sample Identification Number matches the number on the sample container label.

☒ Check this box to confirm that **water had not been used at this tap or other taps in the area for 6 hours** and **no** flushing was done prior to sampling

Name of School District	Amphitheater Unified District
School Name	Winifred Harelson Elementary School
Building (name/number)	13-18
Type of Fixture (tap, drinking fountain etc.)	DRINKING & SINK
Location of Fixture (example, room number)	Rm 13
Sample Identification Number (Write this number on the sample container and on this sheet)	1004-1
Date of Collection	5-9-17
Time of Collection	6:07 A.M.
Printed Name of Sample Collector	KEN RAMIREZ
Signature Sample Collector	Ken Ramirez

Notes Sample collector:

For Lab use only	
Analyze this drinking water sample for lead	
Date and Time Lab received	
Signature	
Notes:	

For relinquishing samples upon delivery to labs only

Relinquished date and signature _____

These samples were collected for lead screening purposes only and cannot be used for compliance.

ADEQ Public School Drinking Water Lead Screening Program
Sampling Plan & Collection Log

7051285-08

Collection Log
for experienced sample collectors

Complete copy of this form for each sample collected. Your drinking water sample cannot be tested unless a copy of this form is shipped to the lab with each sample. In addition, the sample cannot be tested unless the Sample Identification Number matches the number on the sample container label.

☒ Check this box to confirm that **water had not been used at this tap or other taps in the area for 6 hours** and **no** flushing was done prior to sampling

Name of School District	Amphitheater Unified District
School Name	Winifred Harelson Elementary School
Building (name/number)	13-18
Type of Fixture (tap, drinking fountain etc.)	DRINKING & SINK
Location of Fixture (example, room number)	Rm. 18
Sample Identification Number (Write this number on the sample container and on this sheet)	1004-2
Date of Collection	5-9-17
Time of Collection	6:10 A.M.
Printed Name of Sample Collector	KEN RAMIREZ
Signature Sample Collector	<i>Ken Ramirez</i>

Notes Sample collector:

For Lab use only	
Analyze this drinking water sample for lead	
Date and Time Lab received	
Signature	
Notes:	

For relinquishing samples upon delivery to labs only

Relinquished date and signature _____

These samples were collected for lead screening purposes only and cannot be used for compliance.

ADEQ Public School Drinking Water Lead Screening Program
Sampling Plan & Collection Log

7051285-09

Collection Log
for experienced sample collectors

Complete copy of this form for each sample collected. Your drinking water sample cannot be tested unless a copy of this form is shipped to the lab with each sample. In addition, the sample cannot be tested unless the Sample Identification Number matches the number on the sample container label.

☒ Check this box to confirm that **water had not been used at this tap or other taps in the area for 6 hours** and **no** flushing was done prior to sampling

Name of School District	Amphitheater Unified District
School Name	Winifred Harelson Elementary School
Building (name/number)	POD 20-23
Type of Fixture (tap, drinking fountain etc.)	DRINKING & SINK
Location of Fixture (example, room number)	Rm. 20
Sample Identification Number (Write this number on the sample container and on this sheet)	1011-1
Date of Collection	5-9-17
Time of Collection	6:17 A.M.
Printed Name of Sample Collector	KEN RAMIREZ
Signature Sample Collector	<i>Ken Ramirez</i>

Notes Sample collector:

For Lab use only	
Analyze this drinking water sample for lead	
Date and Time Lab received	
Signature	
Notes:	

For relinquishing samples upon delivery to labs only

Relinquished date and signature _____

These samples were collected for lead screening purposes only and cannot be used for compliance.

ADEQ Public School Drinking Water Lead Screening Program
Sampling Plan & Collection Log

7051285-10

Collection Log
for experienced sample collectors

Complete copy of this form for each sample collected. Your drinking water sample cannot be tested unless a copy of this form is shipped to the lab with each sample. In addition, the sample cannot be tested unless the Sample Identification Number matches the number on the sample container label.

☒ Check this box to confirm that **water had not been used at this tap or other taps in the area for 6 hours** and **no** flushing was done prior to sampling

Name of School District	Amphitheater Unified District
School Name	Winifred Harelson Elementary School
Building (name/number)	POD 20-23
Type of Fixture (tap, drinking fountain etc.)	DRINKING & SINK
Location of Fixture (example, room number)	Rm 23
Sample Identification Number (Write this number on the sample container and on this sheet)	1011-2
Date of Collection	5-9-17
Time of Collection	6:19 A.M
Printed Name of Sample Collector	KEN RAMIREZ
Signature Sample Collector	Ken Ramirez

Notes Sample collector:

For Lab use only	
Analyze this drinking water sample for lead	
Date and Time Lab received	
Signature	
Notes:	

For relinquishing samples upon delivery to labs only

Relinquished date and signature _____

These samples were collected for lead screening purposes only and cannot be used for compliance.

ADEQ Public School Drinking Water Lead Screening Program
Sampling Plan & Collection Log

705 1285-11

Collection Log
for experienced sample collectors

Complete copy of this form for each sample collected. Your drinking water sample cannot be tested unless a copy of this form is shipped to the lab with each sample. In addition, the sample cannot be tested unless the Sample Identification Number matches the number on the sample container label.

- ☒ Check this box to confirm that **water had not been used at this tap or other taps in the area for 6 hours** and **no** flushing was done prior to sampling

Name of School District	Amphitheater Unified District
School Name	Winifred Harelson Elementary School
Building (name/number)	Activity Room
Type of Fixture (tap, drinking fountain etc.)	DRINKING
Location of Fixture (example, room number)	MPR - FGN House
Sample Identification Number (Write this number on the sample container and on this sheet)	1012
Date of Collection	5-9-17
Time of Collection	6:30
Printed Name of Sample Collector	KEN RAMIREZ
Signature Sample Collector	Ken Ramirez

Notes Sample collector:

For Lab use only	
Analyze this drinking water sample for lead	
Date and Time Lab received	
Signature	
Notes:	

For relinquishing samples upon delivery to labs only

Relinquished date and signature _____

These samples were collected for lead screening purposes only and cannot be used for compliance.

ADEQ Public School Drinking Water Lead Screening Program
Sampling Plan & Collection Log

7051285-12

Collection Log
for experienced sample collectors

Complete copy of this form for each sample collected. Your drinking water sample cannot be tested unless a copy of this form is shipped to the lab with each sample. In addition, the sample cannot be tested unless the Sample Identification Number matches the number on the sample container label.

☒ Check this box to confirm that **water had not been used at this tap or other taps in the area for 6 hours** and **no** flushing was done prior to sampling

Name of School District	Amphitheater Unified District
School Name	Winifred Harelson Elementary School
Building (name/number)	4 - Additional CLASSRMS
Type of Fixture (tap, drinking fountain etc.)	DRINKING + SINK
Location of Fixture (example, room number)	Rm 104
Sample Identification Number (Write this number on the sample container and on this sheet)	1013
Date of Collection	5-9-17
Time of Collection	6:13 A.M
Printed Name of Sample Collector	KEN RAMIREZ
Signature Sample Collector	Ken Ramirez

Notes Sample collector:

For Lab use only	
Analyze this drinking water sample for lead	
Date and Time Lab received	
Signature	
Notes:	

For relinquishing samples upon delivery to labs only

Relinquished date and signature _____

These samples were collected for lead screening purposes only and cannot be used for compliance.

ADEQ Public School Drinking Water Lead Screening Program
Sampling Plan & Collection Log

7051285-13

Collection Log
for experienced sample collectors

Complete copy of this form for each sample collected. Your drinking water sample cannot be tested unless a copy of this form is shipped to the lab with each sample. In addition, the sample cannot be tested unless the Sample Identification Number matches the number on the sample container label.

☒ Check this box to confirm that **water had not been used at this tap or other taps in the area for 6 hours** and **no** flushing was done prior to sampling

Name of School District	Amphitheater Unified District
School Name	Winifred Harelson Elementary School
Building (name/number)	CLASSROOM Addition
Type of Fixture (tap, drinking fountain etc.)	DRINKING & SINK
Location of Fixture (example, room number)	Rm 25
Sample Identification Number (Write this number on the sample container and on this sheet)	1014
Date of Collection	5-9-17
Time of Collection	6:21 A.M.
Printed Name of Sample Collector	KEN RAMIREZ
Signature Sample Collector	Ken Ramirez

Notes Sample collector:

For Lab use only	
Analyze this drinking water sample for lead	
Date and Time Lab received	
Signature	
Notes:	

For relinquishing samples upon delivery to labs only

Relinquished date and signature _____

These samples were collected for lead screening purposes only and cannot be used for compliance.

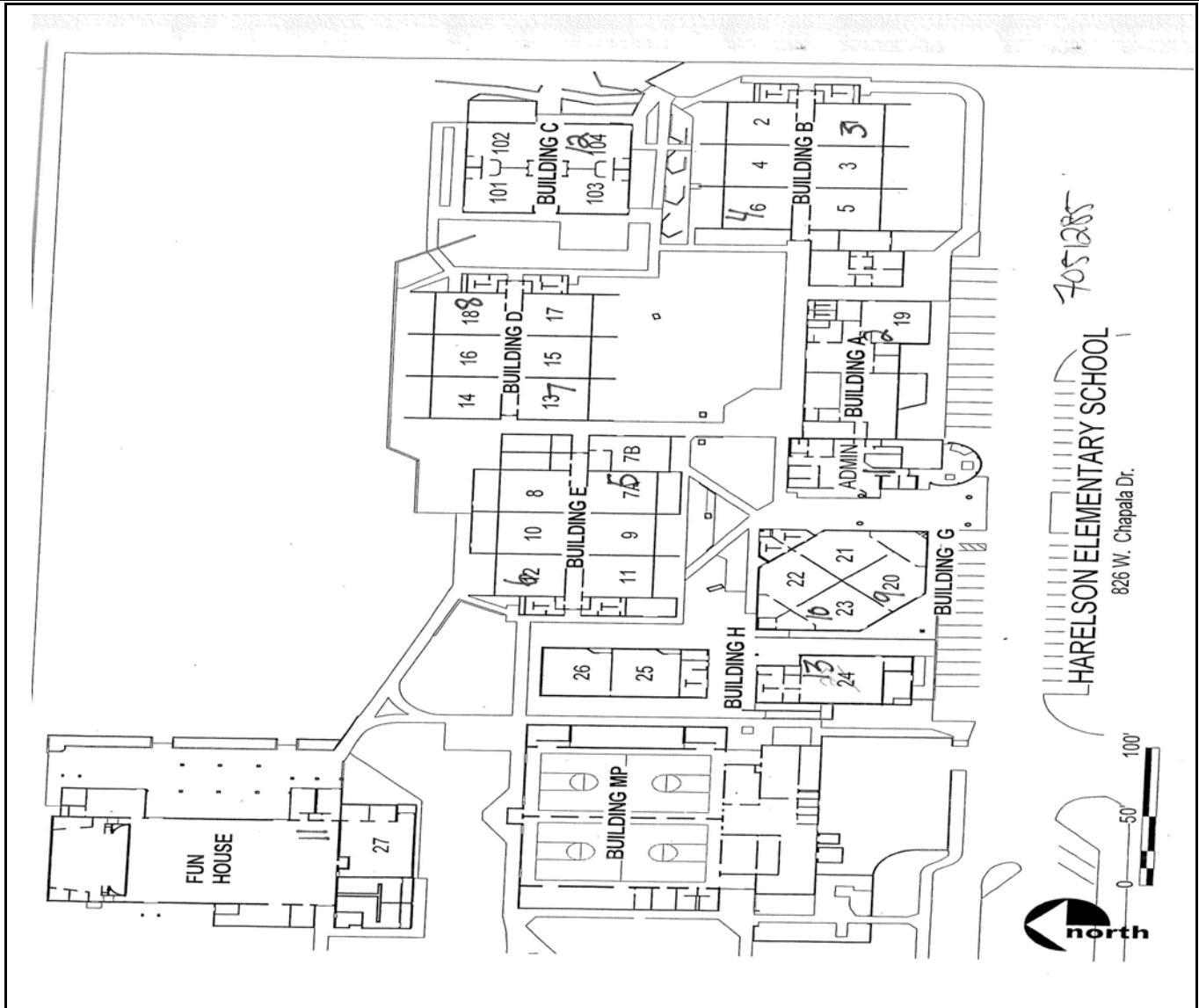

District	School	Building No	Building Desc	Building Use	Year Built	Number of Bottles Per Building
Amphitheater Unified District	Winifred Harelson Elementary School	1001 •	Administration	Administration	1960	2
Amphitheater Unified District	Winifred Harelson Elementary School	1002 •	1-6	Classrooms	1960	2
Amphitheater Unified District	Winifred Harelson Elementary School	1003 •	7-12	Classrooms	1962	2
Amphitheater Unified District	Winifred Harelson Elementary School	1004 •	13-18	Classrooms	1960	2
Amphitheater Unified District	Winifred Harelson Elementary School	1011 •	POD (20-23)	Classrooms	1975	2
Amphitheater Unified District	Winifred Harelson Elementary School	1012 •	Activity Room	MPR	1990	1
Amphitheater Unified District	Winifred Harelson Elementary School	1013 •	4 Additional Classrooms	Classrooms	2004	1
Amphitheater Unified District	Winifred Harelson Elementary School	1014 •	Classroom addition	Classrooms	2015	1
Address:					Number of Bottles Per	13

7051285